



SERVICE MANUAL & SPARE PARTS LIST

ECO 1 & ECO2
H500



ECO1NL & ECO2NL
GLASSWASHERS
H500NL DISHWASHER



E1 & E2 GLASSWASHERS
H5 DISHWASHER

CLASSIC HOUSE, AIRFIELD INDUSTRIAL ESTATE, HIXON, STAFFORDSHIRE ST18



DECEMBER 2003 WO

BLANK

CLASSIC GLASS & DISHWASHING SYSTEMS LTD



ECO 1 & 2 Stainless Steel Top Machines

ECO 1 & 2 & H500 NEW LINE

E1 & E2 & H5 (24 VOLT MACHINES)

TABLE OF CONTENTS

Table of Contents	Page 1
Cabinet & Cover Parts Drawings	Page 2
Cabinet & Cover Parts Parts Lists	Page 3
Rinse System Drawings	Page 4
Rinse System Parts List	Page 5
Wash & Jet System Drawing	Page 6
Wash & Jet System Parts List	Page 7
Water & Waste System Drawing	Page 8
Water & Waste System Parts List	Page 9
Filter System Drawing	Page 10
Filter System Parts List	Page 11
Electrical Parts Drawing	Page 12
Electrical Parts List	Page 13
White Wash Pumps ECO1NL /E1	Page 13A
White Wash Pumps ECO2NL / E2	Page 13B

STAINLESS STEEL TOP MACHINES

Schematic Drawing - Stainless Steel Top Page 14

Component Wiring Stainless Steel Top Page 15

ECO1NL - ECO2NL - H500NL

Component Wiring New Line Machines Page 16

Schematic Drawing - New Line Machines Page 17

Schematic Drawing - heat interlock 1 Page 18

Schematic Drawing - heat interlock 2 Page 19

E1 & E2 GLASSWASHERS H5 DISHWASHER

24 VOLT MACHINES - APRIL 2002

PARTS LIST - E1 & E2 24 VOLT PARTS ONLY

E1 & E2 COMPONENT WIRING

E1 & E2 WIRING DIAGRAM

H5 COMPONENT WIRING

H5 WIRING DIAGRAM

PARTS LIST - H500 24 VOLT PARTS ONLY

TRAINING AID FOR INTERLOCK

FITTING INTERNAL RINSE BOOSTER PUMP

24 VOLT MACHINES ONLY

ECO1/2 & H500 CABINET & COVERS

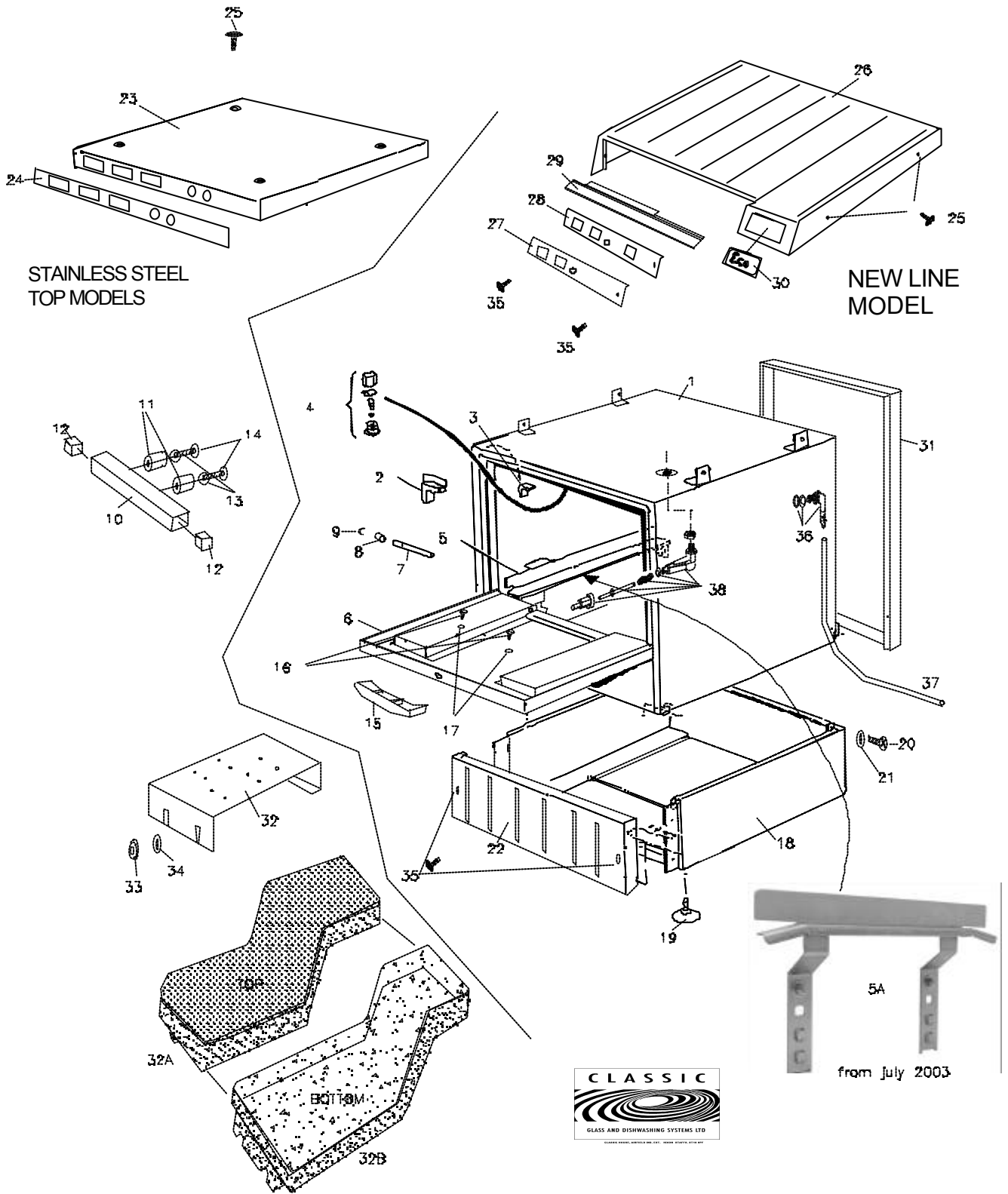



CABINET & COVERS

		ECO1	ECO2	H500
1	CABINET NEW LINE ONLY	11.2.4	12.2.4	12.2.4
	CABINET FOR S/STEEL TOP	N/A	N/A	N/A
2	PLASTIC CORNER - OUTER	7.2.15	7.2.15	7.2.15
3	RUBBER CORNER - INNER	7.2.14	7.2.14	7.2.14
4	BALL CATCH ASSEMBLY	7.2.10	7.2.10	7.2.10
5	BASKET RUNNER - LEFT HAND	7.2.21/L	8.2.21/L	8.2.2/L
	BASKET RUNNER - RIGHT HAND	7.2.21/R	8.2.21/R	8.2.2/R
5A	Basket Runner - 2003 (left & Right Hand)	7.2.21/4	8.2.21/4	8.2.21/4
6	DOOR	7.2.5E	12.2.5/A	12.2.5/A
7	DOOR PIN	7.2.16/1	8.2.16/1	8.2.16/1
8	SPACER FOR DOOR PIN	7.2.35/2	7.2.35/2	7.2.35/2
9	C' CLIP	7.2.35/1	7.2.35/1	7.2.35/1
NOT SHOWN	DOOR PIN BUSH	7.2.35/3	7.2.35/3	7.2.35/3
10	HANDLE - METAL	7.6.6.1	7.6.6.1	7.6.6.1
11	SPACER FOR OLD HANDLE	7.2.36.5	7.2.36.5	7.2.36.5
12	CAP FOR METAL DOOR HANDLE	7.2.6.3	7.2.6.3	7.2.6.3
13	SEAL	7.2.36.4	7.2.36.4	7.2.36.4
14	SCREW	7.2.36.3	7.2.36.3	7.2.36.3
15	HANDLE - PLASTIC - BLUE	7.6.6.3	7.6.6.3	7.6.6.3
15	HANDLE - PLASTIC - BLACK	7.6.6.2	7.6.6.2	7.6.6.2
16	SCREW	7.2.36/4	7.2.36/4	7.2.36/4
17	SEAL	7.2.36.4	7.2.36.4	7.2.36.4
18	BASE	7.2.7E	8.2.7E	8.2.7E
19	FOOT	7.2.37/1	7.2.37/1	7.2.37/1
20	WASHER	7.2.41	7.2.41	7.2.41
21	CABINET SCREW	7.2.36	7.2.36	7.2.36
22	LOWER FRONT PANEL - BLUE PLASTIC	7.2.8P	8.2.8P	8.2.8P
22	LOWER FRONT PANEL - BLACK PLASTIC	7.2.8P-UL	8.2.8P-UL	8.2.8PX
23	TOP PANEL - STAINLESS STEEL	7.2.1E	8.2.1E	N/A
24	FASCIA FOR S/STEEL TOP	FASC/E1	FASC/E2	N/A
25	PANEL SCREW 10 mm	7.2.40/1	7.2.40/1	7.2.40/1
26	TOP PANEL - BLUE PLASTIC	7.2.1P	8.2.1P	8.2.1P
26	TOP PANEL - BLACK PLASTIC	7.2.1P-UL	8.2.1P-UL	8.2.1P-UL
27	PANEL FOR SWITCHES - GRAVITY DRAIN	7.2.2S	8.2.2S	N/A
28	PANEL FOR SWITCHES - PUMP DRAIN	7.2.2SD	8.2.2SD	8.2.2SD
29	INSERT FOR SWITCH PANEL - BLUE	7.2.2PI	8.2.2PI	8.2.2PI
29	INSERT FOR SWITCH PANEL - BLACK	7.2.2PI-UL	8.2.2PI-UL	8.2.2PI-UL
30	BADGE FOR PLASTIC TOP	LABEL-E1	LABEL-E2	LABEL-H5
31	BACK PANEL - BLUE	7.2.3S	8.2.3S	8.2.3S
31	BACK PANEL - BLACK	7.2.3S-X	8.2.3S-X	8.2.3S-X
32	ELECTRIC TRAY - S/STELL MODEL	OBSOLETE	OBSOLETE	N/A
32A	ELECTRIC TRAY BLACK PLASTIC TOP	7.2.19/F	7.2.19/F	
32B	ELECTRIC TRAY BLACK PLASTIC BOTTOM	7.2.19/E	7.2.19/E	
0	NUT	11.2.3	11.2.3	11.2.3
34	WASHER	W003	W003	W003
35	PANEL SCREW 15 mm	7.2.40/3	7.2.40/3	7.2.40/3
36	SOAP ELBOW ASSEMBLY	7.2.21/ASS	7.2.21/ASS	7.2.21/ASS
37	SOAP TUBE	RT2	RT2	RT2
38	DOOR PLUNGER ASSEMBLY	7.14.1	7.14.1	7.14.1

CLASSIC GLASS & DISHWASHING SYSTEMS LTD

ECO1/2 & H500 RINSE SYSTEM

**RINSE AID INJECTOR FITTING KIT
MODIFICATION**
See MOD KIT to convert Brass Nut Type
with Hard Plastic Tube to Silicon Tube and
Clip connections.
Part No 7.7.0/23A

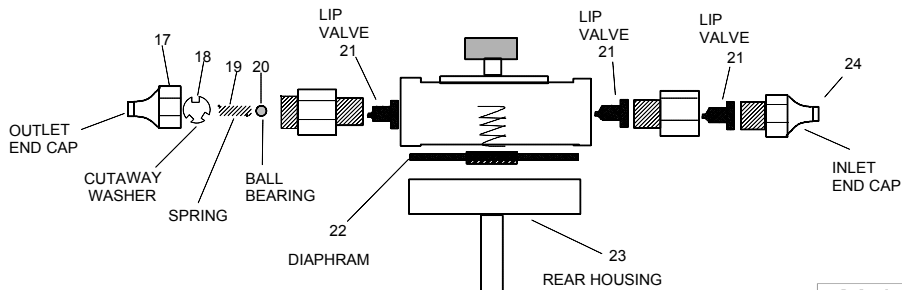
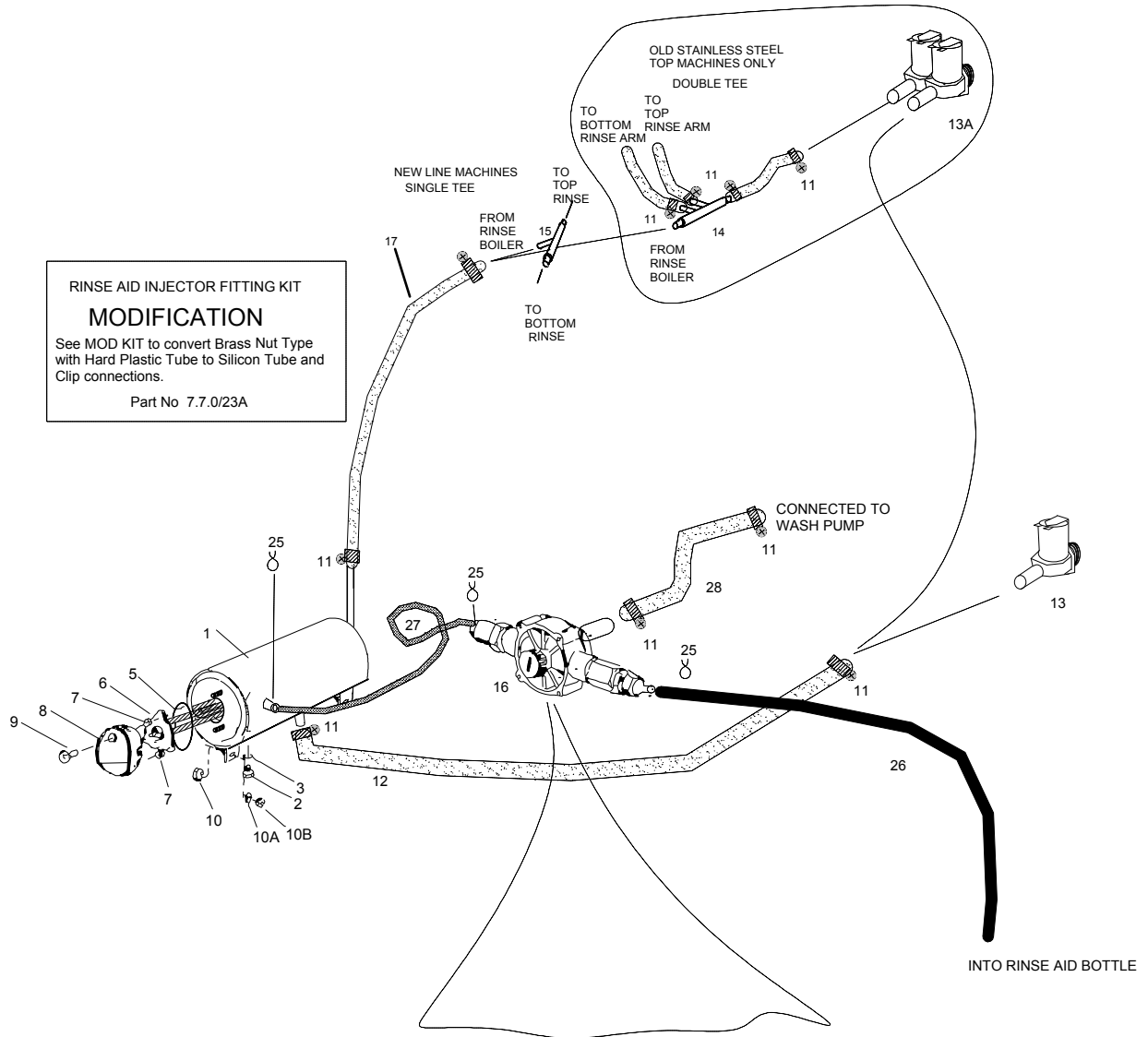

RINSE AID INJECTOR - REMOTE TYPE



CLASSIC GLASS & DISHWASHING SYSTEMS LTD

RINSE SYSTEM



		ECO1	ECO2	H500
1	RINSE BOILER	7.9.1E	8.9.1E	8.9.1E
2	DRAIN BOLT	7.9.5	7.9.5	7.9.5
3	WASHER	7.9.6	7.9.6	7.9.6
5	SEAL FOR ELEMENT	7.9.12	7.9.12	7.9.12
6	ELEMENT FOR BOILER	9.9.14	9.9.14	9.9.14
7	NUT FOR ELEMENT	7.9.13	7.9.13	7.9.13
8	COVER FOR ELEMENT	7.9.15	7.9.15	7.9.15
9	NUT FOR COVER	7.9.16	7.9.16	7.9.16
10	NUT	11.2.3	11.2.3	11.2.3
10A	WASHER	7.2.42	7.2.42	7.2.42
10B	BOLT	7.9.13/4	7.9.13/4	7.9.13/4
11	HOSE CLIP	7.4.12/1	7.4.12/1	7.4.12/1
12	HOSE - special Water Valve to Rinse Tank	8.8.20	8.8.20	8.8.20
13	SINGLE SOLENOID WATER VALVE	7.12.12/1	7.12.12/1	7.12.12/1
13A	DOUBLE SOLENOID WATER VALVE	7.12.12	7.12.12	
14	DOUBLE PLASTIC TEE(S/STEEL ONLY)	7.15.2/2	7.15.2/2	
15	PLASTIC TEE	7.15.2	7.15.2	7.15.2
16	REMOTE RINSE AID INJECTOR	7.7.0.1/1	7.7.0.1/1	7.7.0.1/1
17	RINSE HOSE per Mtr	8.8.15	8.8.15	8.8.15
25	CLIP	7.7.0/22	7.7.0/22	7.7.0/22
26	TUBE FOR RINSE AID	RT2	RT2	RT2
27	TUBE TO BOILER - BLACK RUBBER	8.8.16	8.8.16	8.8.16
28	HOSE	7.7.0.1/4	7.7.0.1/4	7.7.0.1/4

Internal Parts For Rinse Aid Injector				
17	OUTLET CAP	7.7.0/10	7.7.0/10	7.7.0/10
18	CUTAWAY WASHER	NOT AVAILABLE		
19	SPRING	NOT AVAILABLE		
20	BALL BEARING	NOT AVAILABLE		
21	LIP VALVE	7.7.12	7.7.12	7.7.12
22	DIAPHRAM	7.7.17	7.7.17	7.7.17
23	REAR HOUSING	7.7.0/15A	7.7.0/15A	7.7.0/15A
24	INLET CAP	7.7.0/17	7.7.0/17	7.7.0/17

CLASSIC GLASS & DISHWASHING SYSTEMS LTD

ECO1/2 & H500 WASH & JET SYSTEM

ECO1 & ECO2 TOP RINSE ARM

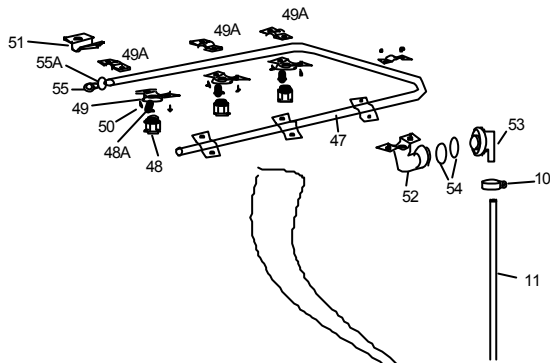

H500 TOP ARM ASSEMBLY

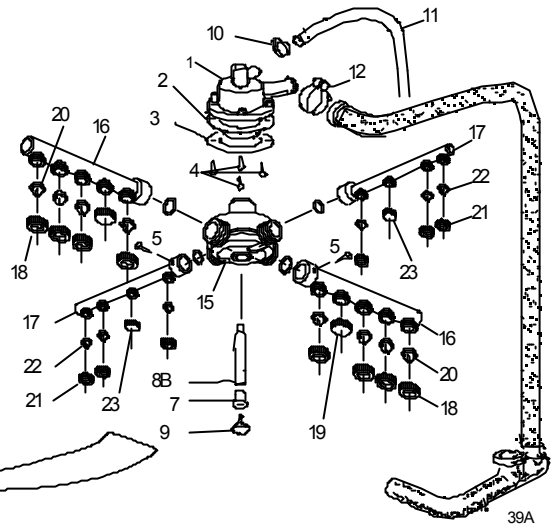

PLASTIC
43
38
37A

BRASS
43A
38
37A

WAS A DOUBLE BOSS
NOW SINGLE BOSS KIT

38A
37

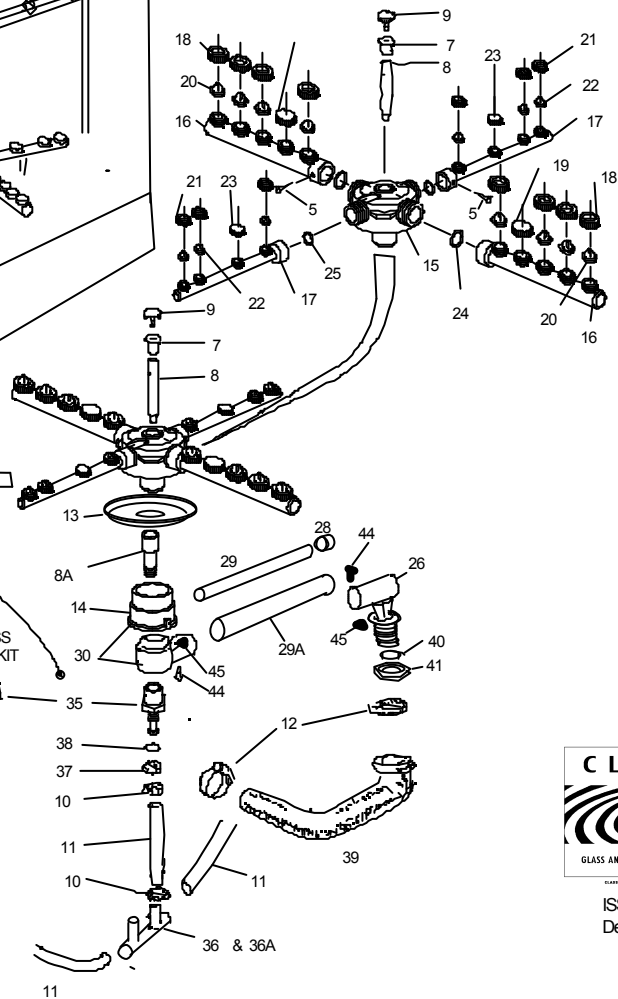



WASH & JET SYSTEM

		ECO1	ECO2	H500
1	TOP BOSS			12.2.1/4A
2	GASKET			12.2.2
3	TOP FLANGE			13.2.11/1
4	SCREW			SC005A
5	SELF TAP SCREW FOR ARMS	7.4.17	7.4.17	7.4.17
7	BUSH FOR CENTRE BOSS	11.1.9	11.1.9	11.1.9
8	BOTTOM SPINDLE 8MM	11.1.7/3	11.1.7/3	11.1.7/3
8A	BOTTOM SPINDLE SPACER	11.1.7/5	11.1.7/5	11.1.7/5
8B	TOP SPINDLE 8MM	11.1.7/2	11.1.7/2	11.1.7/2
9	SPINDLE BOLT	11.1.8/2	11.1.8/2	11.1.8/2
10	HOSE CLIP	7.4.12/1	7.4.12/1	7.4.12/1
11	RINSE HOSE	8.8.15	8.8.15	8.8.15
12	HOSE CLIP	7.4.12/2	7.4.12/2	7.4.12/2
13	BOTTOM FLANGE	11.1.10/6	11.1.10/6	11.1.10/6
14	SPACER FOR BOTTOM BOSS	11.1.10/4	11.1.10/4	11.1.10/4
15	CENTRE BOSS	11.1.0/1	11.1.0/1	11.1.0/1
16	WASH ARM	11.1.6/5	12.1.6/5	12.1.6/5
17	RINSE ARM	11.1.6/6	12.1.6/6	12.1.6/6
18	WASH JET NUT	11.1.6/7	11.1.6/7	11.1.6/7
19	WASH JET BLANK	11.1.6/8	11.1.6/8	11.1.6/8
20	WASH JET Left (S)	11.1.6/9	11.1.6/9	11.1.6/9
20	WASH JET Right (D)	11.1.6/10	11.1.6/10	11.1.6/10
21	RINSE JET NUT	11.1.6/11	11.1.6/11	11.1.6/11
22	RINSE JET	11.1.6/12	11.1.6/12	11.1.6/12
23	RINSE JET BLANK	11.1.6/14	11.1.6/14	11.1.6/14
24	O SEAL (Wash)	11.1.6/15	11.1.6/15	11.1.6/15
25	O SEAL (Rinse)	11.1.6/16	11.1.6/16	11.1.6/16
26	WASH ELBOW (one piece)	11.1.2/1A	11.1.2/1A	11.1.2/1A
28	INSERT FOR SMALL TUBE	11.1.2.1	11.1.2.1	11.1.2.1
29	TUBE- SMALL TUBE WITH INSERT	11.1.4	12.1.4	12.1.4
29A	TUBE - LARGE (1995 on)	11.1.4N	12.1.4N	12.1.4N
30	BOTTOM BOSS WITH SPACER	11.1.5/2	11.1.5/2	11.1.5/2
35	SUPPORT - SINGLE BOSS	7.5.5/2	7.5.5/2	7.5.5/2
35A	REPLACEMENT KIT -DOUBLE BOSS	7.5.5/2-KIT	7.5.5/2-KIT	7.5.5/2-KIT
36	DOUBLE TEE FOR RINSE HOSE	7.15.2/2	7.15.2/2	7.15.2/2
36A	SINGL TEE PIECE	7.15.2	7.15.2	7.15.2
37	NUT FOR SINGLE BOSS	7.3.13/1	7.3.13/1	7.3.13/1
37A	NUT FOR DOUBLE BOSS	7.3.13	7.3.13	7.3.13
38	O SEAL SINGLE BOSS	7.5.9	7.5.9	7.5.9
38A	O SEAL DOUBLE BOSS	7.5.9/1	7.5.9/1	7.5.9/1
39	HOSE - WASH PUMP OUTLET	7.4.7	8.4.7	39A 12.2.10A
40	O SEAL	7.4.13	7.4.13	7.4.13
41	NUT	7.4.6	7.4.6	7.4.6
43	BLANKING BOLT - 3/8"PLASTIC	11.1.18	11.1.18	11.1.18
43A	BRASS PLUG	11.1.18/2	11.1.18/2	11.1.18/2
44	SCREW 5mm	11.1.3	11.1.3	11.1.3
45	NUT 5MM	7.2.41	7.2.41	7.2.41
47	UPPER FIXED RINSE ARM - ECO1/2	7.5.1/2E	8.5.1/2E	
48	RINSE JET NUT	7.5.3	7.5.3	
48A	RINSE JET INSERT	7.5.2	7.5.2	
49	RINSE JET HOLDER	7.5.14	7.5.14	
49A	HOLDER CLAMP	11.1.17	11.1.17	
50	SCREW 4mm x 10mm	11.1.19	11.1.19	
51	RINSE ARM CLAMP	7.5.14/1	7.5.14/1	
52	GOOSENECK PART 1	11.1.1/1E	11.1.1/1E	
53	GOOSENECK PART 2	11.1.1/2E	11.1.1/2E	
54	O SEAL	7.5.9/2	7.5.9/2	
55	PLUG FOR FIXED RINSE ARM	11.1.15	11.1.15	
55A	SEAL FOR PLUG	11.1.14	11.1.14	

CLASSIC GLASS & DISHWASHING SYSTEMS LTD

ECO1/2 & H500 WATER & WASTE SYSTEM

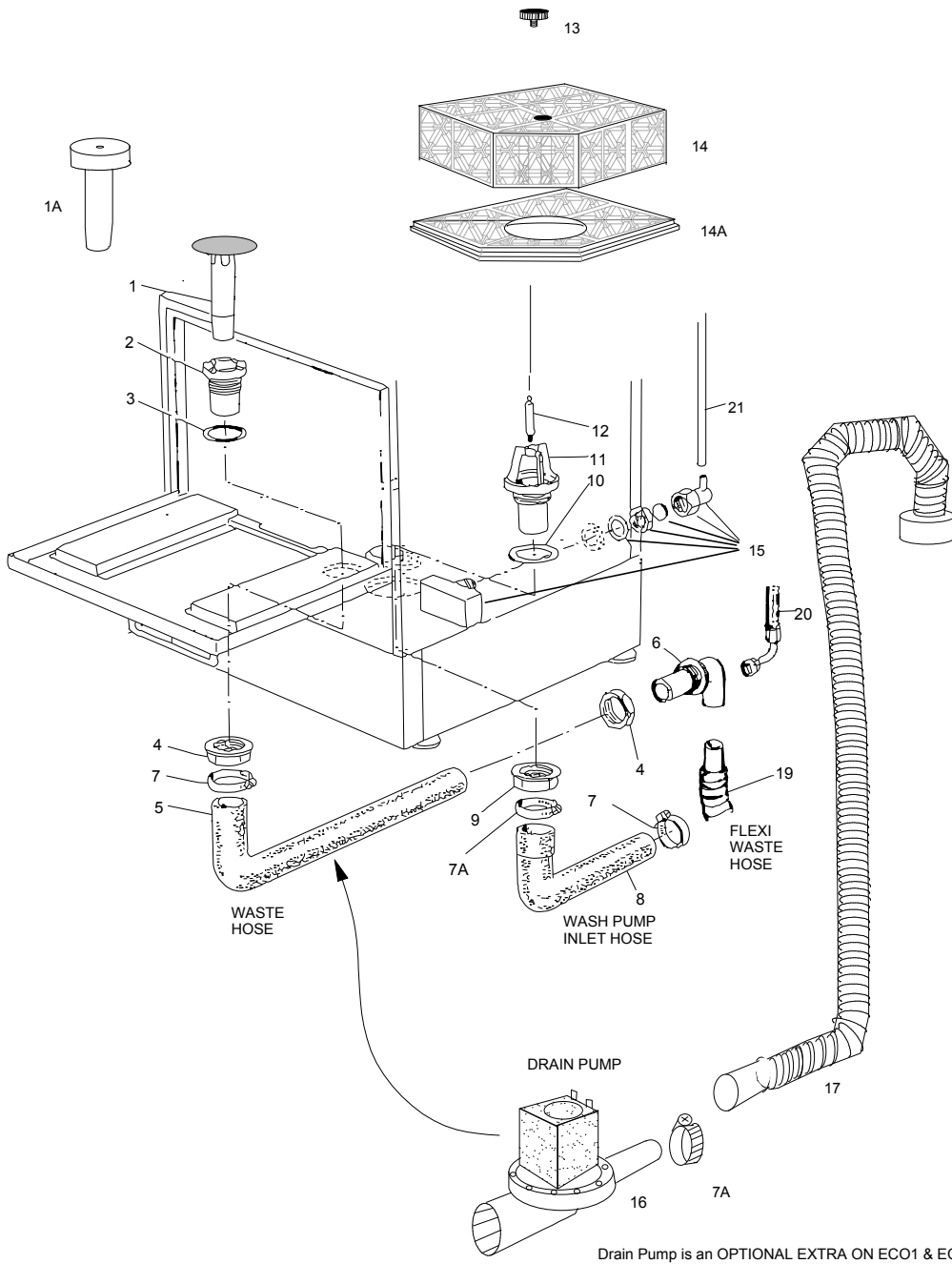

CUT OFF ALONG THIS LINE AND DISCARD TOP PART



BOSS FILTERS & SPIGOTS ECO 1 ECO 2 H500

WASTE BOSS

ECO1 & ECO 2
H500

WASTE BOSS
NO FILTER
NO SPIGOT

7.10.2
WASTE
BOSS



SEAL
7.4.13



NUT
7.4.6



WASH PUMP BOSS/ FILTER & SPIGOT

ECO1 & ECO 2
H500
PRIOR TO
JAN 2001

7.8.1 NUT



FILTER BODY ONLY 7.8.2/1

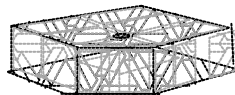

6.8.3
SPIGOT



7.8.4
WASH
BOSS



7.8.13 SEAL
7.8.6 NUT



ECO1 & ECO2
H500
POST JAN 2001

7.8.1 NUT



7.8.2/A WASTE FILTER
ASSEMBLY
FILTER BODY ONLY
7.8.2/1

FILTER BASE ONLY
7.8.2/2

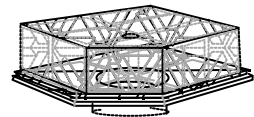

6.8.3/1
SPIGOT



7.8.4
WASH
BOSS



7.8.13 SEAL
7.8.6 NUT



BLANK



WATER & WASTE SYSTEM

		ECO1	ECO2	H500
1	DRAIN PLUG - Gravity Drain - Pre 2000	7.10.1	7.10.1	7.10.1
	DRAIN PLUG - Gravity Drain - Post 2000	7.10.1L	7.10.1L	7.10.1L
1A	DRAIN PLUG - Pump Drain - Pre 2000	7.10.10	7.10.10	7.10.10
	DRAIN PLUG - Pump Drain - Post 2000	7.10.10NT	7.10.10NT	7.10.10NT
2	WASTE BOSS	7.10.2	7.10.2	7.10.2
3	O SEAL	7.4.13	7.4.13	7.4.13
4	NUT	7.4.6	7.4.6	7.4.6
5	WASTE OUTLET HOSE SLEEVE	7.10.3	8.10.3	8.10.3
6	OUTLET ELBOW	7.10.4	7.10.4	7.10.4
7	CLIP FOR HOSE	7.4.12/2	7.4.12/2	7.4.12/2
7A	CLIP FOR HOSE	7.4.12/4	7.4.12/4	7.4.12/4
8	INLET HOSE FOR WASH PUMP	7.8.5	7.8.5	7.8.5
9	NUT	7.8.6	7.8.6	7.8.6
10	O SEAL	7.8.13	7.8.13	7.8.13
11	WASH FILTER BOSS	7.8.4	7.8.4	7.8.4
12	FILTER SPIGOT	6.8.3/1	6.8.3/1	6.8.3/1
13	FILTER NUT	7.8.1	7.8.1	7.8.1
14	PLASTIC FILTER BODY	7.8.2/1	7.8.2/1	7.8.2/1
14A	PLASTIC FILTER BASE	7.8.2/2	7.8.2/2	7.8.2/2
15	AIR TRAP ASSEMBLY	7.11.1AA	7.11.1AA	7.11.1AA
16	DRAIN PUMP (Optional on ECO1/2)	DP2	DP2	DP2
17	WASTE HOSE FOR DRAIN PUMP	DP-HOSE	DP-HOSE	DP-HOSE
19	WASTE HOSE FOR GRAVITY	WH1	WH1	N/A
20	WATER INLET HOSE	7.8.14	7.8.14	7.8.14
21	TUBE FOR PRESSURE SWITCH	RT3	RT3	RT3

ECO1/ECO2 & H500 FILTER SYSTEM

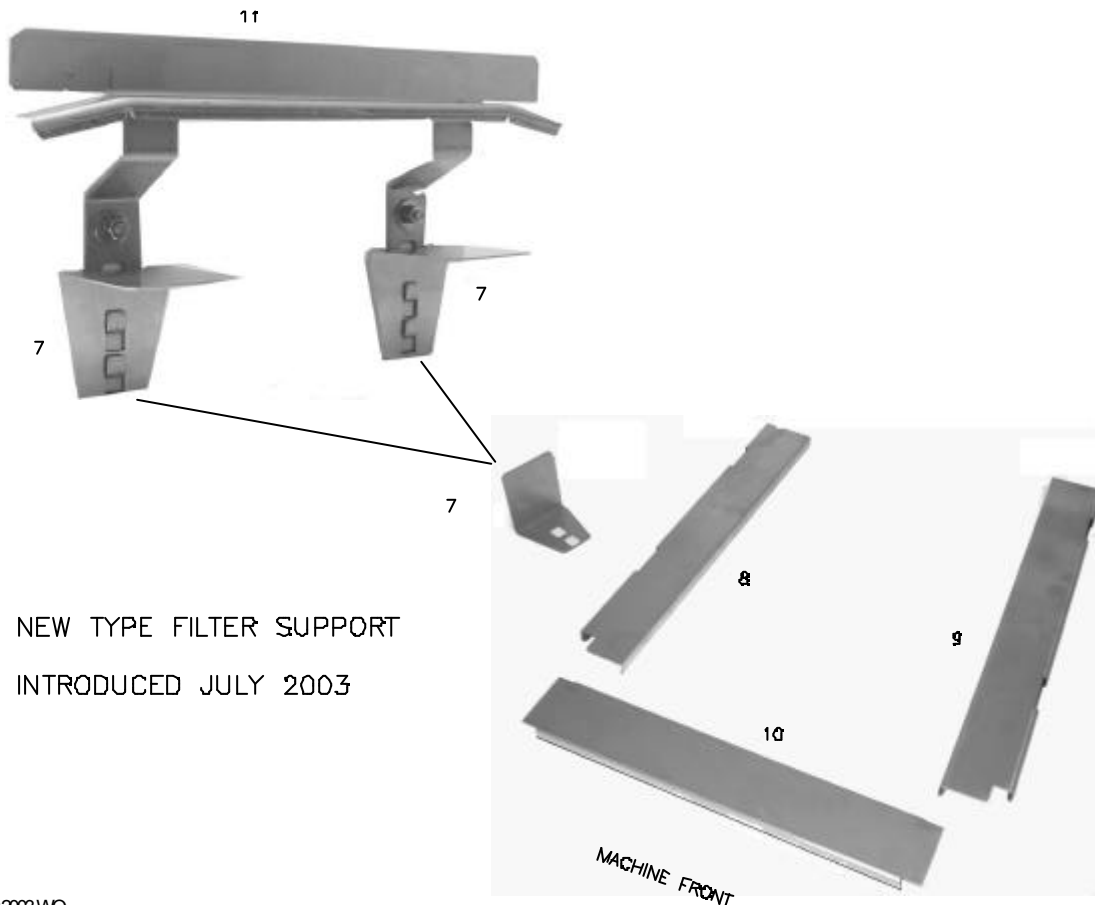
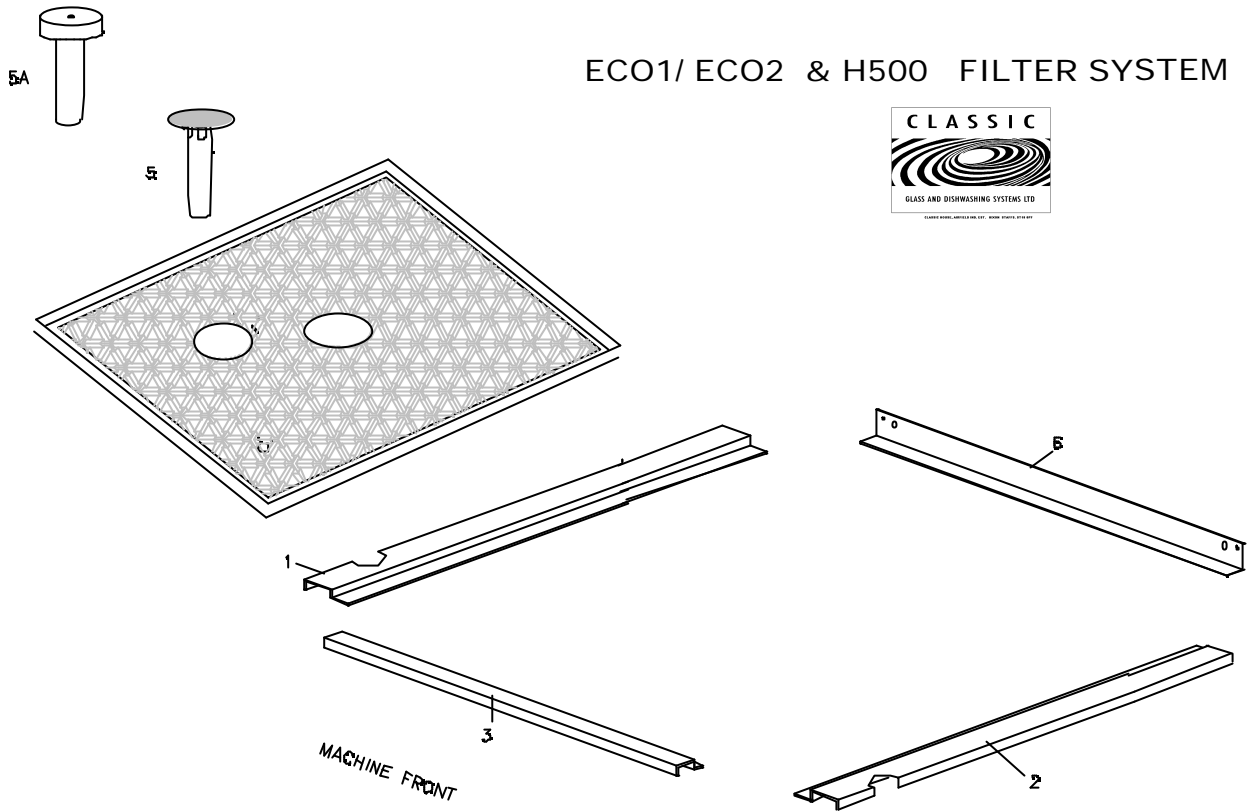

NEW TYPE FILTER SUPPORT
INTRODUCED JULY 2003



FILTER SYSTEM

		ECO1	ECO2	H500
1	LEFT SIDE SUPPORT PANEL	7.2.9/1	8.2.9/1	8.2.9/1
2	RIGHT SIDE SUPPORT PANEL	7.2.9/2	8.2.9/2	8.2.9/2
3	FRONT SUPPORT PANEL	7.2.9/3	8.2.9/3	8.2.9/3
4	PLASTIC FILTER TRAY	7.2.9	8.2.9	8.2.9
5	DRAIN PLUG - Gravity Drain - Pre 2000	7.10.1	7.10.1	7.10.1
	DRAIN PLUG - Gravity Drain - Post 2000	7.10.1L	7.10.1L	7.10.1L
5A	DRAIN PLUG - Pump Drain - Pre 2000	7.10.10	7.10.10	7.10.10
	DRAIN PLUG - Pump Drain - Post 2000	7.10.10NT	7.10.10NT	7.10.10NT
6	BACK SUPPORT PRE 2001	7.2.60	8.2.60	8.2.60
New Basket Runners & Supports Introduced in July 2003				
7	Filter support plate	8.2.21/5	8.2.21/5	8.2.21/5
8	Left Hand Support	7.2.9/1A	8.2.9/1A	8.2.9/1A
9	Right Hand Support	7.2.9/2A	8.2.9/2A	8.2.9/2A
10	Front Support	7.2.9/3A	8.2.9/3A	8.2.9/3A
11	Basket Runner (July 2003) L & R Hand	7.2.21/4	8.2.21/4	8.2.21/4

CLASSIC GLASS & DISHWASHING SYSTEMS LTD

ECO1/2 & H500 ELECTRICAL

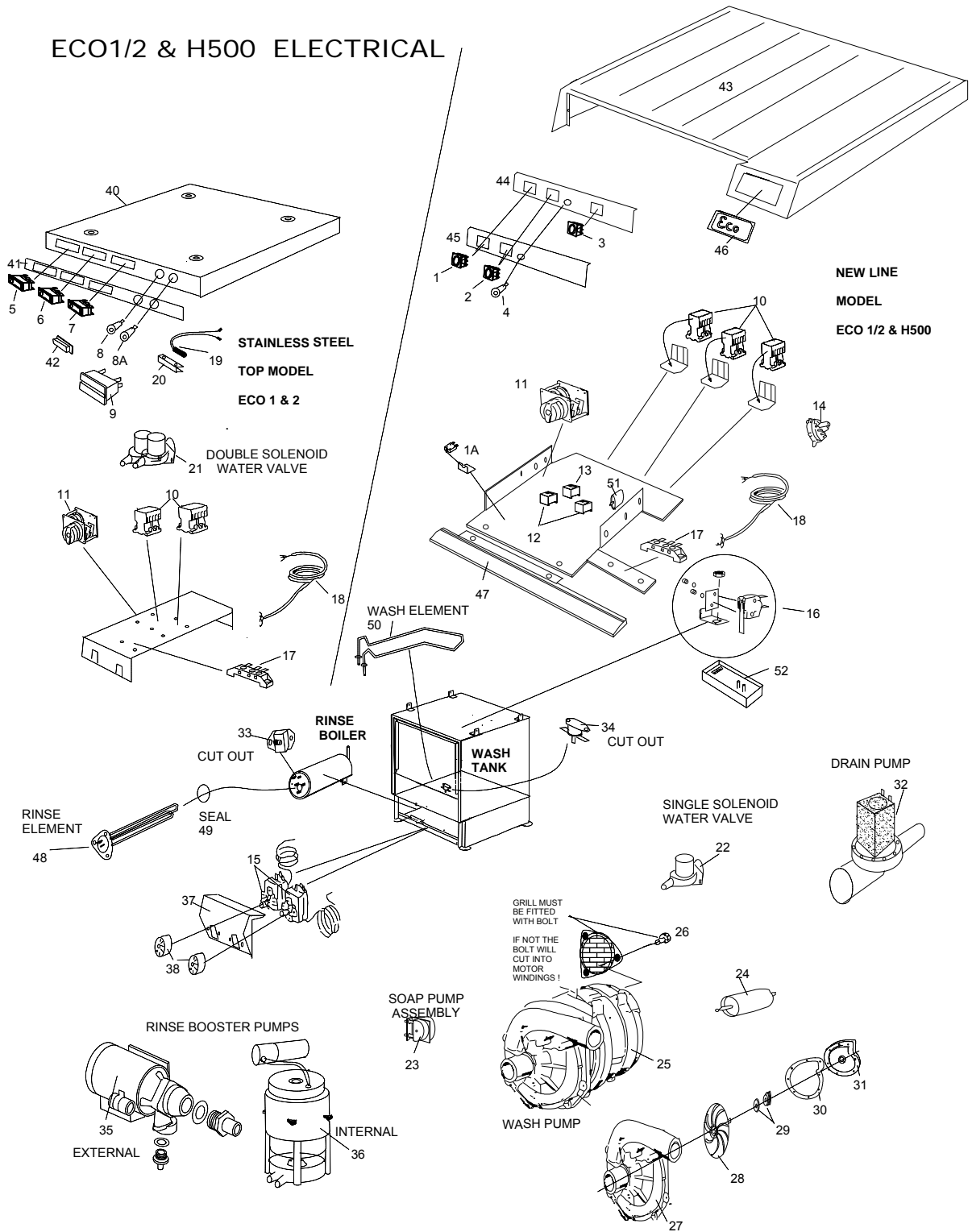



ECO1 /2 & H500 ELECTRICAL

		ECO1		ECO2		H500
1	ON / OFF SWITCH - NEW LINE M/CS	7.12.4/5		7.12.4/5		7.12.4/5
1A	THERMAL CIRCUIT BREAKER	TCB-1		TCB-1		TCB-1
2	MODE SWITCH - NEW LINE M/CS	7.12.4/6		7.12.4/6		7.12.4/6
3	DRAIN SWITCH - NEW LINE M/CS	7.12.4/7A	*	7.12.4/7A	*	7.12.4/7A
4	READY LIGHT - NEW LINE M/CS	7.12.6/1A		7.12.6/1A		7.12.6/1A
5	ON / OFF SWITCH - S/STEEL TOP M/C	7.12.4/1E		7.12.4/1E		N/A
6	WASH SWITCH - S/STEEL TOP M/C	7.12.4/2E		7.12.4/2E		N/A
7	COLD RINSE SWITCH - S/STEEL TOP M/C	7.12.5/E		7.12.5/E		N/A
8	AMBER WARNING LIGHT - WASH TANK	7.12.10/F		7.12.10/F		N/A
8A	GREEN WARNING LIGHT - BOILER	7.12.10/E		7.12.10/E		N/A
9	DOUBLE WARNING LIGHT	7.12.6E		7.12.6E		N/A
10	CONTACTOR 16AMP 240V (3+1NC)	CONTACTOR/4		CONTACTOR/4		CONTACTOR/4
11	TIMER	7.12.2/1		7.12.2/1		7.12.2/2
12	MINI RELAY - 4 PIN	CONT/10		CONT/10		CONT/10
13	MINI RELAY - 5 PIN	CONT/11		CONT/11		CONT/11
14	PRESSURE SWITCH	7.12.9/E		7.12.9/E		7.12.9/E
15	THERMOSTAT - WASH or RINSE	7.12.1/2		7.12.1/2		7.12.1/2
16	DOOR MICRO SWITCH NEW LINE M/CS	7.14.10/1		7.14.10/1		7.14.10/1
17	TERMINAL BLOCK - 3 POLE	7.12.7E		7.12.7E		7.12.7E
18	MAINS CABLE & PLUG	7.12.10/PA		7.12.10/PA		7.12.10/PA
19	REED SWITCH - S/STEEL TOP M/C	7.14.10/1E		7.14.10/1E		N/A
20	BRACKET FOR REED SWITCH	7.14.10/2E		7.14.10/2E		N/A
21	DOUBLE WATER SOLENOID VALVE	7.12.12		7.12.12		N/A
22	SINGLE WATER SOLENOID VALVE	7.12.12/1		7.12.12/1		7.12.12/1
23	SOAP PUMP ASSEMBLY	8LPP4AA		8LPP4AA		8LPP4AA
24	CAPACITOR FOR WASH PUMP	7.12.101		7.12.102		7.12.102
25	WASH PUMP	7.6.0/R		8.6.0/R		8.6.0/R
26	BOLT FOR WASH PUMP	7.6.15		7.6.15		7.6.15
27	HOUSING FOR IMPELLOR	7.6.1/A		7.6.1/A		7.6.1/A
28	IMPELLOR	7.6.2B		7.6.2B		7.6.2B
29	SHAFT SEAL	7.6.3		7.6.3		7.6.3
30	GASKET FOR HOUSING	7.6.13B		7.6.13B		7.6.13B
31	REAR HOUSING	7.6.14B		7.6.14B		7.6.14B
32	DRAIN PUMP - OPTIONAL ON ECO 1/2	DP2		DP2		DP2
33	CUTOUT FOR BOILER HEATER	7.12.4/D		7.12.4/D		7.12.4/D
34	CUTOUT FOR WASH TANK HEATER	7.12.2/DS		7.12.2/DS		7.12.2/DS *
35	RINSE BOOSTER PUMP - EXTERNAL	DKRBP	*	DKRBP	*	DKRBP *
36	RINSE BOOSTER PUMP - INTERNAL	N/A		RBP5	*	RBP5 *
	INTERNAL RBP WITH FITTING KIT	N/A		RBP5A	*	RBP5A
	Internal RBP can NOT be fitted to ECO1					
37	COVER FOR STATS	7.12.1/1A		7.12.1/1A		7.12.1/1A
38	KNOB FOR STATS	7.12.1/2A		7.12.1/2A		7.12.1/2A
40	TOP PANEL - STAINLESS STEEL	7.2.1/E		8.2.1/E		N/A
41	FACIA BADGE FOR ABOVE	FASC/E1		FASC/E2		N/A
42	SWITCH COVER FOR ITEMS 5 / 6 / 7	7.12.4/9		7.12.4/9		N/A
43	TOP PANEL - NEW LINE PLASTIC BLUE	7.2.1P		8.2.1P		8.2.1P
	TOP PANEL - NEW LINE PLASTIC BLACK	7.2.1P-UL		8.2.1P-UL		8.2.1P-UL
44	FACIA PANEL DRAIN PUMP M/CS	7.2.2SD	*	8.2.2SD	*	8.2.2SD
45	FACIA PANEL GRAVITY DRAIN M/CS	7.2.2S		8.2.2S		N/A
46	BADGE FOR NEW LINE M/CS	LABEL-E1		LABEL-E2		LABEL-H5
47	PLASTIC INSERT FOR S/W PANEL-BLUE	7.2.2/PI		8.2.2/P1		8.2.2/PI
	PLASTIC INSERT FOR S/W PANEL-BLACK	7.2.2/PI-UL		8.2.2/PI-UL		8.2.2/PI-UL
48	RINSE ELEMENT	9.9.14		9.9.14		9.9.14
49	SEAL FOR RINSE ELEMENT	7.9.12		7.9.12		7.9.12
50	WASH ELEMENT & SEALS	7.12.17		7.12.17		7.12.17
51	RF SUPPRESSOR	7.12.101/1		7.12.101/1		7.12.101/1
52	SOAP PCB BOARD	N/A		N/A		CLM210

BLANK



MODIFICATIONS

CLASSIC HOUSE, AIRFIELD INDUSTRIAL ESTATE, HIXON , STAFFORDSHIRE ST18



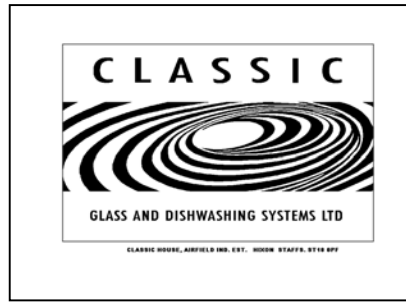

RINSE AID INJECTORS 7.7.0.1 / 7.7.0.1/1

MACHINE PRODUCTION

From September 97 our supplier of rinse aid injectors have changed the design of the in & out end connections to improve the quality of fitting.

The connection on the rinse tank has also been improved.

Both ends of the injector and the rinse tank connection are now push on fit with a ridge, where a clip is fitted on the rinse tank and cable ties on the injector.

REPLACING WITH OLD STYLE INJECTOR

If a RINSE AID INJECTOR needs replacing you can use the old type , but , the end caps need changing over, (do not loose the cut washer/spring & ball).

SERVICE REPLACEMENTS

When the existing stocks of the old style are exhausted the new style will be supplied with a small kit of parts and the instructions. (copy attached)

Please note: if required you can change the end caps for the old style, but do not loose the cut washer /spring & ball.

injwo2 11/11/97

7.7.0/23A

PARTS INCLUDED IN KIT

- 7.7.0/21 BOILER CONNECTOR
(Stainless Steel)
- 7.7.0/20 RUBBER 'O' SEAL (Red)
- 7.7.0/22 METAL CLIP
- 7.7.0/10 INLET CAP
- 7.7.0/17 OUTLET CAP
- RT3 Special TUBE (40cm long)
- 4 CABLE TIES

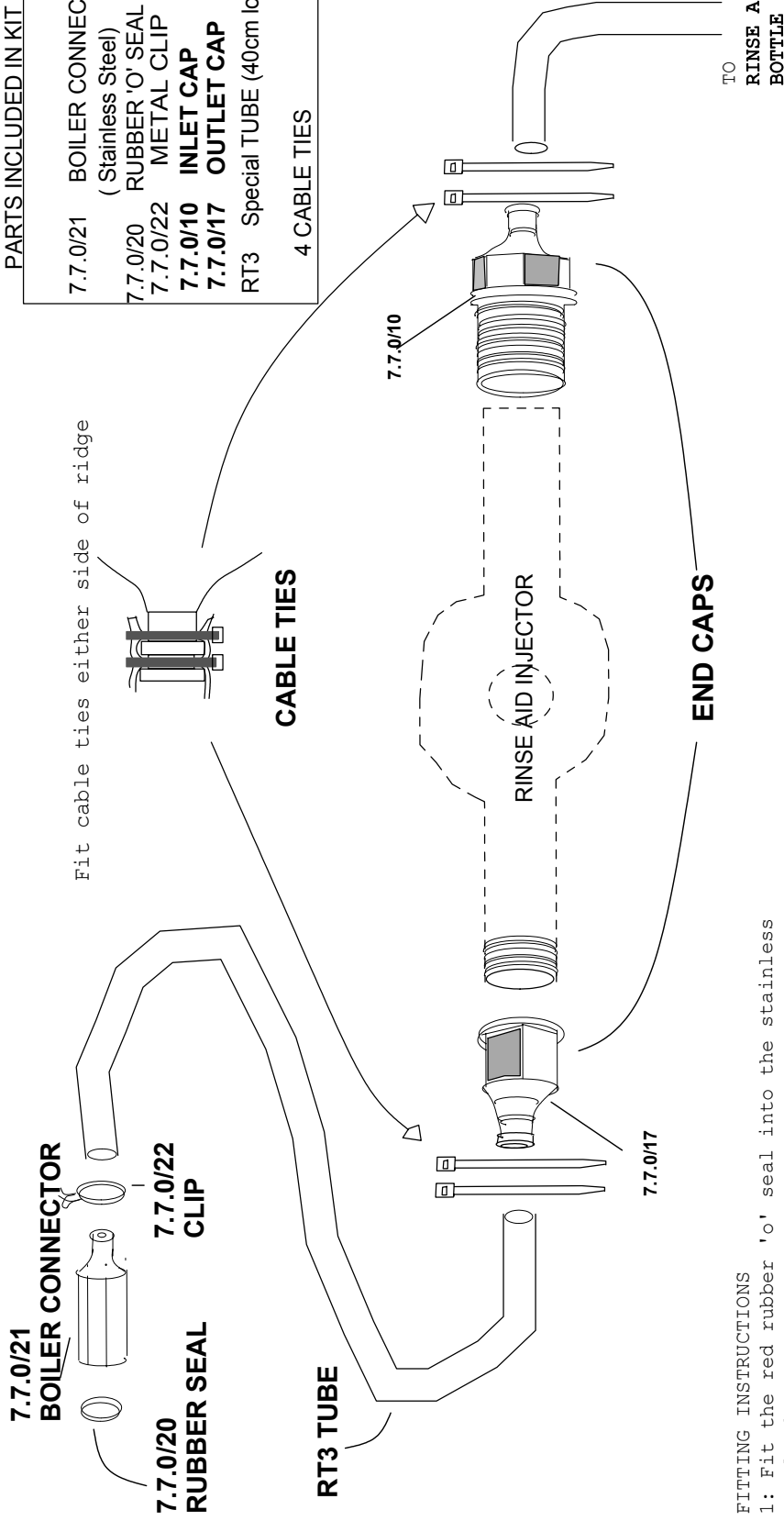

FITTING INSTRUCTIONS

- 1: Fit the red rubber 'o' seal into the stainless steel adaptor.
- 2: Fit the adaptor to the rinse aid fitting onto the rinse tank
- 3: Place the metal clip onto the special tubing
- 4: Fit the Tubing onto the Stainless steel adaptor, fit the clip over tube on the adaptor using pliers.
- 5: Fit new type tube onto the outlet end of the injector, (arrows on injector indicate flow)
- 6: Fit tube from r/a bottle to inlet side of injector
- 7: Fit 2 cable ties to each end of Rinse aid injector securing the tubes

SPECIAL NOTE
THIS CHANGE IS DUE TO OUR SUPPLIER IMPROVING THE DESIGN FOR EASE OF ASSEMBLY.

please note:
THE END CAPS ARE INTERCHANGABLE WITH THE OLD TYPE.

CLASSIC GLASS & DISHWASHING SYSTEMS Ltd
CLASSIC HOUSE
AIRFIELD IND ESTATE HILXON ST18 0PF

TITLE

RINSE AID INJECTOR
MODIFICATION - MAY 99

SIZE	CAGE CODE	DWG NO	REV
		WO MAY 99	
SCALE	SHEET		



wo 6/98

CLASSIC GLASS & DISHWASHING SYSTEMS LTD

7.5.5/2 KIT

FOR USE ON ECO 1 & ECO 2
REPLACEMENT FOR DOUBLE BOSS 7.5.5/1

The plastic double boss is no longer available .
The items below are a straight replacement
The Boss & Plug are now made of chromed brass.

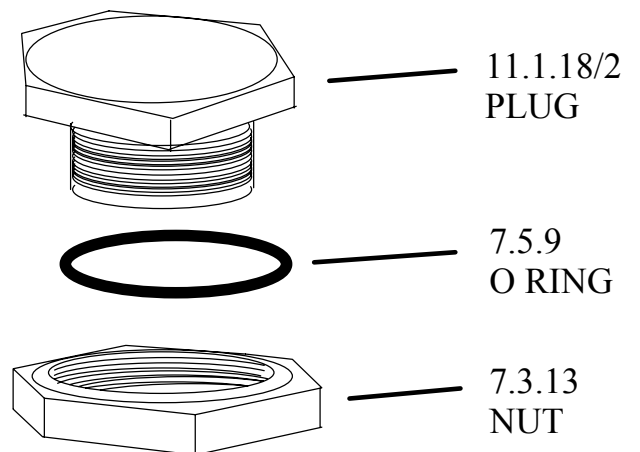
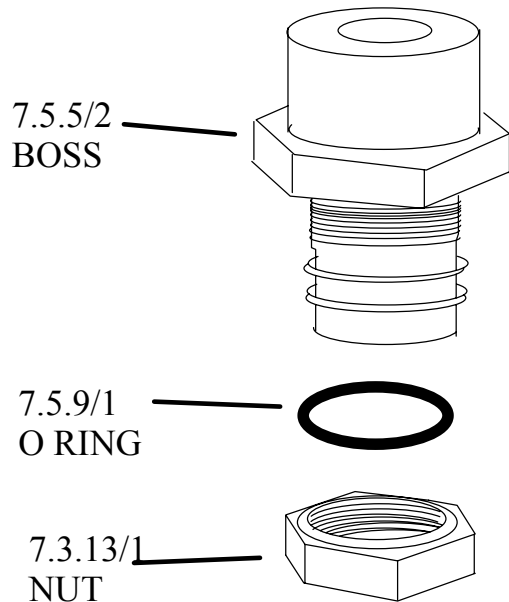

CLASSIC GLASS & DISHWASHING SYSTEMS LTD



wo 7/98

Part No 7.5.5/2

FOR USE ON ECO 1 & ECO 2
REPLACEMENT FOR DOUBLE BOSS 7.5.5/1

The plastic double boss is no longer available .
The Metal single boss is a replacement.
You must first cut the old double boss to re use
the blanking plug with the new single boss.

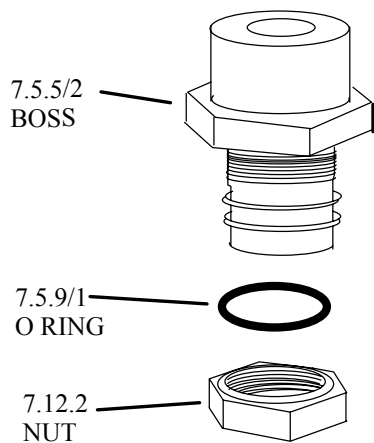
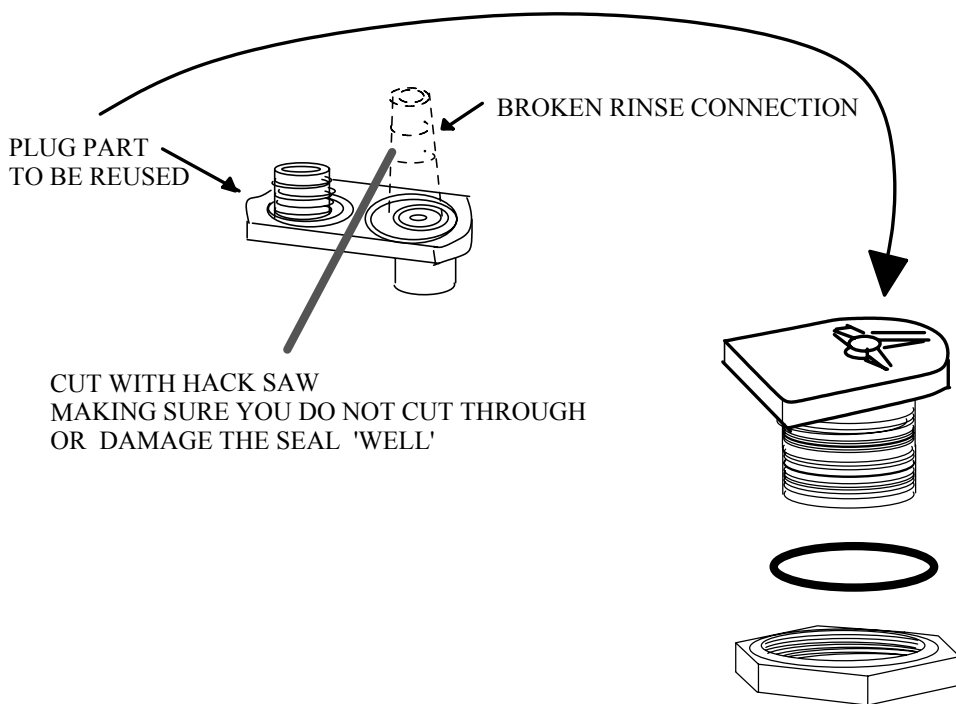

RE-FIT THE BLANKING PLUG TO THE MACHINE
BEFORE YOU FIT THE NEW RINSE BOSS

ONLY THE RINSE BOSS IS SUPPLIED
UNDER THIS PART NUMBER
THE SEAL AND NUT MUST BE ORDERED
SEPARATE

CLASSIC GLASS & DISHWASHING SYSTEMS LTD

ECO1 & 2 NEW LINE MACHINES

FAULT1 : Machine restarts filling & will not stop .
If drained down this will re-occur after 1 or 2 washes

FAULT 2: Machine is leaking from Double boss (either broken or cracked)

THESE INSTRUCTIONS SUPERCEED THE instructions given 4/8/97 WO

Further tests have indicated the problem is related to the way the alignment of the centre assembly the tube and elbow assembly.

If they are not assembled in line, it causes stress either in the elbow causing it to 'cock' over and/or the centre boss, causing the rinse nipple to fracture.

INSTRUCTIONS

- 1: Check to see if there is 1 screw in the back elbow, if so read on
IF THERE ARE 2 SCREWS IN THE ELBOW - GO TO Section ###
 - 2: Untighten the nut & bolt 'A' & remove screw 'B'
 - 3: Lift the rear elbow - only slightly, gently manipulate it back into its correct alignment with the vertical column; i.e. flat and at 90'. push firmly downwards to ensure correct seating
 - 4: Drill & fit a new stainless self tapping screw , 1/2" from the old screw hole , 1/4" up from bottom of elbow then refit the old screw.
 - 5: Tighten nut & bolt 'A'
- WATER TEST MACHINE & CHECK THE DOUBLE BOSS IS NOT LEAKING.

IF THE BOTTOM DOUBLE BOSS IS REPLACED WITHOUT CHECKING THE CORRECT ALIGNMENT, THERE IS A HIGH RISK OF IT FRACTURING AGAIN IN THE FUTURE

SECTION ### (2 Screws in the back elbow)

The fault will be 'leaking water from bottom rinse hose connection'

- 7: remove old double boss, fit new double boss in base of m/c & connect up hose
- 8: Untighten nut & bolt 'A', twist so that the boss sits square in double boss
- 9: refit centre boss to double boss & water test.



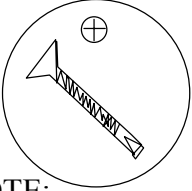

NOTE:
With this memo I have included a special self drilling screw. This is for drilling a templete hole only and should be kept for reuse
Do not fit it !
it is not STAINLESS STEEL

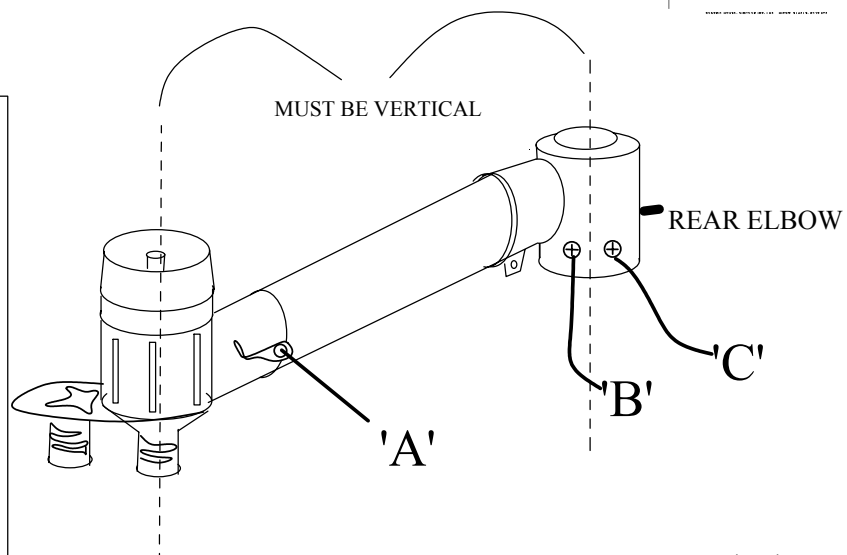

10/11/97 wo

CLASSIC GLASS & DISHWASHING SYSTEMS LTD
CLASSIC HOUSE, AIRFIELD IND ESTATE, HIXON ST18 0PF

FITTING DRAIN PUMP TO ECO2 New Line

1. Fit existing cables to new switches in panel - wire for wire
2. Connect 3 cables to new switch(these are cable tied together behind switch)

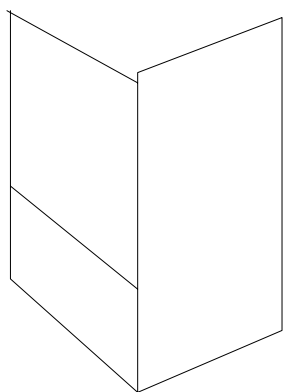
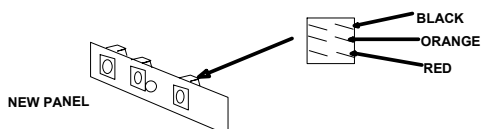

WO 4/97

3 Remove old waste hose and elbow in rear of machine

4 Modify old waste hose - cut hose 50mm (2") from inside edge of elbow

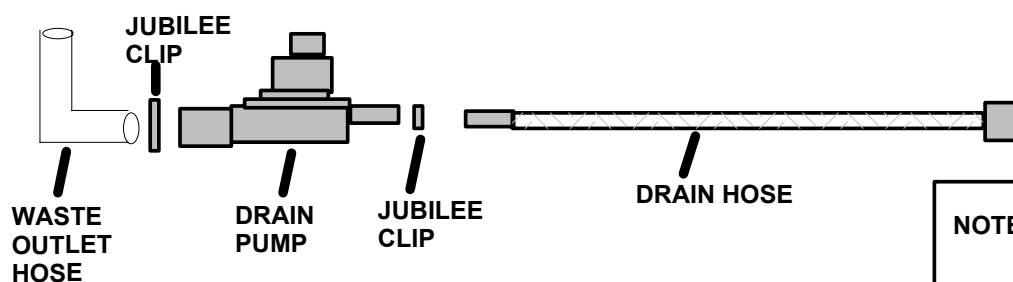
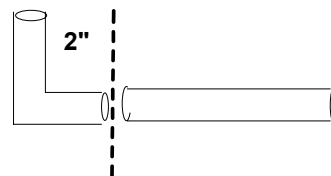

NOTE: Drain pump is not fixed by any brackets

5. Fit hoses to drain pump
6. Feed drain hose through rear of machine
7. Connect cables to drain pump ORANGE and BLUE (already in loom)
8. Refit waste outlet hose to waste in bottom of wash tank.
9. TEST

NOTE: When filling and rinsing the drain pump works automatic

To empty wash tank - remove drain plug - press and hold drain switch until empty.

CLASSIC GLASS & DISHWASHING SYSTEMS LTD

FITTING NEW TYPE RINSE BOOSTER PUMP TO New Line machines

The RBP5 kit of parts are bolted to the bracket when it is despatched, you only have to move the detergent pump and fit the assembly to the machine connect up the hoses and piggy back cables to the water solenoid water valve.

Bracket is fixed along the rail below the water valve. see R/H of drawing for position

Piggy back on to water valve

PART NUMBER	RBP5A
RBP5	RINSE BOOSTER PUMP
7.12.107	CAPACITOR
7.6.6/30	BRACKET
	10 mm NUT & BOLT x 4
7.7.0.1/2	WASHER & STAR WASHER x 4
8.8.20	HOSE FITTED TO ECO2 ONLY
7.4.12/1	HOSE CLIP X 2

THIS PUMP MUST BE CONNECTED TO EARTH

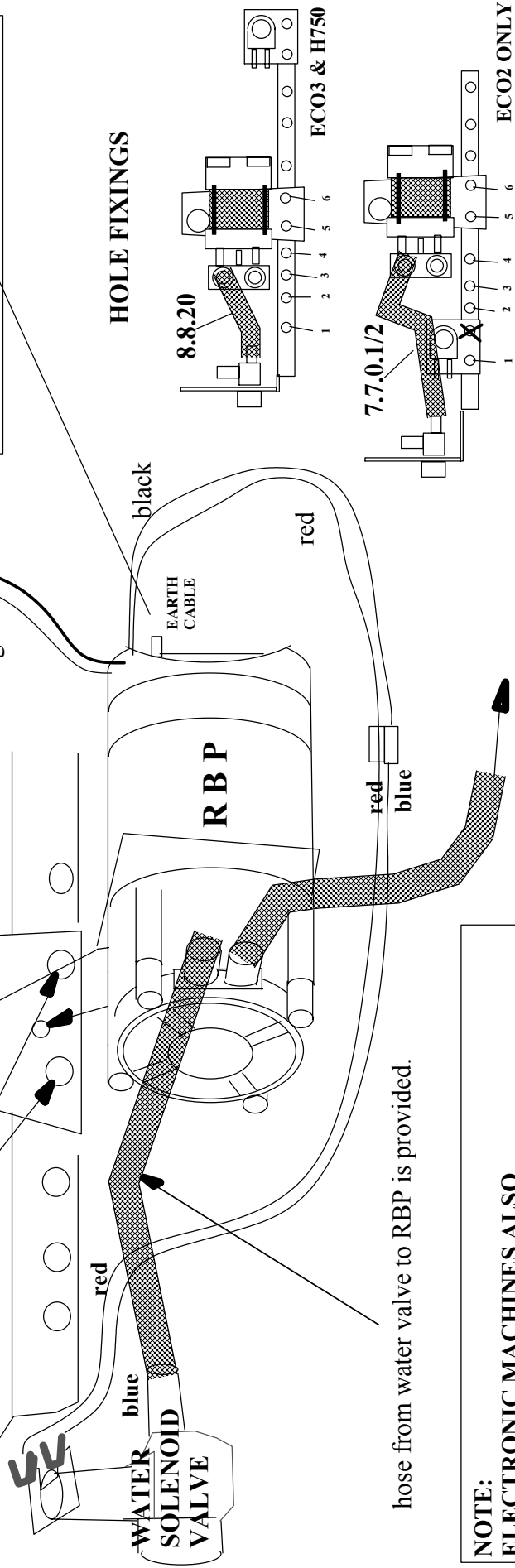

hose from water valve to RBP is provided.

Hose to rinse tank.

NOTE:
ELECTRONIC MACHINES ALSO HAVE A 12 VOLT CONTACTOR FITTED AS THE WATER SOLENOID VALVE IS 12 VOLT

DETERGENT PUMP - ECO2
You will need to move the detergent pump to different fixing position on the rail.





WO 8/99

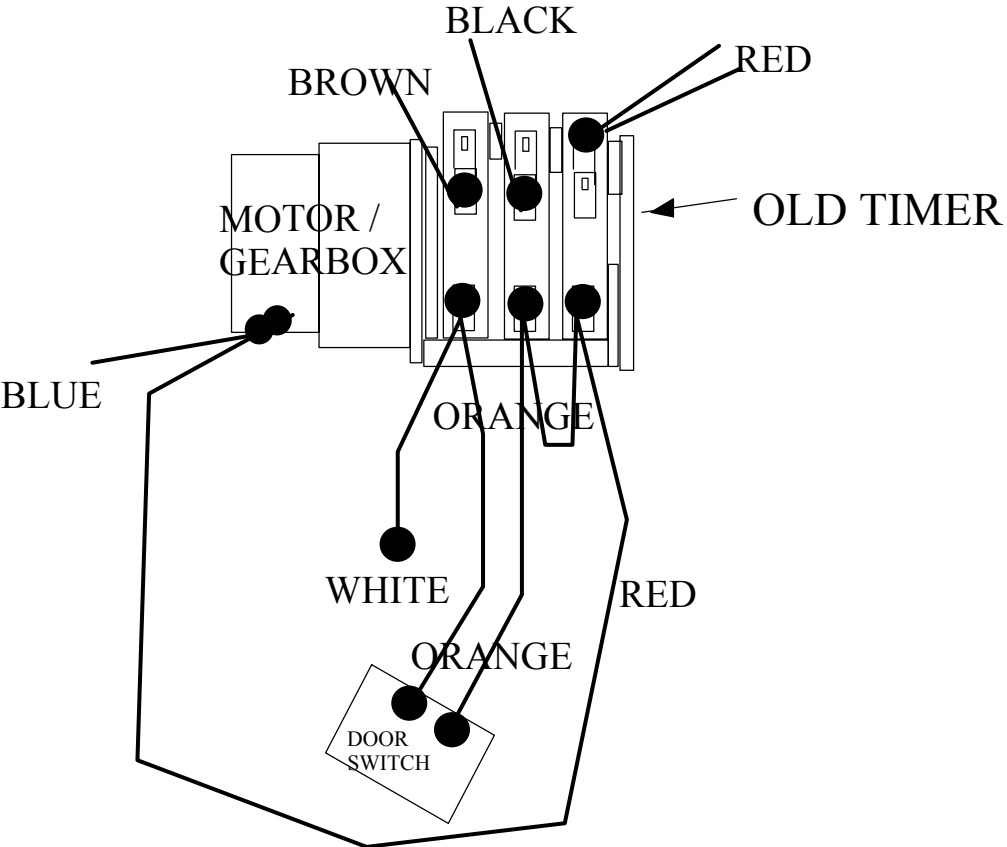

REPLACEMENT TIMERS
7.12.2/1 2 MIN. TIMER
7.12.2/2 4 MIN. TIMER

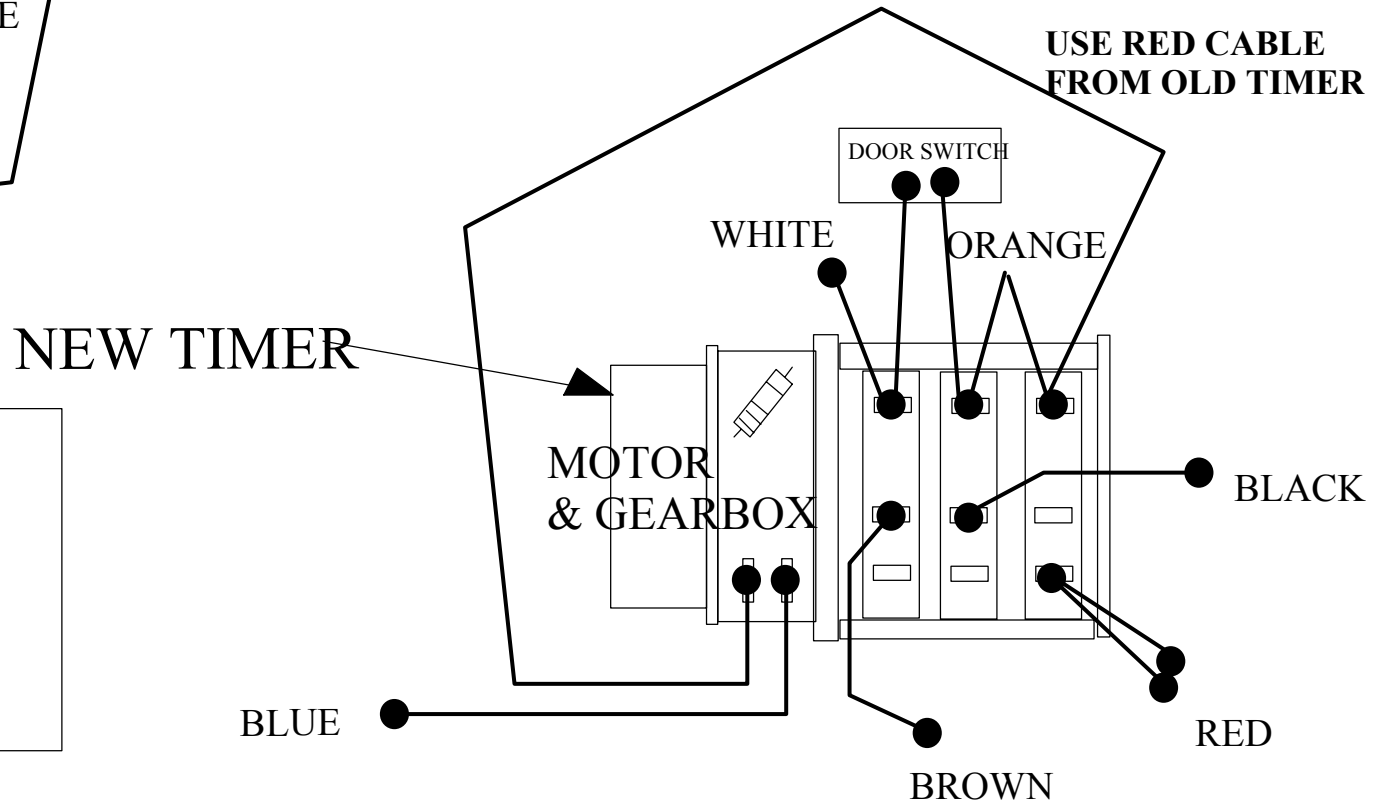

**NOTES ON NEW TIMER:
 WHICH WAY UP ?**
 TOP ROW OF TERMINALS
 ARE SET BACK
 WHITE CAM LIFTERS UNDER
 BOTTOM OF TIMER

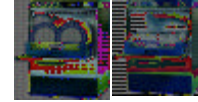

**ECO1NL / E1
WASH PUMPS**



Part No: 7.6.0/R
Black Wash Pump
For Remote Mounted Rinse-Aid
Pump

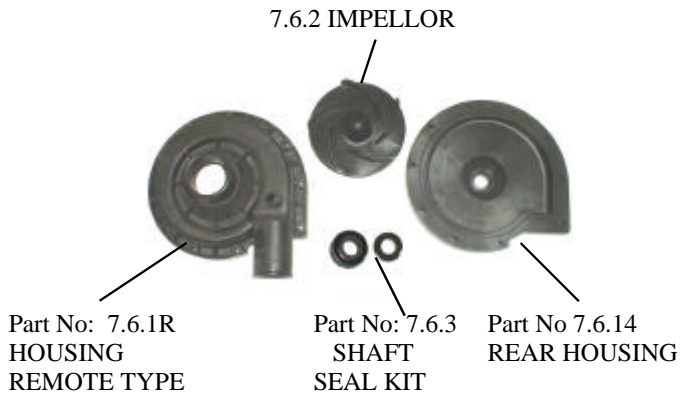

GASKET NOT SHOWN - 7.6.13B

from July 2001 Some Wash Pumps Are 'WHITE'
Machines with 'WHITE' WASH PUMPS have a
serial number starting with 8 eg 830278-212

Part No: DS500-05-10
White Wash Pump
..3HP
Used on machines with Serial Nos
starting with 8



Note:ECO1 only : the WHITE Wash pump is fitted with the water outlet coming from the
lower and these extra parts are required : Outlet Hose : 8.4.7 S/Steel Sleeve:7.15.2/10

Check before you order !!

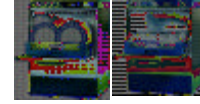

**ECO2NL / E2 / H500NL / H5
WASH PUMPS**



Part No: 8.6.0/R
Black Wash Pump
For Remote Mounted Rinse-Aid
Pump

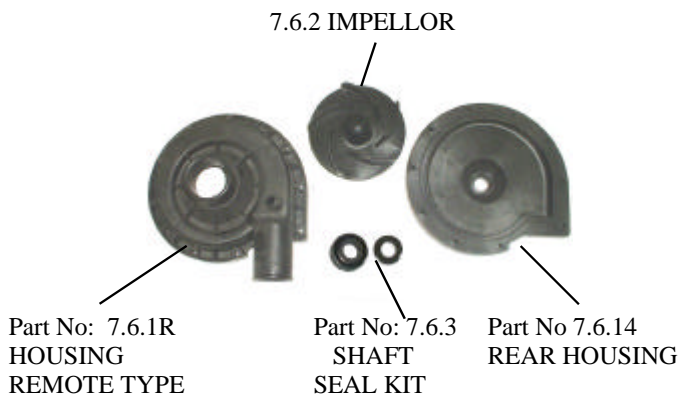

GASKET NOT SHOWN - 7.6.13B

from July 2001 Some Wash Pumps Are 'WHITE'
Machines with 'WHITE' WASH PUMPS have a
serial number starting with 8 eg 830278-212

Part No: DS400-04-10
White Wash Pump
..6HP
Used on machines with Serial Nos
starting with 8

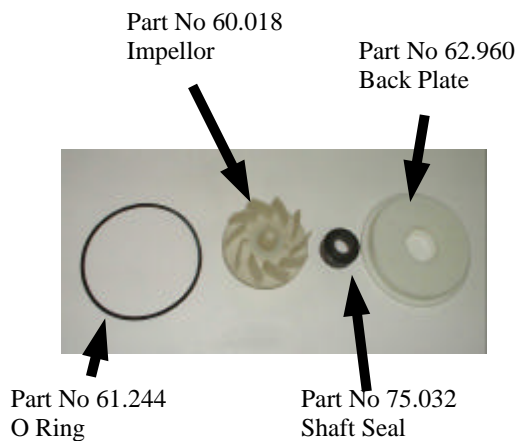

Check before you order !!

BLANK



DRAWINGS ECO 1 & 2 STAINLESS STEEL TOP



CLASSIC HOUSE, AIRFIELD INDUSTRIAL ESTATE, HIXON , STAFFORDSHIRE ST18



December 2003 WO

CLASSIC GLASS & DISHWASHING SYSTEMS LTD ECO1 / 2 STAINLESS STEEL TOP PANEL



ISSUE 7
JULY 2003 WO

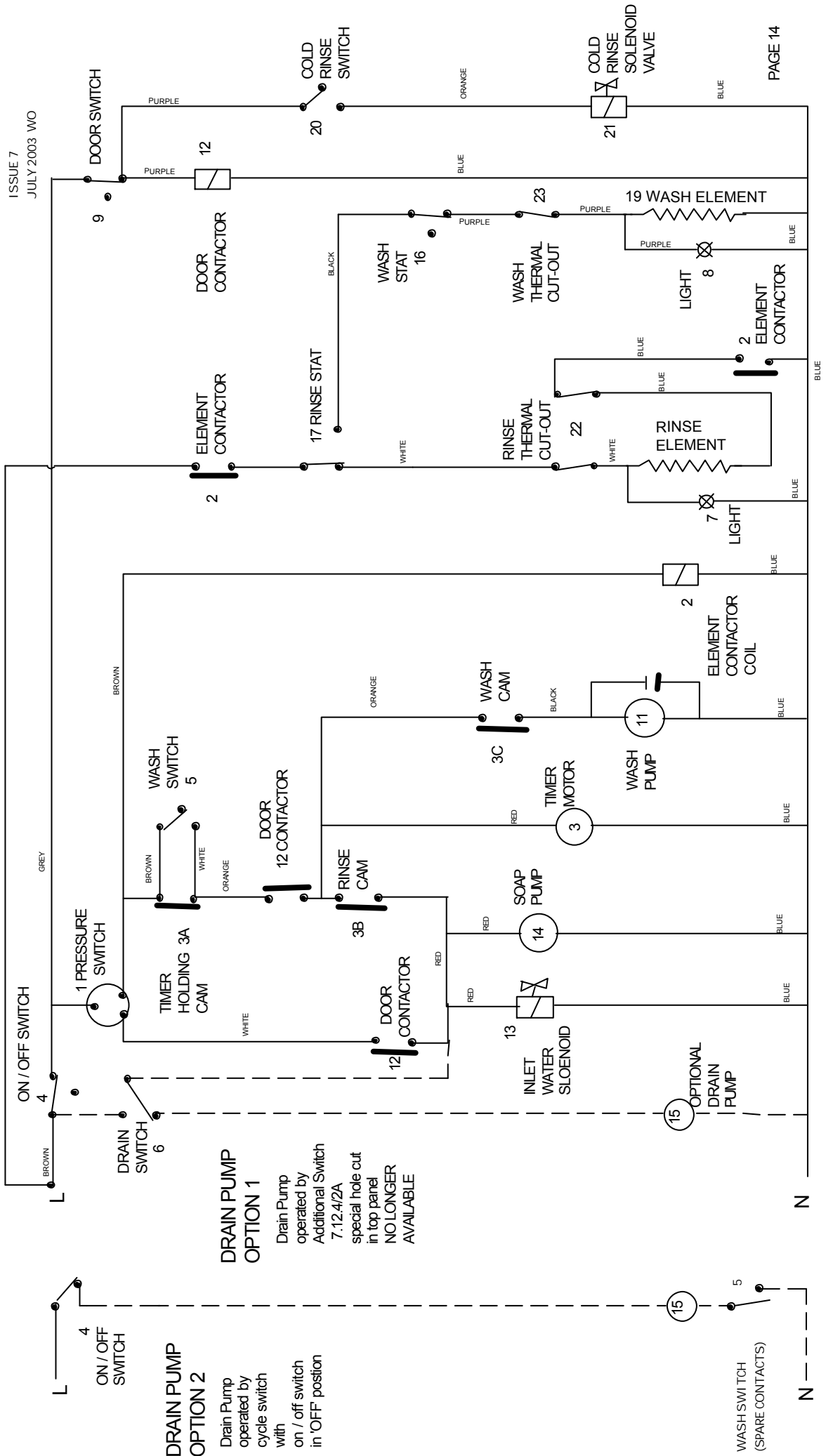

ECO 1 & 2 STAINLESS STEEL TOP PANEL -GLASSWASHERS

TOP PANEL COMPONENT WIRING

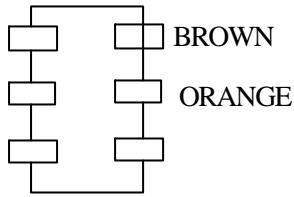

NOTE:
When fitting Drain Pump on 'OPTION 1' use 7.12.4/2A switch

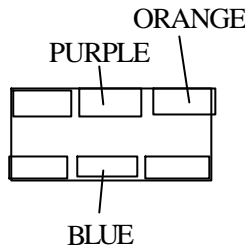

COLD RINSE SWITCH

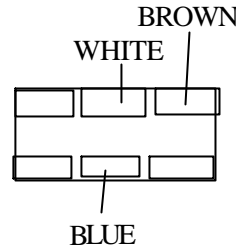

WASH SWITCH

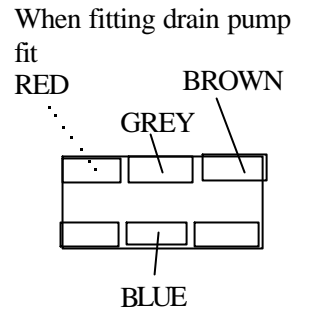

ON/OFF S/W

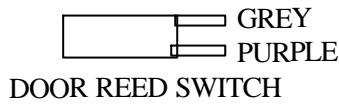

DOOR REED SWITCH

NOTE:
When fitting drain pump on 'OPTION 2' change over the brown and grey cables on the on/off s/w

RINSE ELEMENT CUTOUT

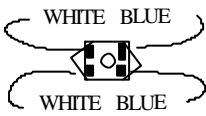

WASHELEMENT CUTOUT

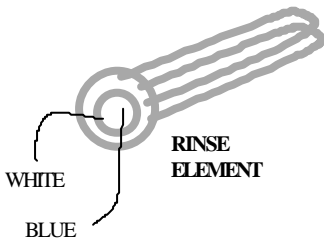
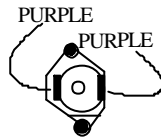

RINSE ELEMENT

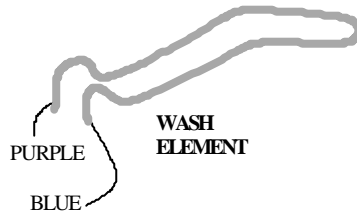

WASH ELEMENT

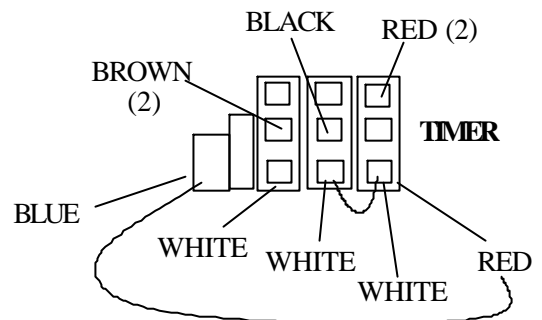

TIMER

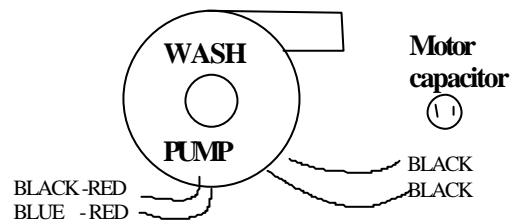

WASH PUMP

Motor capacitor

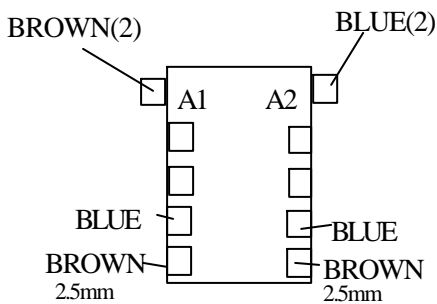

ELEMENT CONTACTOR

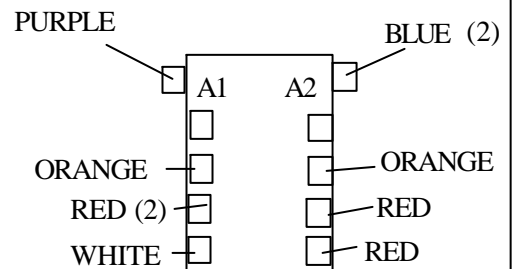

DOOR CONTACTOR



CIRCUIT DRAWINGS ECO1NL & ECO2NL & H500NL



CLASSIC HOUSE, AIRFIELD INDUSTRIAL ESTATE, HIXON , STAFFORDSHIRE ST18



December 2003 WO

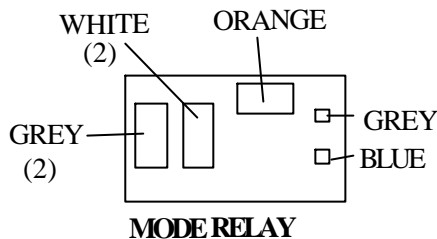
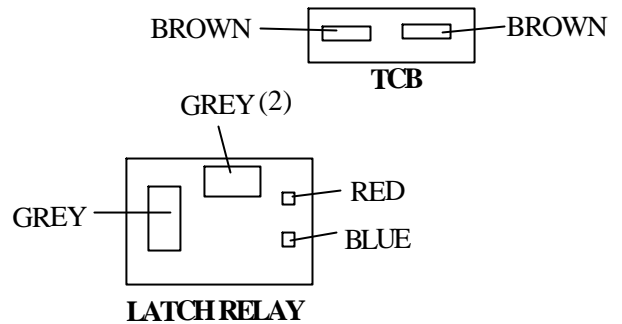
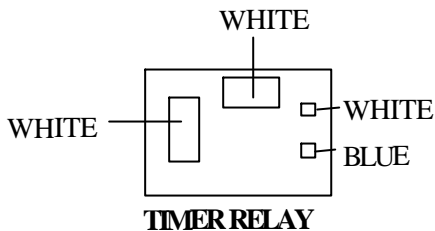
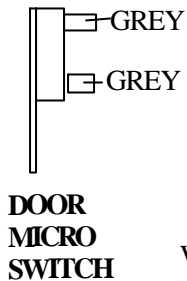
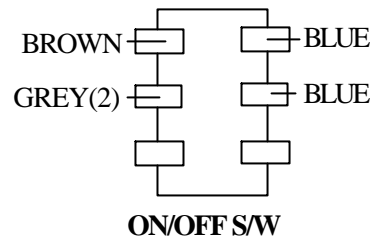
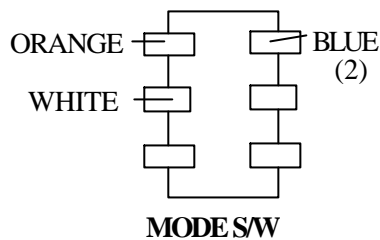
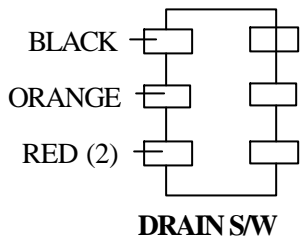

**NOTE: (2) = Double Cable
2.5 = 2.5mm Cable**

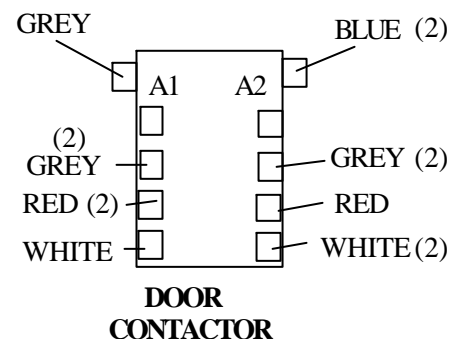
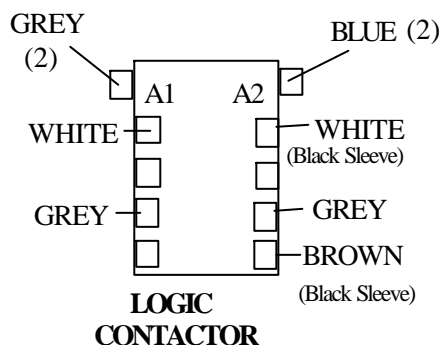
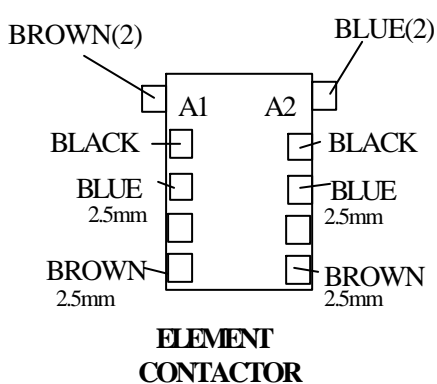
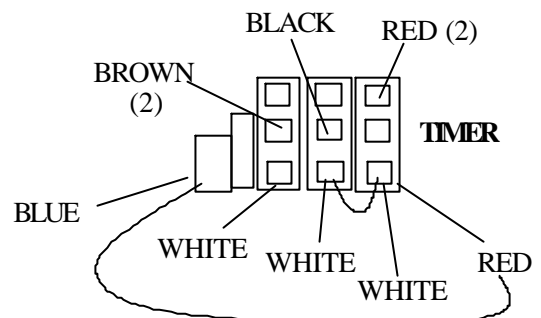

ECO 1 & 2 NEW LINE (Blue Top) GLASSWASHERS

TOP PANEL COMPONENT WIRING

December 2003 WO

ECO 1 & 2 NEW LINE

**NOTE:
NEW LINE M/C'S
with BLUE
PLASTIC TOP**

ELECTRICAL SCHEMATIC DIAGRAM

December 2003 WO

WO/TL

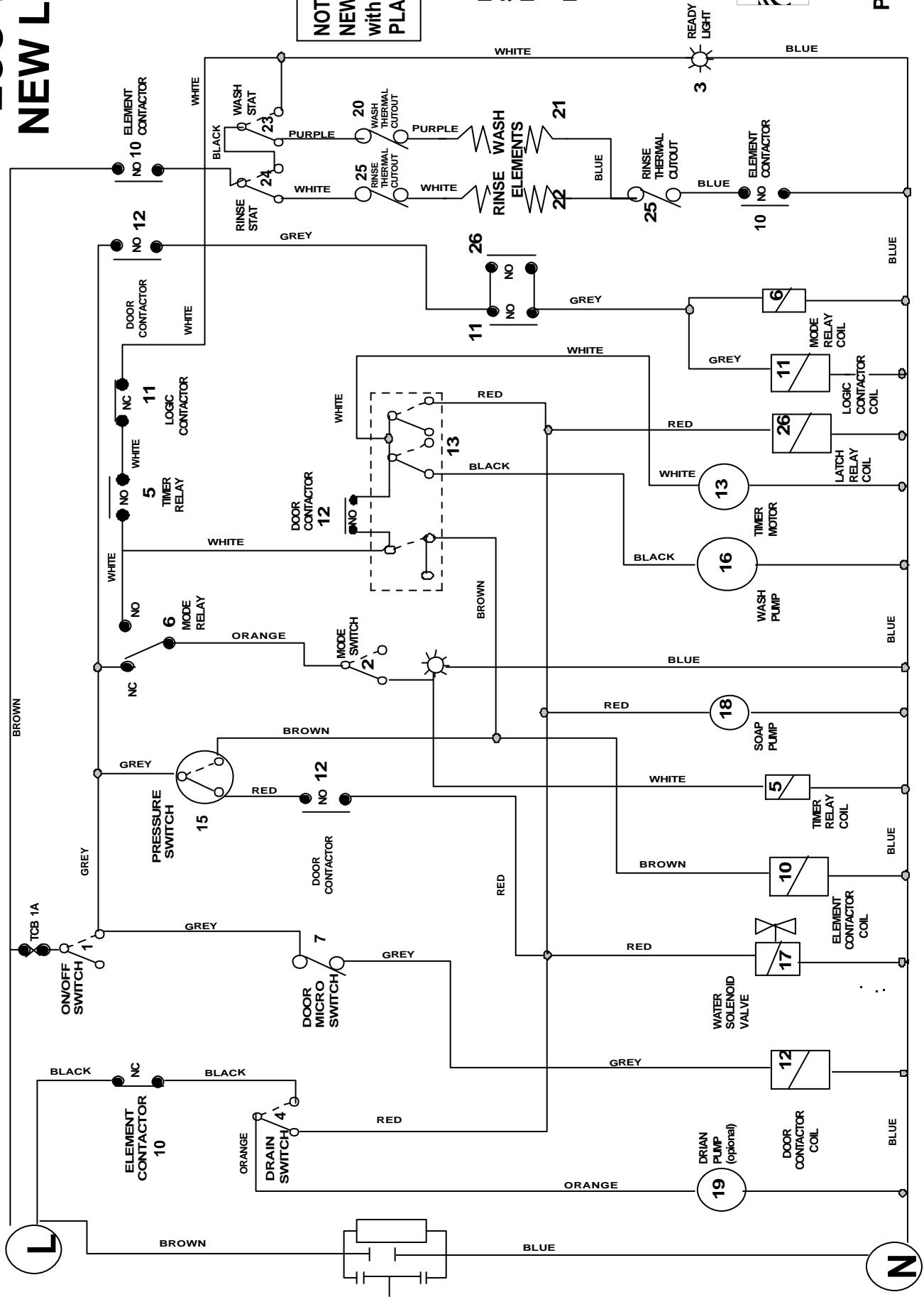



ELECTRICAL SCHEMATIC DIAGRAM
December 2003 WO1

CLASSIC GLASS & DISHWASHING SYSTEMS LTD

ECO 1 / 2 H500 NEW LINE MACHINES

HEATING INTERLOCK CIRCUIT

START AND WASH POSITION

1 of 2 Drawings

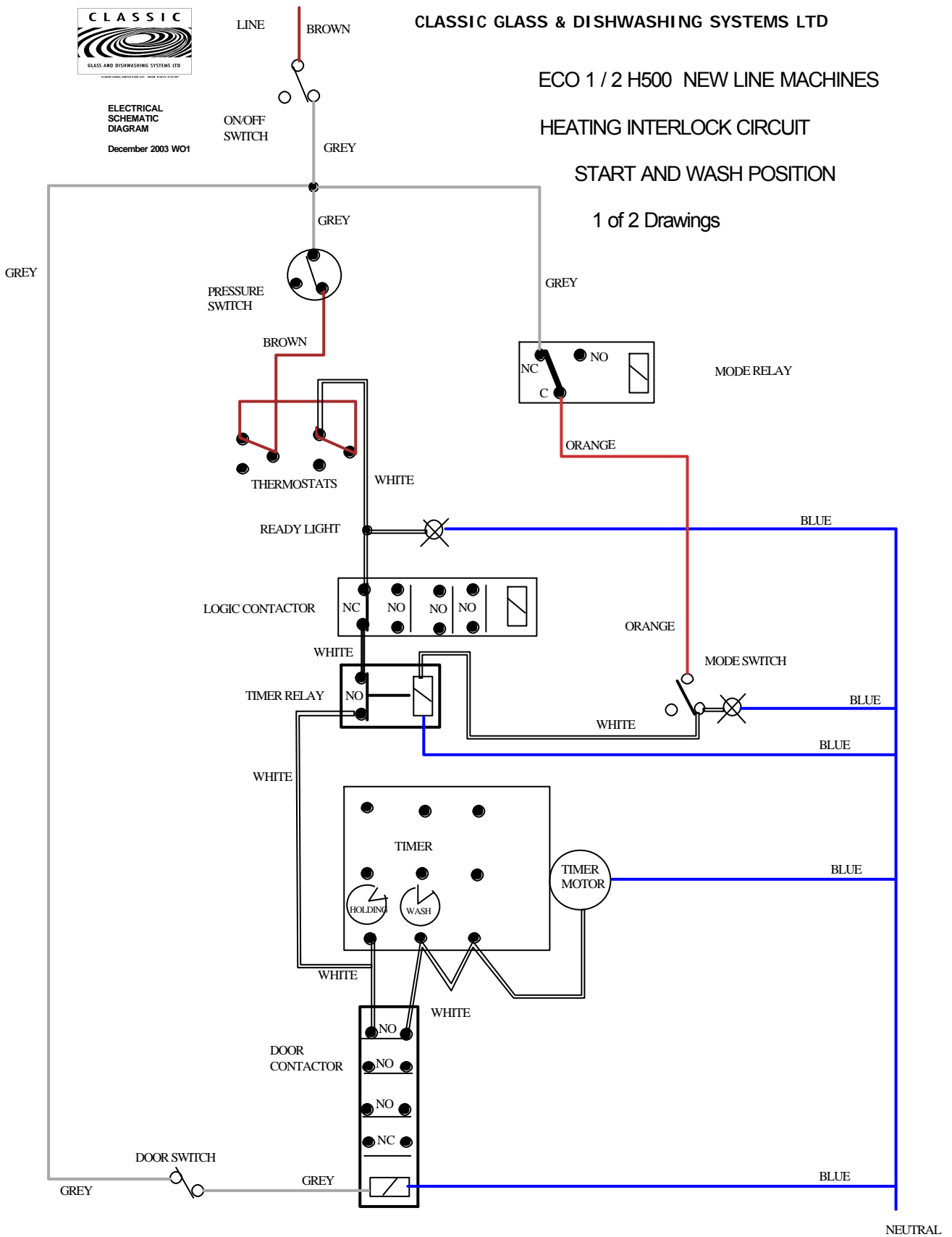



CLASSIC GLASS & DISHWASHING SYSTEMS LTD

ECO 1 / 2 H500 NEW LINE MACHINES

HEATING INTERLOCK CIRCUIT

CHANGEOVER & RINSE POSITION

2 of 2 Drawings

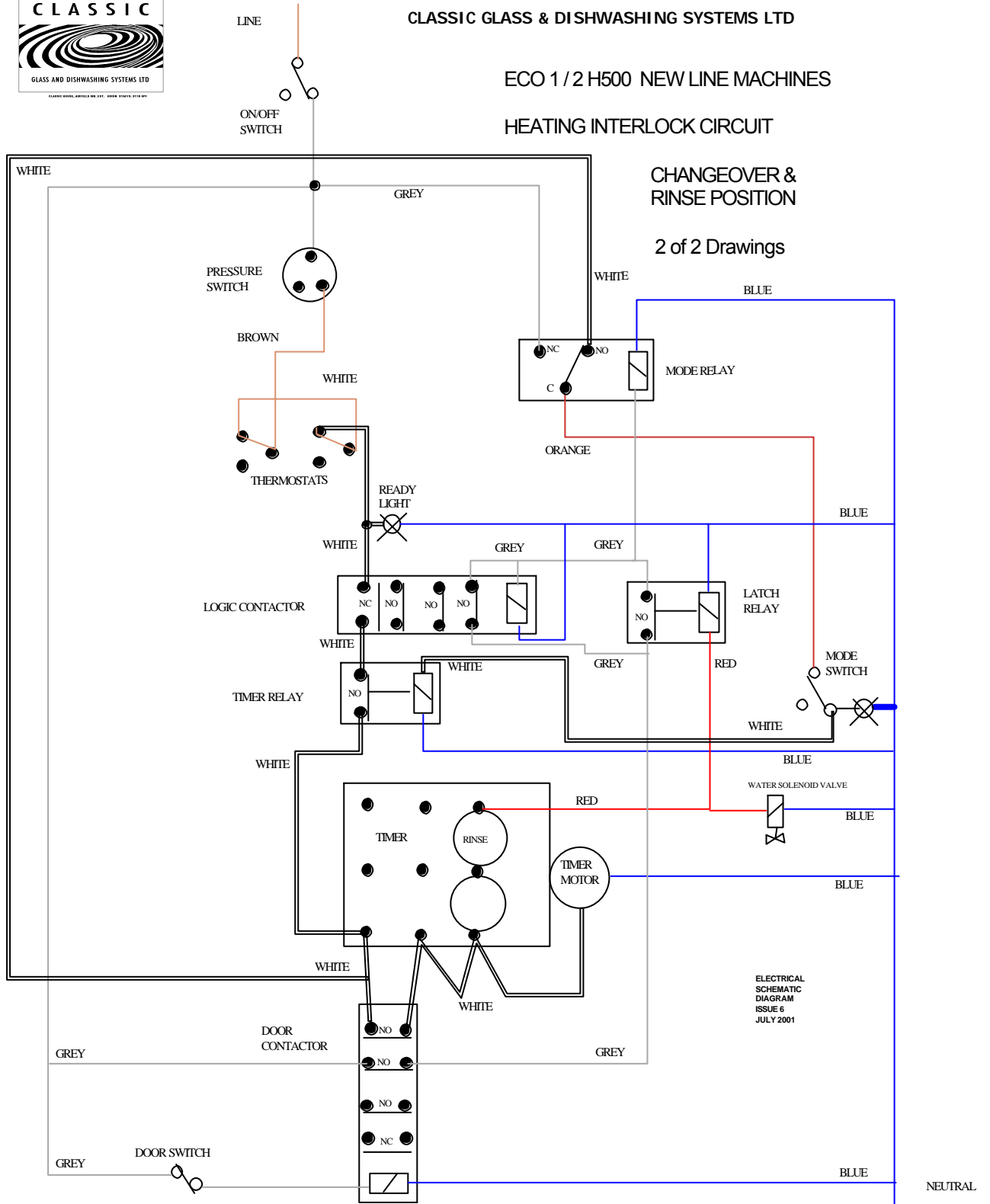

H 500 NEW LINE

NOTE:
NEW LINE M/Cs
with BLUE
PLASTIC TOP

ELECTRICAL SCHEMATIC DIAGRAM

December 2003 WO

WO/TL

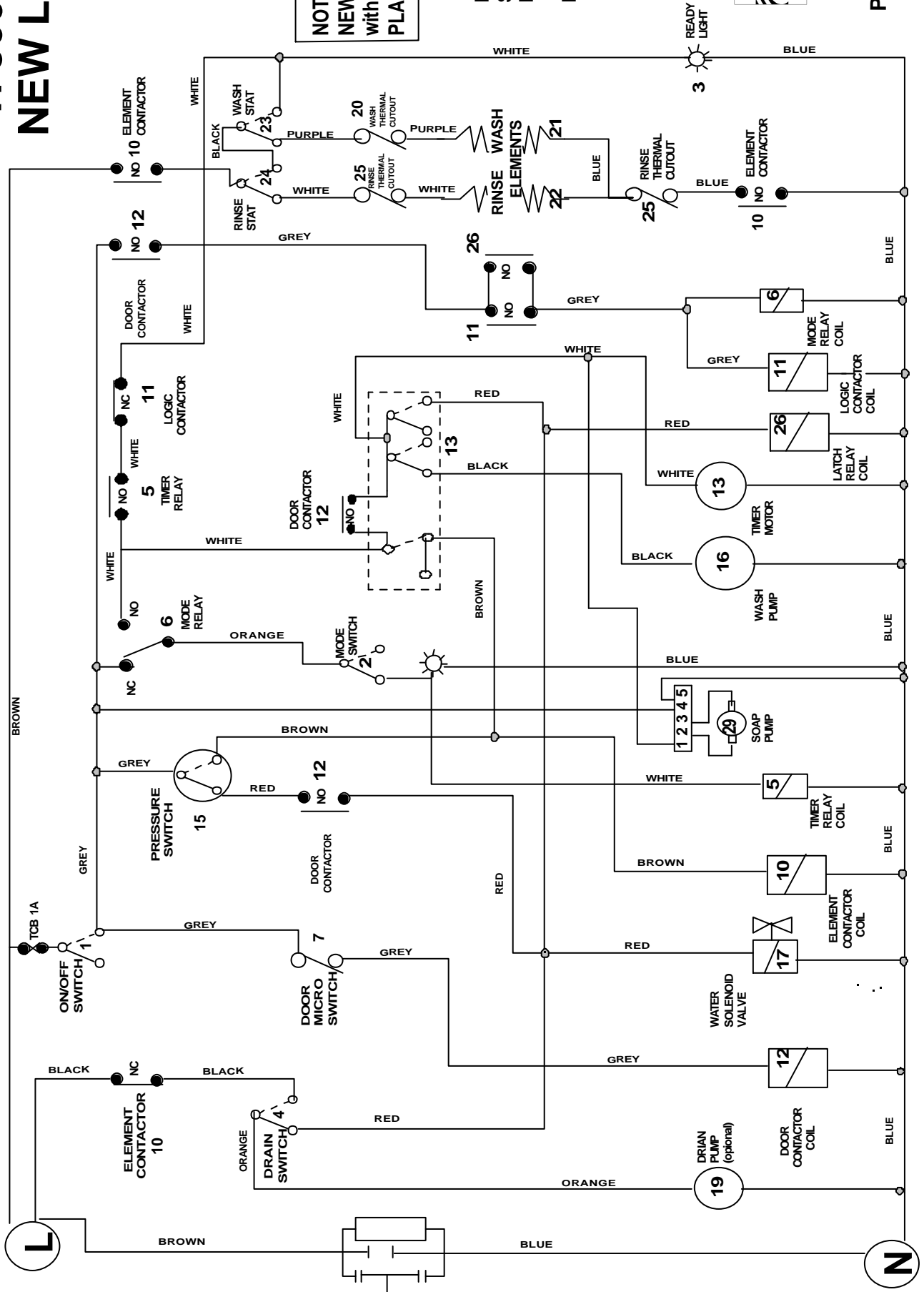



NEW LINE MACHINES

HEAT INTERLOCK

HOW TO REMOVE THE INTERLOCK

We have built in a modification which will allow the machine to start when the door is opened and closed, providing the mode switch is turned to the on (Auto) position.

1: Unplug the machine from the mains electric

2: Remove the top panel

3: Identify the 'LOGIC' contactor

eco1 eco2 H500

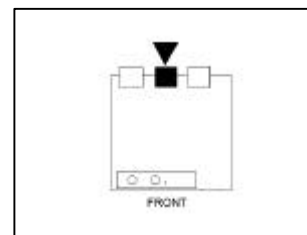

eco3 H750

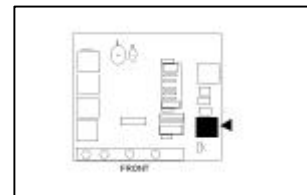

4: There are 2 cables with BLACK terminal sleeves
1 white cable & 1 brown cable.

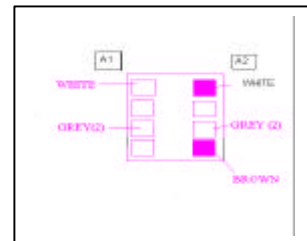

5: Change over these 2 cables (white & brown) with black sleeves

6: Reassemble the top and switch on.

7: Increase the RINSE TEMPERATURE to 85°c – this will delay the foaming problems due to low rinse temp.

Now when the machine is full of water it will operate when the door is opened and closed.

The customer should wait for the machine to heat up and ready light is on before first using.

CLASSIC will not cover warranty calls on results or foaming.

WO 3/2002



CIRCUIT DRAWINGS E1 - E2 - H5



CLASSIC HOUSE, AIRFIELD INDUSTRIAL ESTATE, HIXON , STAFFORDSHIRE ST18



December 2003 WO

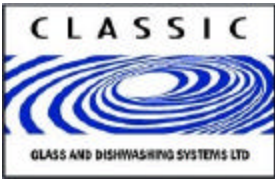

CLASSIC GLASS & DISHWASHING SYSTEMS LTD
 E 1 & E 2 24 GLASSWASHERS - 24 Volt GLASSWASHERS
 ELECTRICAL SPARE PARTS

All electrical items on this page are 24 volts
 MOTORS — CONTACTOR /RELAY COILS — SWITCHES—WATER VALVE

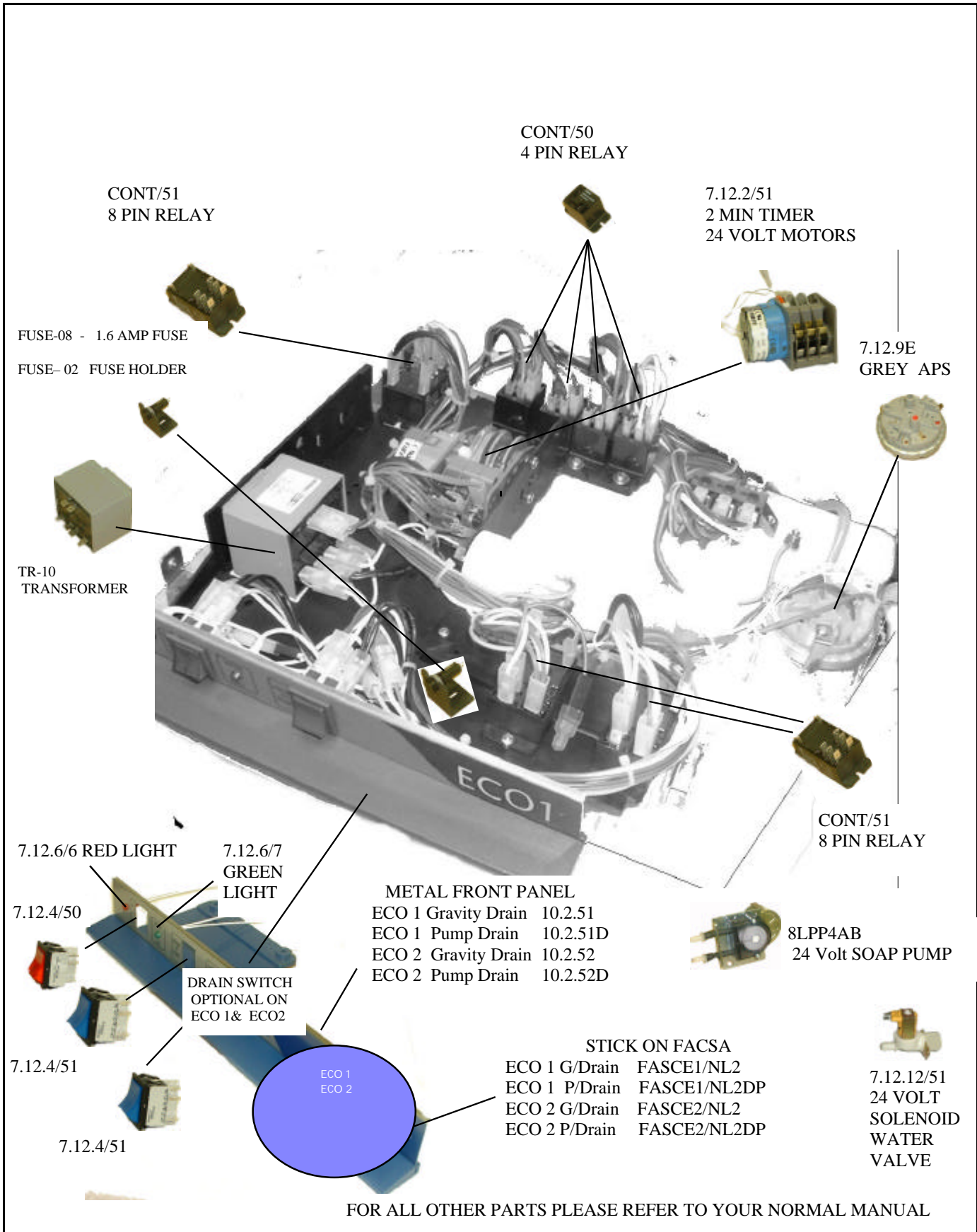

FOR ALL OTHER PARTS PLEASE REFER TO YOUR NORMAL MANUAL



NEW TYPE TRANSFORMER FOR UNDERCOUNTER MACHINE

INTRODUCED WEEK 45 2003

PART NO

TR-10



E1 & E2 GLASSWASHERS

2 WHITE cables from neon lights

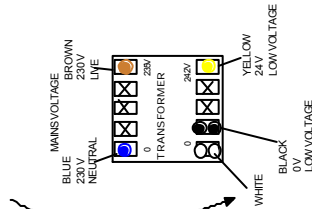

ECO 1- ECO2 (E1) (E2)

Part No:CONT51A

DOUBLE CHANGEOVER RELAY

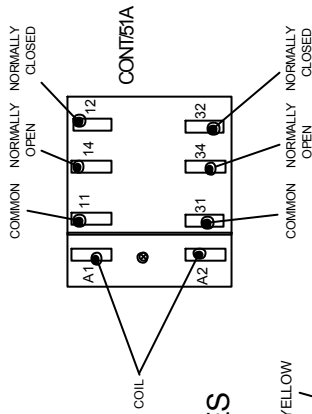

NEW CLEAR RELAY FITTED TO MACHINES From November 2003

LATCH RELAY

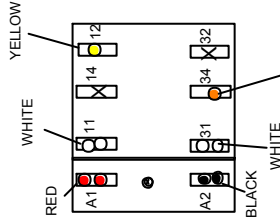

DOOR RELAY

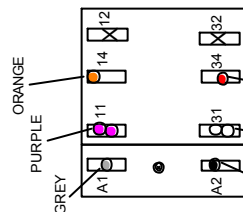

CYCLE RELAY

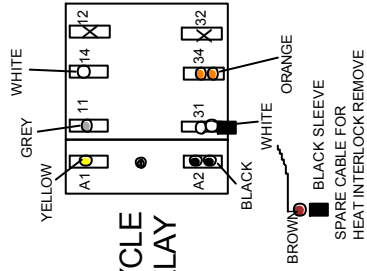

FITTING RINSE BOOSTER PUMP To 24volt Classic Machine

THESE CABLES ARE INSIDE THE LOWER PANEL OF THE MACHINE TO THE RIGHT HAND SIDE CABLE TIED TO THE LOOM

THE RELAY SHOULD REST ON THE SIDE RAIL NEAR THE SOAP PUMP.



SINGLE POLE RELAY CONT/50A

WASH PUMP RELAY
 BLACK WITH BLACK SLEEVE (Terminal 11), BLACK (Terminal 14), BROWN (Terminal 14), BLACK WITH BLACK SLEEVE (Terminal 14)

WASH ELEMENT RELAY
 PURPLE WITH BLACK SLEEVE (Terminal 11), PURPLE 2.5mm (Terminal 21), PURPLE 2.5mm (Terminal 22), BLACK (Terminal 14)

DRAIN PUMP RELAY (if fitted)
 ORANGE WITH BLACK SLEEVE (Terminal 11), ORANGE (Terminal 14), BLACK (Terminal 14)

RINSE ELEMENT RELAY
 WHITE WITH BLACK SLEEVE (Terminal 11), WHITE 2.5mm (Terminal 21), WHITE 2.5mm (Terminal 22), BLACK (Terminal 14)

If replacing an old 'BLACK' type relay we supply terminals and cover sleeves.
 Note: YOU MUST FIT THESE TERMINALS WITH PROFESSIONAL CRIMP PLIERS

E1-E2 24V COMPONENT WIRING Prior To Serial No ???348



FRONT OF MACHINE

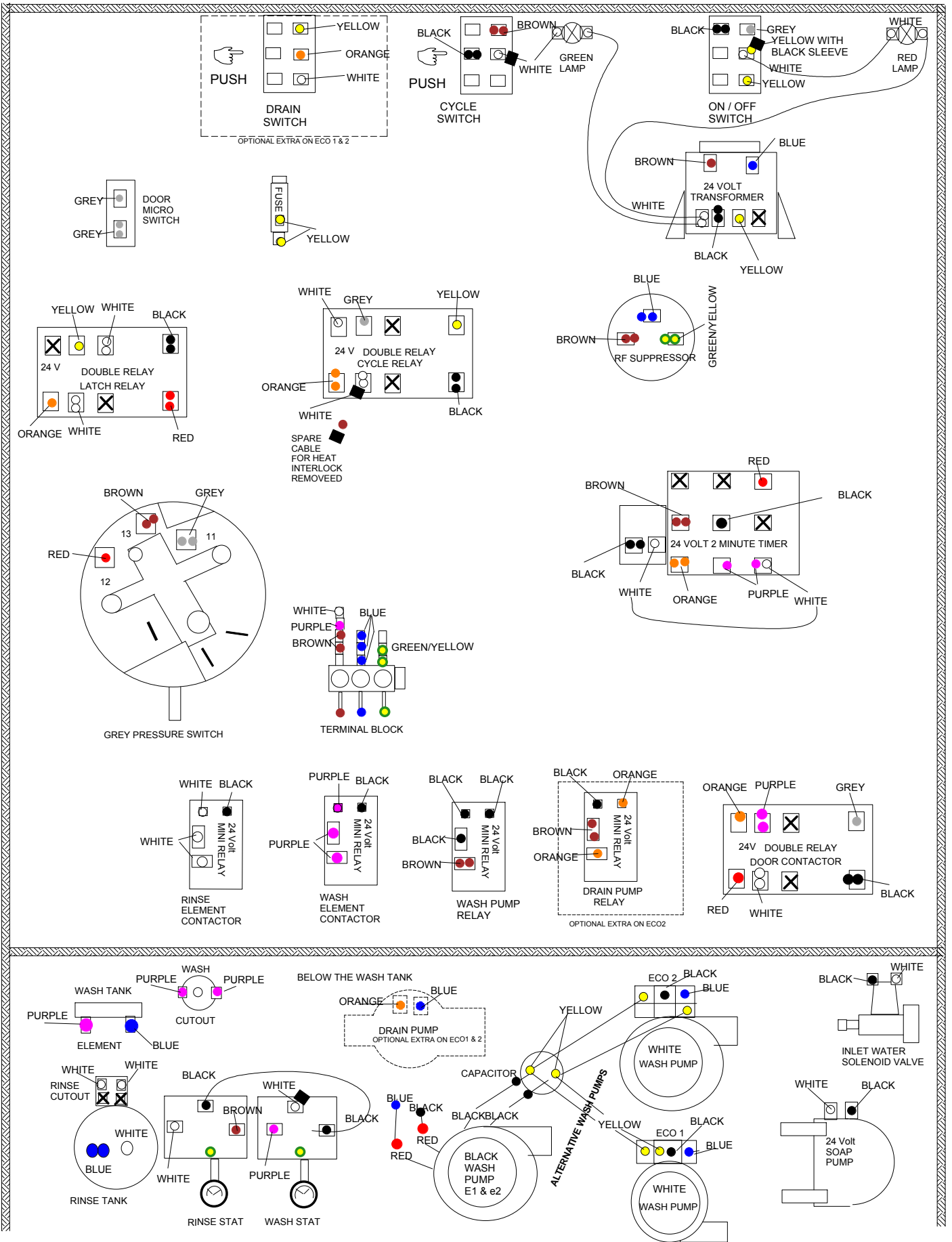

CHANGE WIRING ON RELAYS E1 / E2 After Serial No. ???348

FRONT OF MACHINE

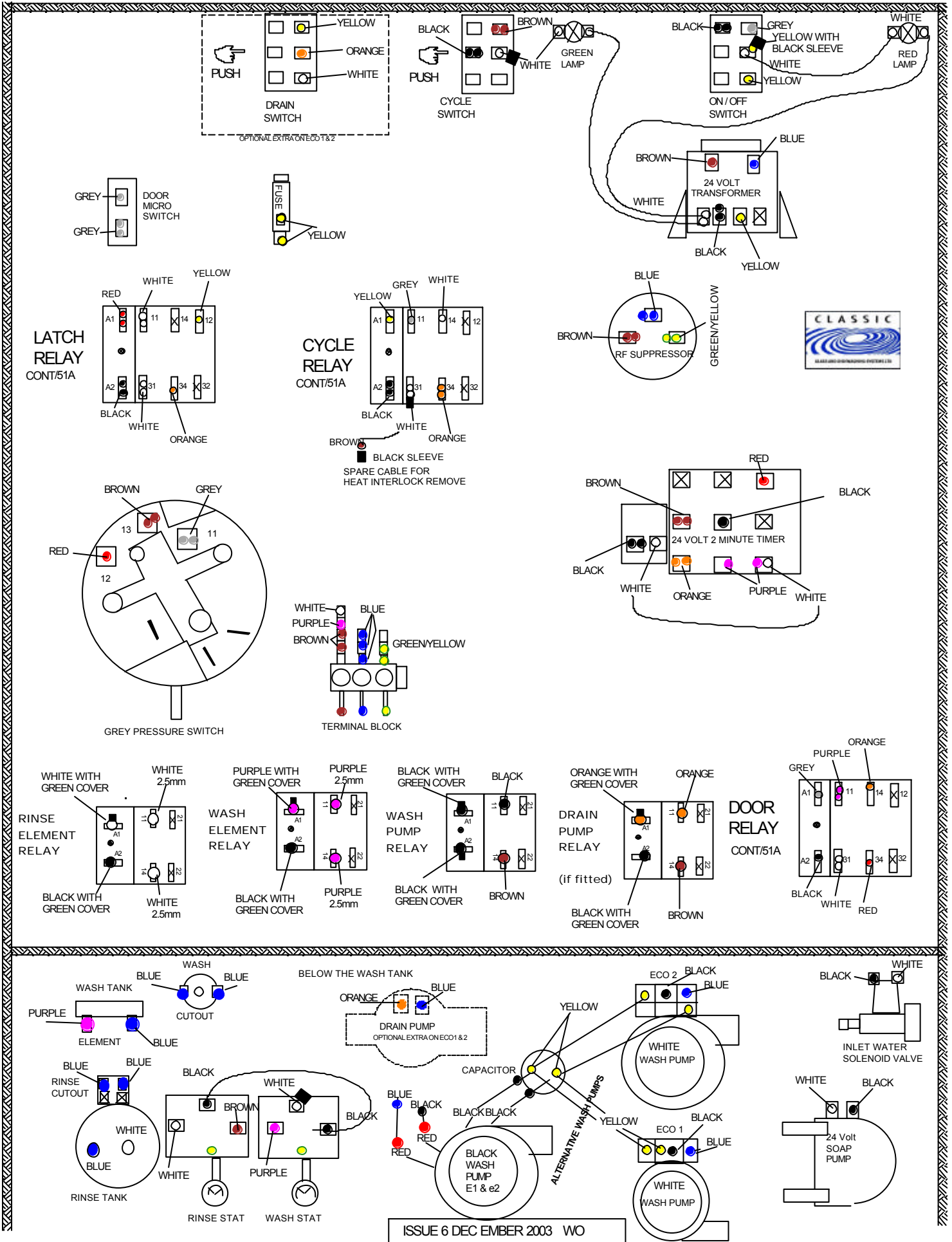

CLASSIC 24 - ECO1 & ECO2 GLASSWASHER

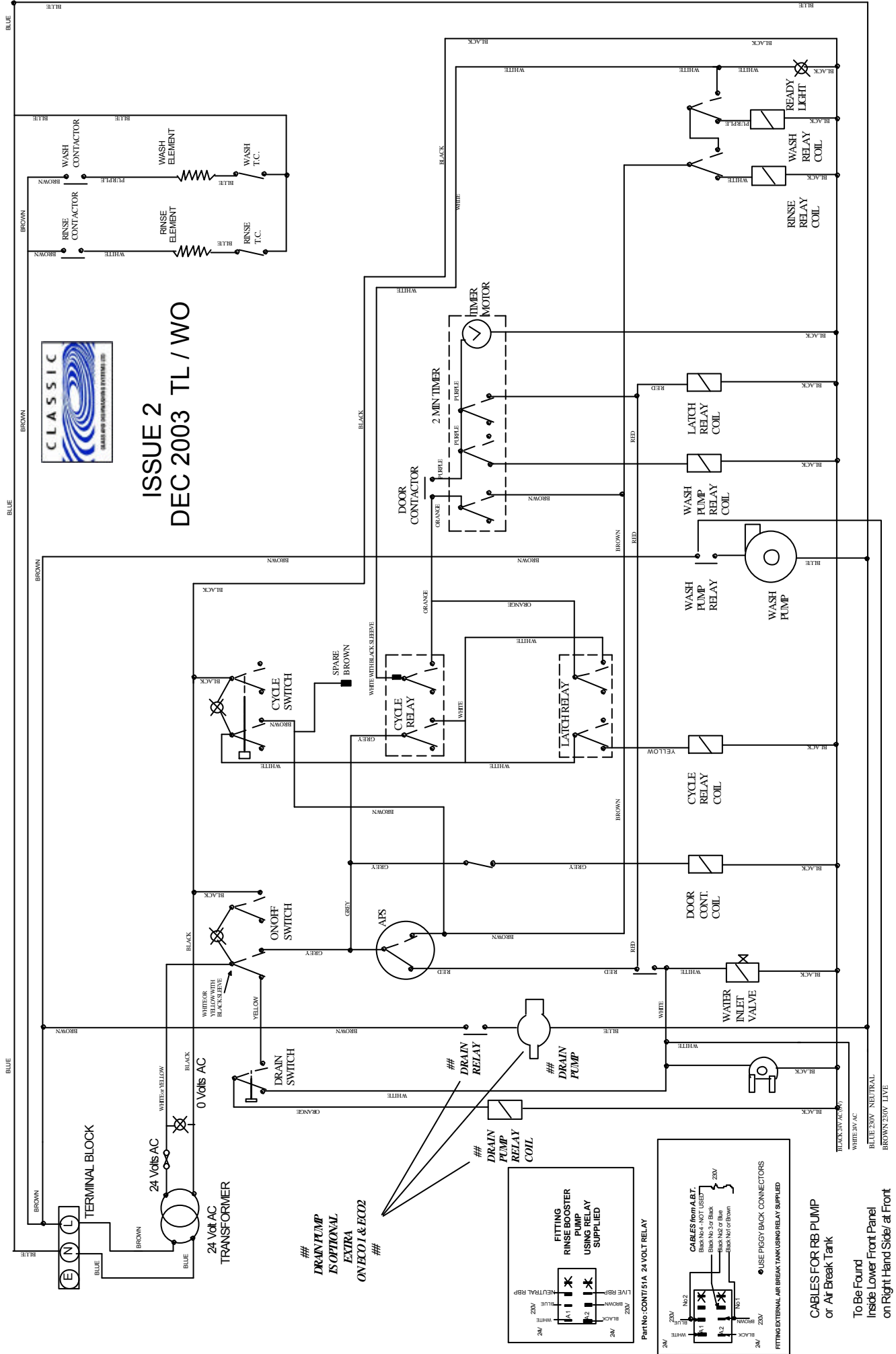

H5 24V COMPONENT WIRING PRIOR TO Serial No ??? 350



FRONT OF MACHINE

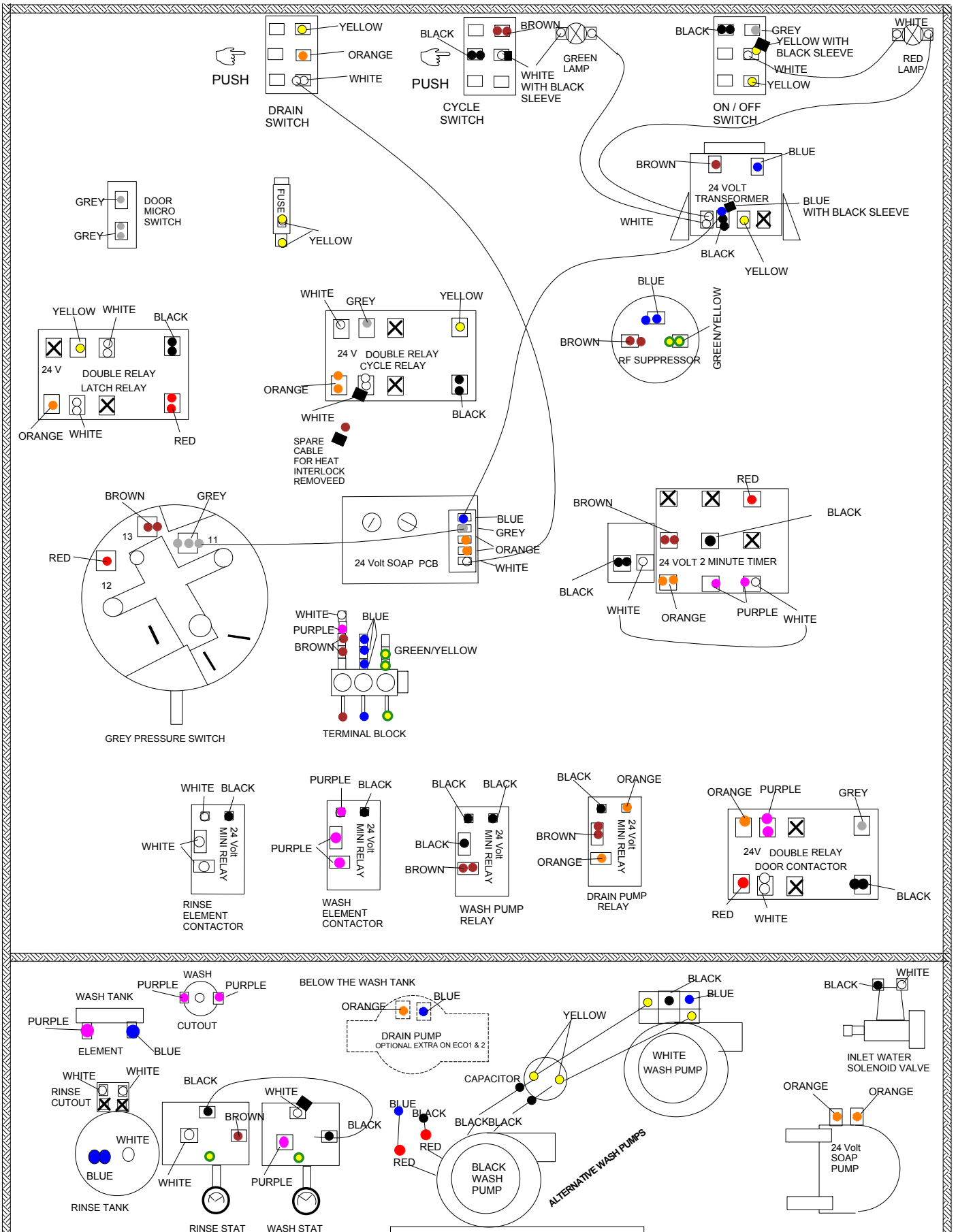

December 2003 WO

H5 DISHWASHER

(PART NUMBER IN BRACKETS ()

DECEMBER 2003 WO

LAYOUT OF ELECTRICAL PARTS
LM-H5- REVISION E
DRAWING BY TL



FROM SERIAL No ???-350

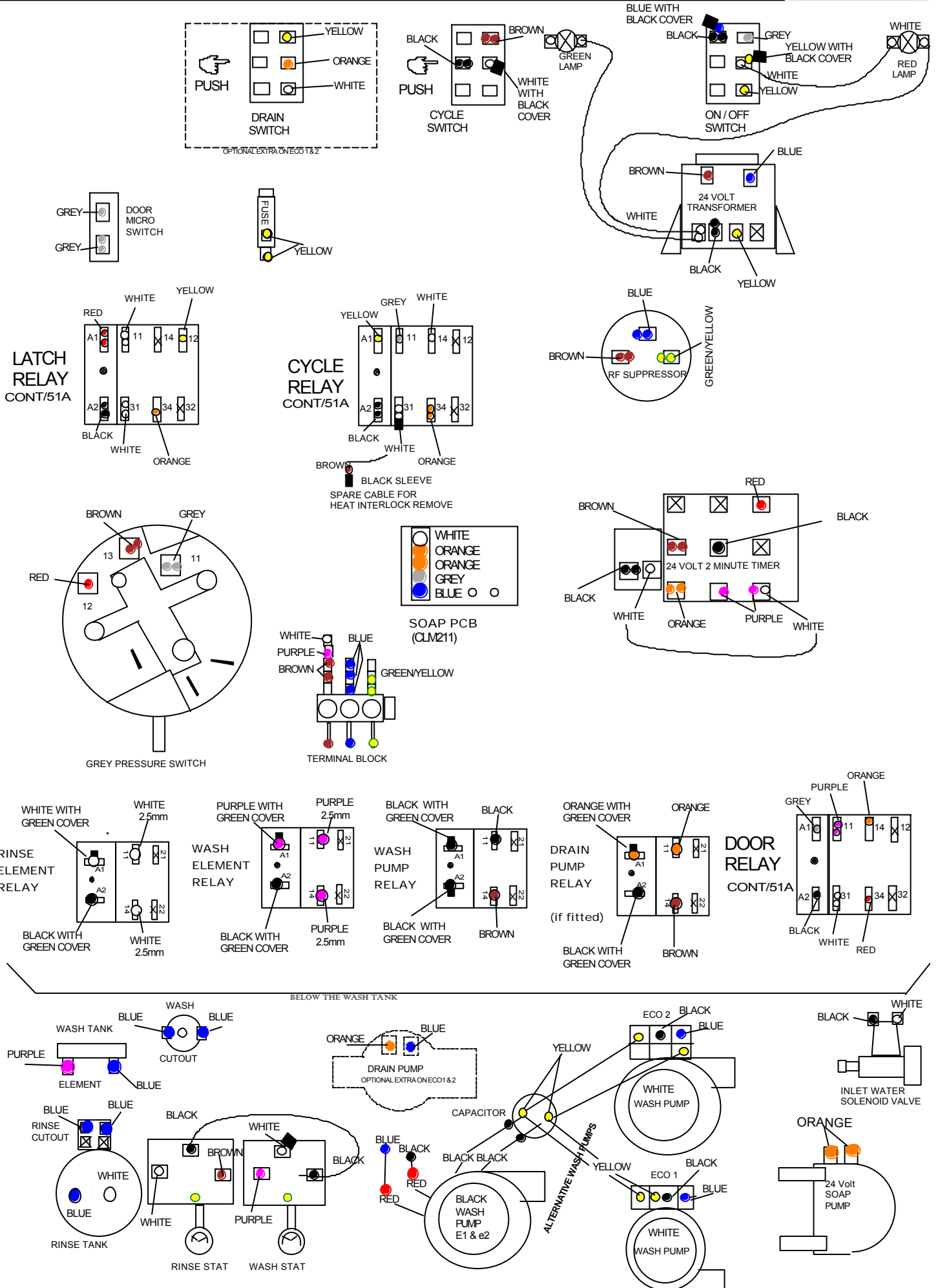

BELOW THE WASH TANK

CLASSIC 24 - H5 DISHWASHER

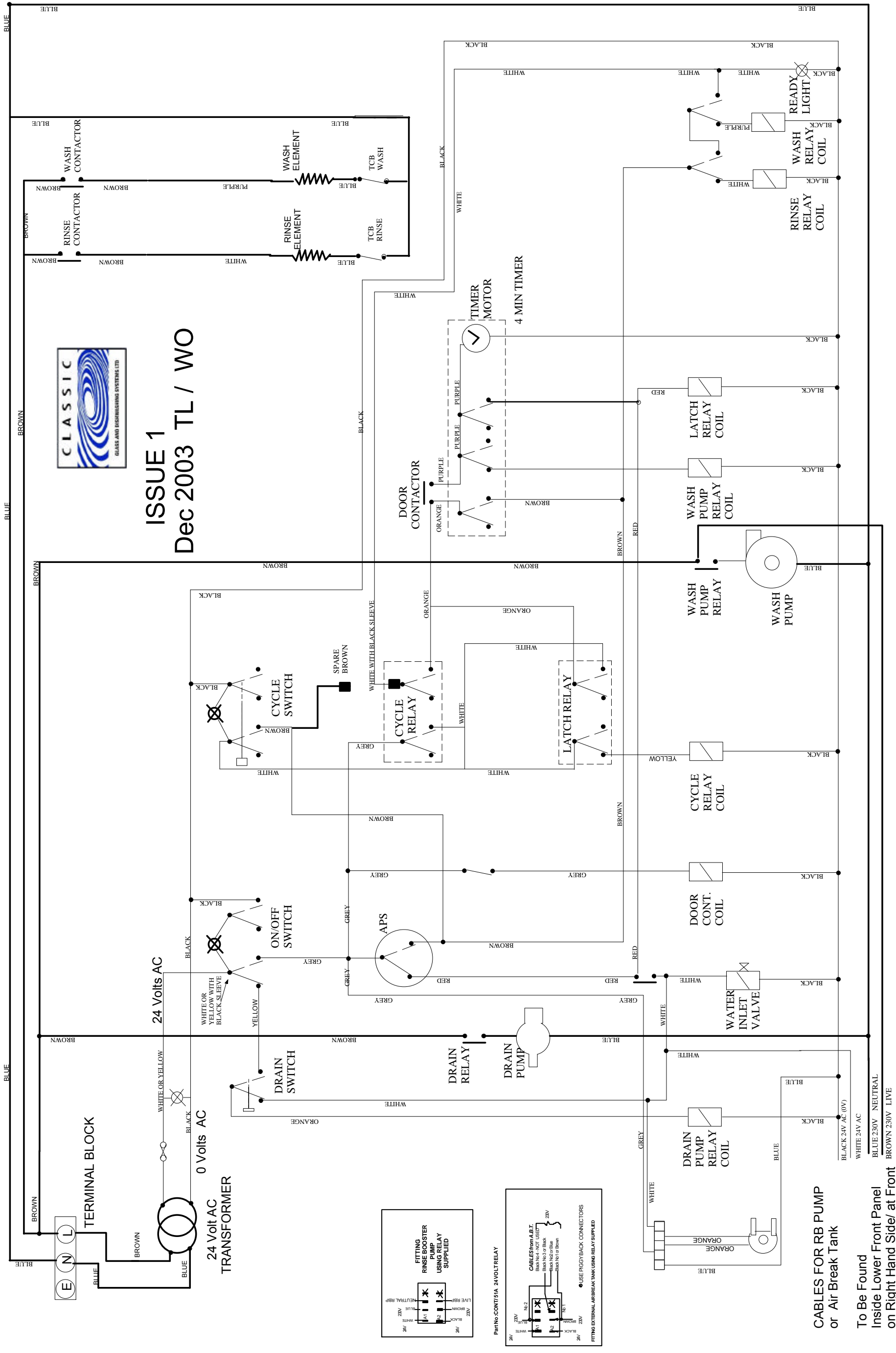

ISSUE 1
Dec 2003 TL / WO

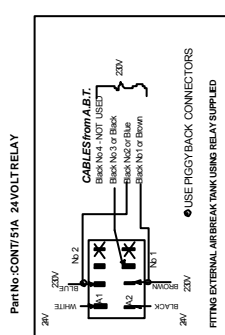
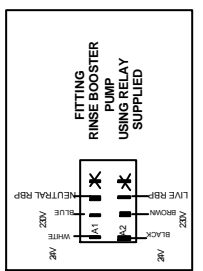

CABLES FOR RB PUMP or Air Break Tank

To Be Found
Inside Lower Front Panel
on Right Hand Side/ at Front

- BLACK 24V AC (0V)
- WHITE 24V AC
- BLUE 230V NEUTRAL
- BROWN 230V LIVE



H5 DISHWASHER

NEW TYPE TRANSFORMER FOR UNDERCOUNTER MACHINE
INTRODUCED WEEK 45 2003

PART NO

TR-10



H5 DISHWASHER

This is interchangeable with the old type Transformer connect as below the only change is

The BLUE CABLE with BLACK SLEEVE

is now 'piggy' backed onto BLACK CABLE on the

ON/OFF Switch

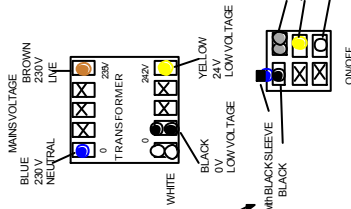

Part No:CONT/51A



DOUBLE CHANGEOVER RELAY

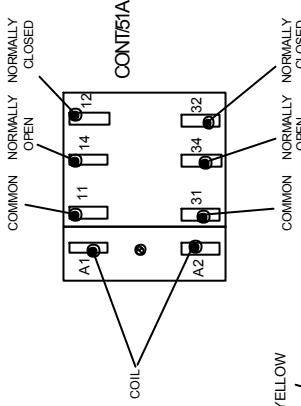

NEW CLEAR RELAY
FITTED TO MACHINES
From November 2003

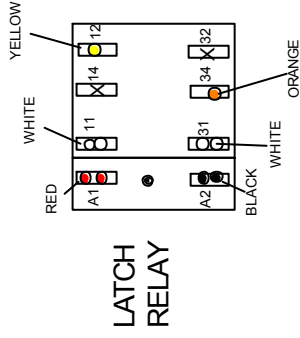

LATCH RELAY

DOOR RELAY

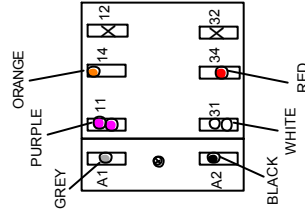

FITTING RINSE BOOSTER PUMP To 24volt Classic Machine

WIRING DIAGRAM FOR RINSE BOOSTER PUMP:

- BROWN (240 volt): LIVE FROM RINSE PUMP
- RED (24 volt): CABLES IN THE LOOM
- BLACK (24 volt): CABLES IN THE LOOM
- BLUE (240 volt): NEUTRAL FROM RINSE PUMP

RELAY CONNECTIONS:

- RED: A1
- BLACK: A2
- RED: 11
- BLACK: 12
- ORANGE: 14
- ORANGE: 15
- BLACK: 31
- BLUE: 32
- ORANGE: 34
- ORANGE: 35

NOTE: THESE CABLES ARE INSIDE THE LOWER PANEL OF THE MACHINE TO THE RIGHT HAND SIDE CABLE TIED TO THE LOOM

NOTE: THE RELAY SHOULD REST ON THE SIDE RAIL NEAR THE SOAP PUMP.

SINGLE POLE RELAY
CONT/50A

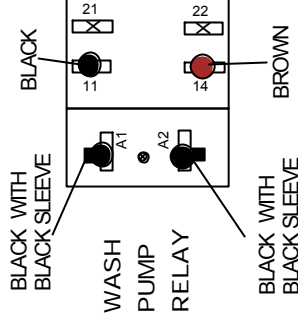
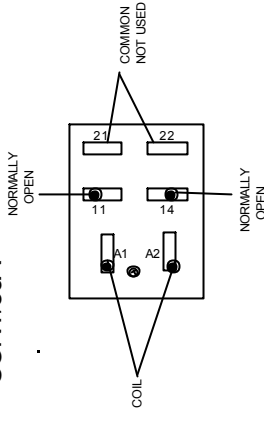

WASH PUMP RELAY

WASH ELEMENT RELAY

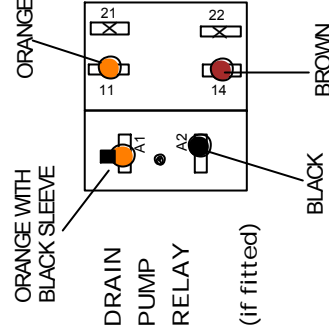
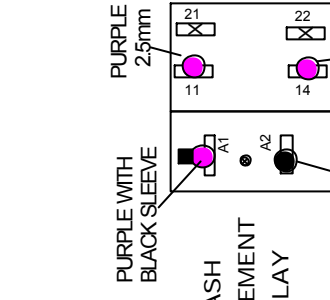

DRAIN PUMP RELAY (if fitted)

CYCLE RELAY

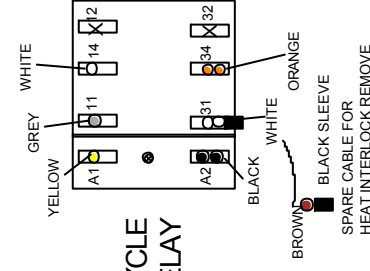

FITTING RINSE BOOSTER PUMP To 24volt Classic Machine



If replacing an old 'BLACK' type relay we supply terminals and cover sleeves.
Note: YOU MUST FIT THESE TERMINALS WITH PROFESSIONAL CRIMP PLIERS

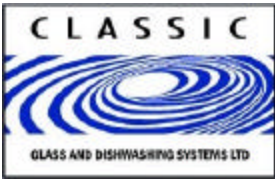

CLASSIC GLASS & DISHWASHING SYSTEMS LTD
 H5 DISHWASHER - 24 Volt DISHWASHER
 ELECTRICAL SPARE PARTS

All electrical items on this page are 24 volts
 MOTORS — CONTACTOR /RELAY COILS — SWITCHES—WATER VALVE

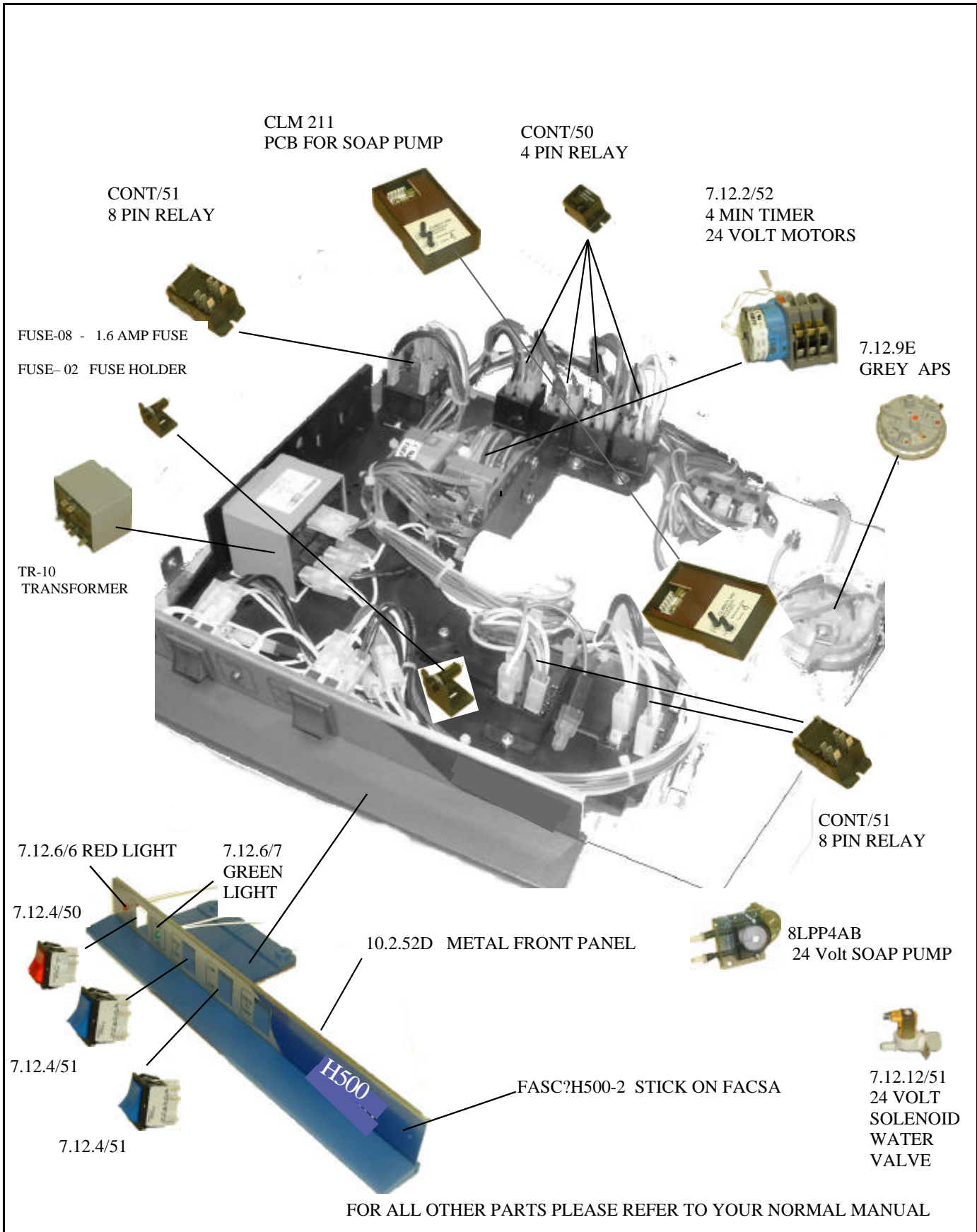

FOR ALL OTHER PARTS PLEASE REFER TO YOUR NORMAL MANUAL

CLASSIC 24 RANGES OF GLASS & DISHWASHERS

The first 3 pages are for training and identifying the interlock circuit.

Page 1 Select Position

Where you select a cycle by pressing the cycle switch.
The switch will illuminate but will not start until the machine is up to temperature
EXCEPT H7 with '4 MIN' selected
All machines with Heat interlock removed.

Page 2 Start Position

The machine is up to temperature and the cycle will start (Orange cable to timer)
We have detailed the '2/4 MIN' switch, which indicates either a signal from the thermostats (White Cable) or constant power (Brown Cable)

Page 3 Changeover Position

When the machine starts to rinse a signal from the timer (RED Cable) changes the circuit so that when the cycle is completed the machine will stop and you have to select a cycle again to start the machine

Page 4 Fault Finding – Help on possible faults, which may occur

REMOVING HEAT INTERLOCK – if necessary?

IDENTIFY

On the 'CYCLE RELAY' (inner relay of two) there is a WHITE cable with a 'Black' terminal sleeve, and floating BROWN cable with a Black sleeve

Change the cables over so the BROWN cable is on the Relay and the white cable floating.

Put the clear rubber cover from the BROWN over the end of the WHITE cable for safety.

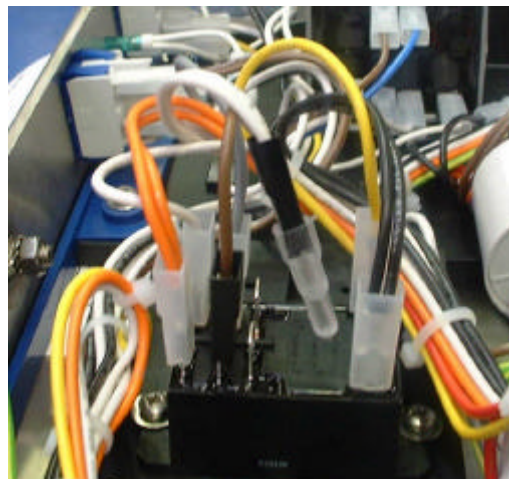

INTERLOCK CIRCUITS FOR E1 E2 E3 H5 H7

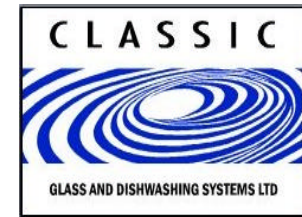

1 → 2 → 3

SELECT POSITION

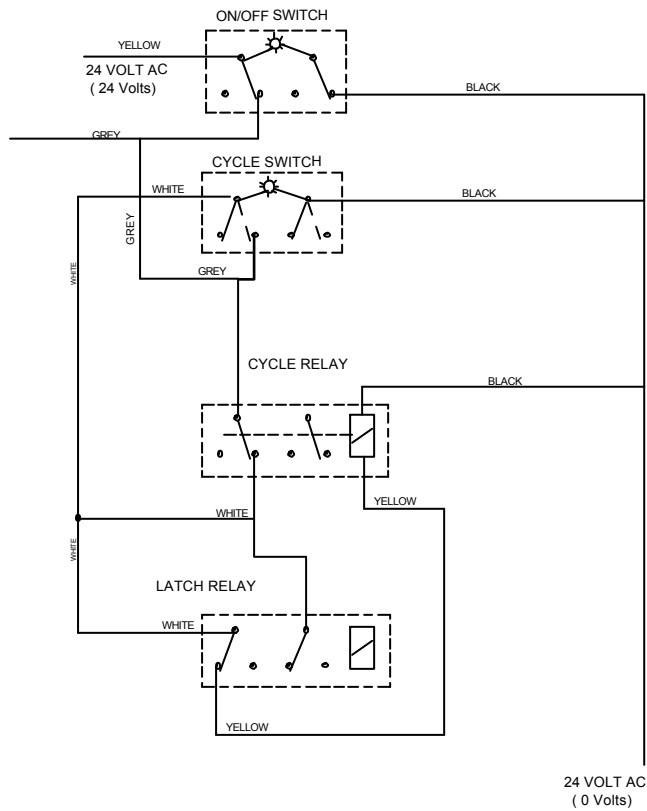

START POSITION

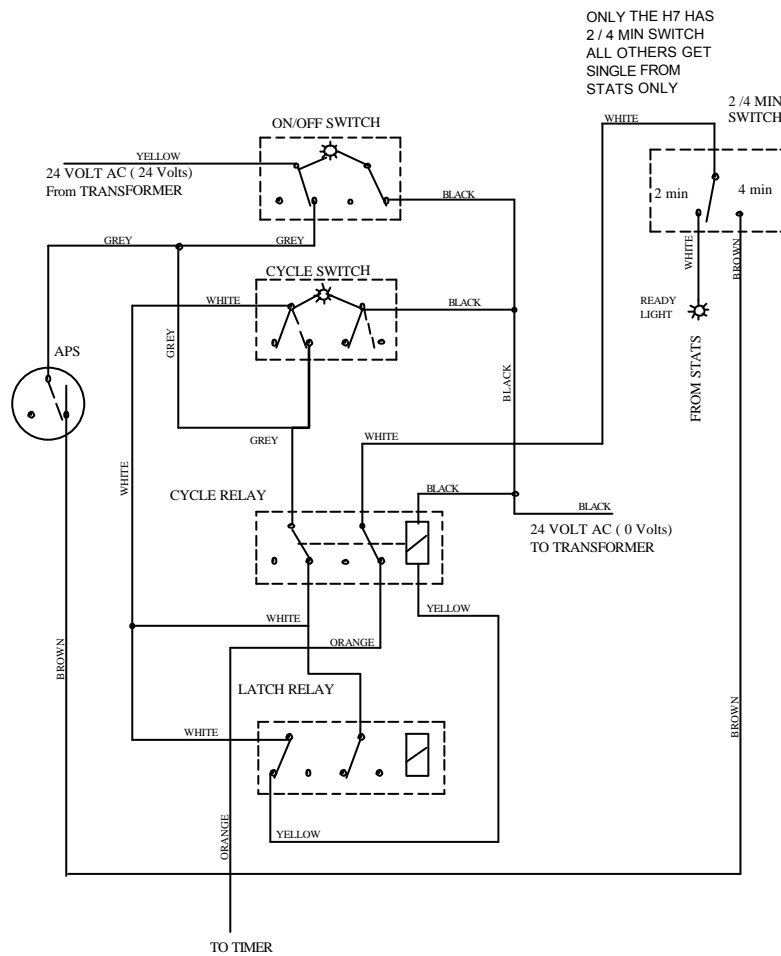

CHANGEOVER POSITION

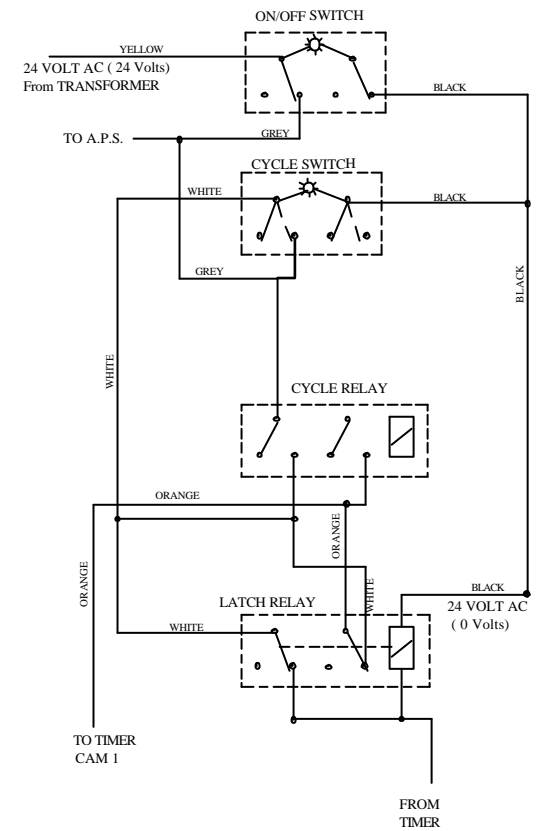

<u>SYMPTOMS</u>	<u>FAULT</u>
<u>POWER AND SERVICES</u>	
Red Light next to On/Off Switch Not on	A: Not switched on at Wall
Red Light next to On/Off Switch Not on	B: Fuse Open Circuit in Plug or Fuse Box
Red Light next to On/Off Switch Not on	C: Fuse (1.6 amp)/Open Circuit in Machine
Will not stop Filling (ECO3 H750) - DURING INSTALATION	Waste hose Below water level
<u>FILLING</u>	
Will Not Fill with water	Faulty On/Off Switch
Will Not Fill with Water	Faulty Pressure Switch
Will Not Fill with Water	Faulty Water Inlet Solenoid Valve
Will Not Fill With water	Water turned off at Mains or Tap or Water Softener
Will not stop filling - all models	Air Trap- Leaking Air or Broken or twisted or Blocked
Will not stop filling - all models	Air Trap to pressure Switch - Off or Leaking Air
Will not stop filling - all models	Pressure Switch Faulty
Will not stop filling - all models	Inlet Solenoid Valve Faulty
Will not Stop Filling (ECO1 ECO2 H500 H800)	Drain Plug Not in Drain Hole
<u>HEATING</u>	
Will not Stop Heating Rinse Tank (after resetting thermal trip) Thermostat will not switch off	Thermostat Faulty
Will not Stop Heating Rinse Tank (after resetting thermal trip) Thermostat WILL switch off	Rinse Contactor Close Circuit
Will not Stop Heating Wash Tank (after resetting thermal trip) Thermostat will not switch off	Thermostat Faulty
Will not Stop Heating Wash Tank (after resetting thermal trip) Thermostat WILL switch off	Wash Contactor Close Circuit
Heating - NO Water in Wash Tank (after resetting Wash Tank Thermal Trip)	Air pressure Switch Faulty
Not Heating Either Tank (full of water and not still filling)	Rinse Thermal Cut-out Tripped Out(resetable)
Not Heating Either Tank (full of water and not still filling)	Burnt of Cable
Not Heating Either Tank (full of water and not still filling)	Element Open Circuit
Not Heating Rinse Tank (full of water and not still filling)	Rinse Contactor Open Circuit
Not Heating Wash Tank (full of water and not still filling)	Wash Contactor Open Circuit
Not Heating Wash Tank (full of water and not still filling)	Wash Thermal Cut-out Tripped out (resetable)
Not Heating Wash Tank (full of water and not still filling)	Burnt Cable
Not Heating Wash Tank (full of water and not still filling)	Element Open Circuit
<u>WASHING</u>	
Restarts the cycle Ready light goes out during in Rinse but comes back on during Wash	Latch Relay – Orange to White Closed Circuit
Restarts the cycle without pressing the cycle switch(if ready light is on) or (Interlock is removed)	Latch Relay – coil Open Circuit
Restarts the cycle without pressing the cycle switch(if ready light is on) or (Interlock is removed)	Cycle Switch – Grey to White Closed Circuit
Wash as normal –Completes cycle but will not rinse	Door Relay – Red to White Closed Circuit
Washes 2 cycles then starts to Fill/Rinse (H750 or ECO3 ONLY) may refill or fill & Syphon water	Waste Hose - too low or no air break or push down in stand pipe
Washes as Normal BUT Cycle light goes out during rinse	Latch Relay - Orange to White Open Circuit
Washes as normal BUT Cycle Light will not stay no during wash BUT will during in Rinse	Cycle Relay – Grey to white Open Circuit
Washes as Normal BUT Drain Pump will not run during in Rinse	Door Relay – Red to White Open Circuit
Washes as normal on first cycle then washes second cycle NO light in cycle switch but comes on during rinse	Cycle Relay – Orange to White Closed Circuit
Will Not Start but Ready Light on & Cycle Light On	Cycle Relay – Orange to White Open Circuit
Will Not Start Cycle BUT Cycle Light on when cycle is requested- light stays on	Door Relay – Orange to purple Open Circuit
Will Not Start Cycle BUT Cycle Light on when pressed – goes out when released	Cycle Relay - coil Open Circuit
Will Not Start Cycle BUT Cycle Light on when pressed – goes out when released	Latch Relay – Yellow to White Open Circuit
<u>WASH PUMP</u>	
WASH PUMP will NOT stop running	Wash pump Contactor Closed Circuit
Cycle Starts But Wash PUMP Will NOT run	Wash Pump Relay Open Circuit
Cycle Starts But Wash PUMP Will NOT run	Wash Pump or Capacitor Faulty
<u>DRAIN PUMP</u>	
Drain PUMP will NOT Stop running	Drain Pump Contactor Closed Circuit
Drain Pump Will Not Run	Blocked
Washes as Normal BUT Drain Pump will not run during in Rinse	Door Relay – Red to White Open Circuit

CLASSIC GLASS & DISHWASHING SYSTEMS LTD

FITTING NEW RINSE BOOSTER PUMP TO CLASSIC 24 MACHINES 24volt control

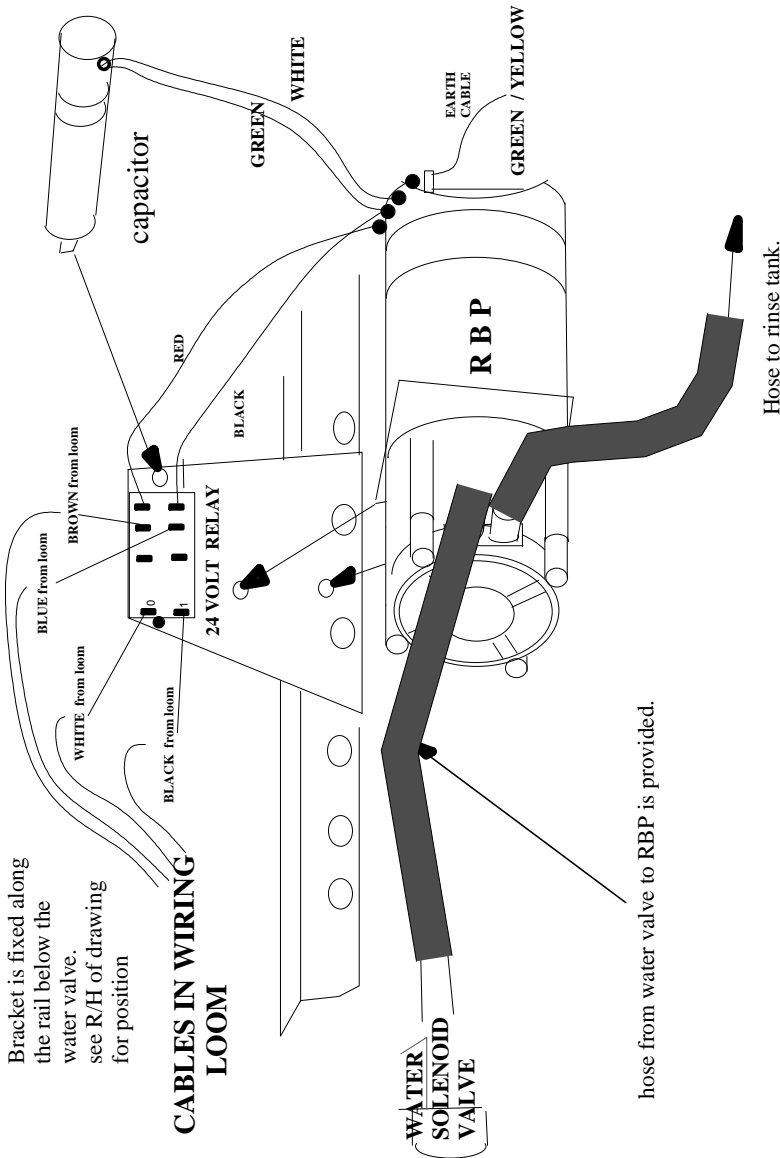

THIS PUMP MUST BE CONNECTED TO EARTH

RBP5A24

PART NUMBER
This kit contains
RBP5 RINSE BOOSTER PUMP
7.6.6/30 BRACKET
10 mm NUT & BOLT x 4
WASHER & STAR WASHERS
CONT/51 24 VOLT 8 PIN RELAY
7.8.20 HOSE
7.4.12/1 HOSE CLIP X 2

ELECTRICAL CONNECTIONS

8 PIN RELAY

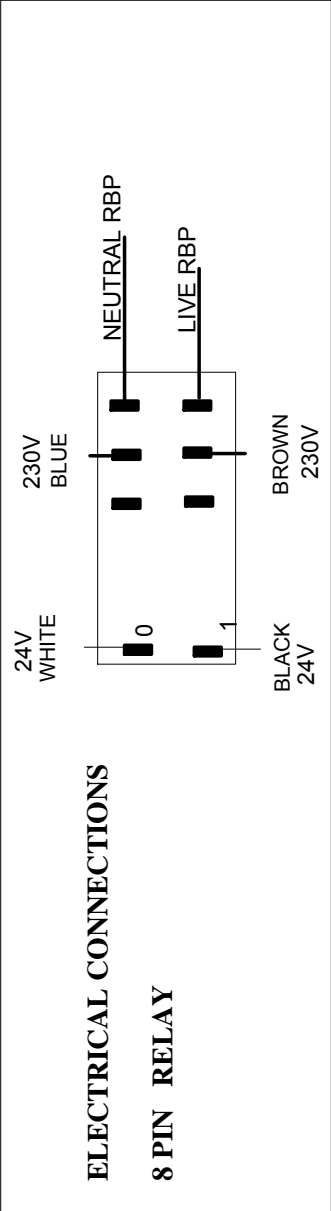

HOLE FIXINGS

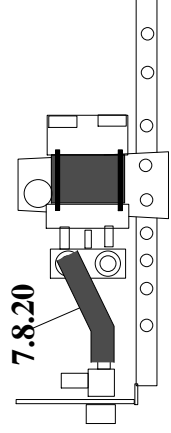

The RBP5 kit of parts are bolted to the bracket when it is despatched, you only have to fit the assembly to the machine connect up the hoses and electrical connections.