

HOBART

SCB Super Char Broiler.



SPARE PARTS MANUAL

SCB25CE
SCB36CE
SCB47CE
SCB60CE
SCB72CE

THIS MANUAL IS APPLICABLE FOR SCB SUPER CHAR BROILERS FROM
SERIAL NUMBER 97 0172 586 ONWARDS.

PLEASE KEEP THIS MANUAL IN A SAFE PLACE FOR FUTURE
REFERENCE.



PLE200500 – C 10-05



CONTENTS.

Description	Page
Burner assembly	2
Gas valve and regulator	3
Pilot assembly	4
Drip trays, panels, adjustable feet and brushes.	5
Stands and tables	6
Service contacts	6

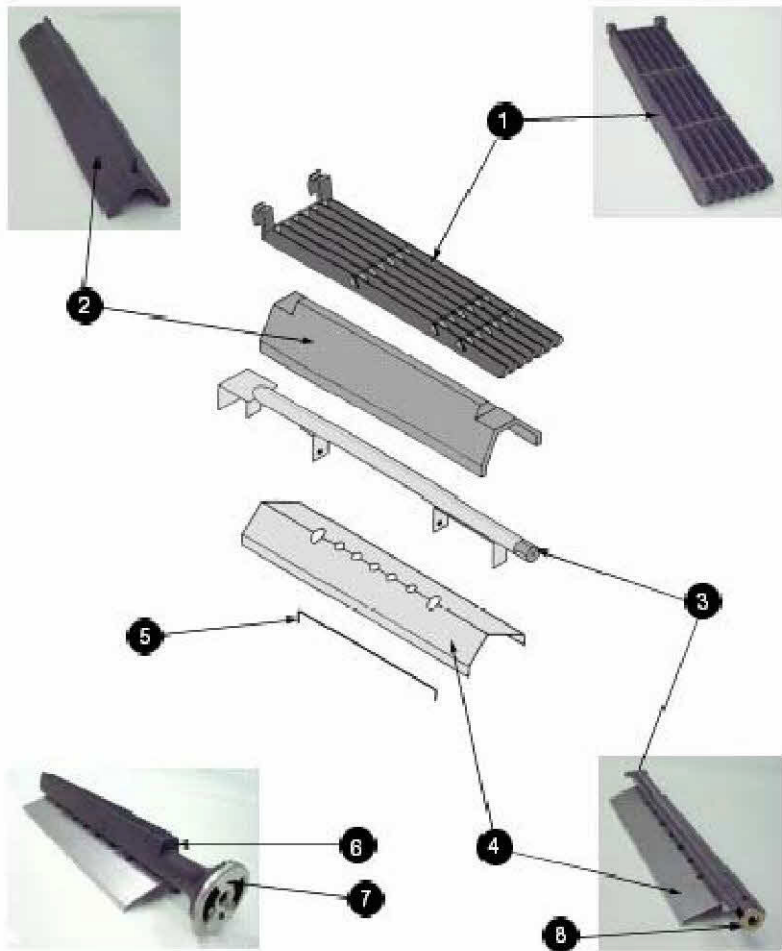

Item number	Part number	Description
1	00-710424	Grate reversible 7 rib
	00-722131	Grate reversible 6 rib
2	00-710407	Radiant
3	00-710453-1	Burner stainless steel, nat gas and LPG 590MM
4	00-700416	Heat deflector
5	00-710455	Rod, heat deflector
8	00-719662	Air shutter

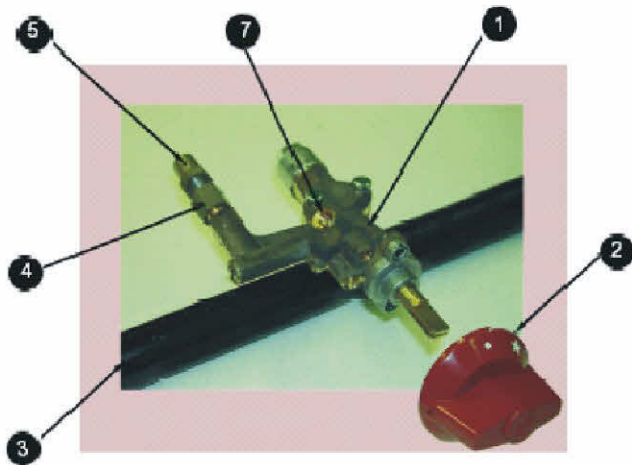

ETI- Gas Conversion

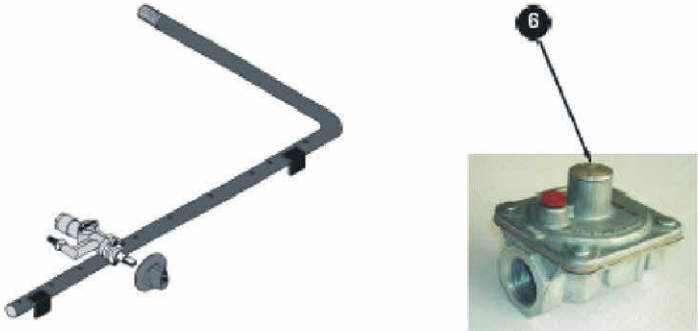

Item number	Part number	Description
1	00-720516-4	Gas control valve, 3 position natural gas
2	00-719255-3	Knob, gas valve
3	00-722446	Manifold pipe, SCB 25 CE
	00-722448	Manifold pipe, SCB 36 CE
	00-722449	Manifold pipe, SCB 47 CE
	00-722450	Manifold pipe, SCB 60 CE
	00-722451	Manifold pipe, SCB 72 CE
4	00-719192	Adaptor, orifice extension
5	00-719951-51	Orifice, main burner #51, natural gas
	00-719951-57	Orifice, main burner #57, LPG
6	00-739029-1	Gas regulator, natural gas
	00-739029-2	Gas regulator, LPG
7	00-720888	Fitting, nut pilot tube (not shown)
	00-720889	Ferrule, brass pilot tube (not shown)
8	GE-E-1-38	Magnet unit, flame failure

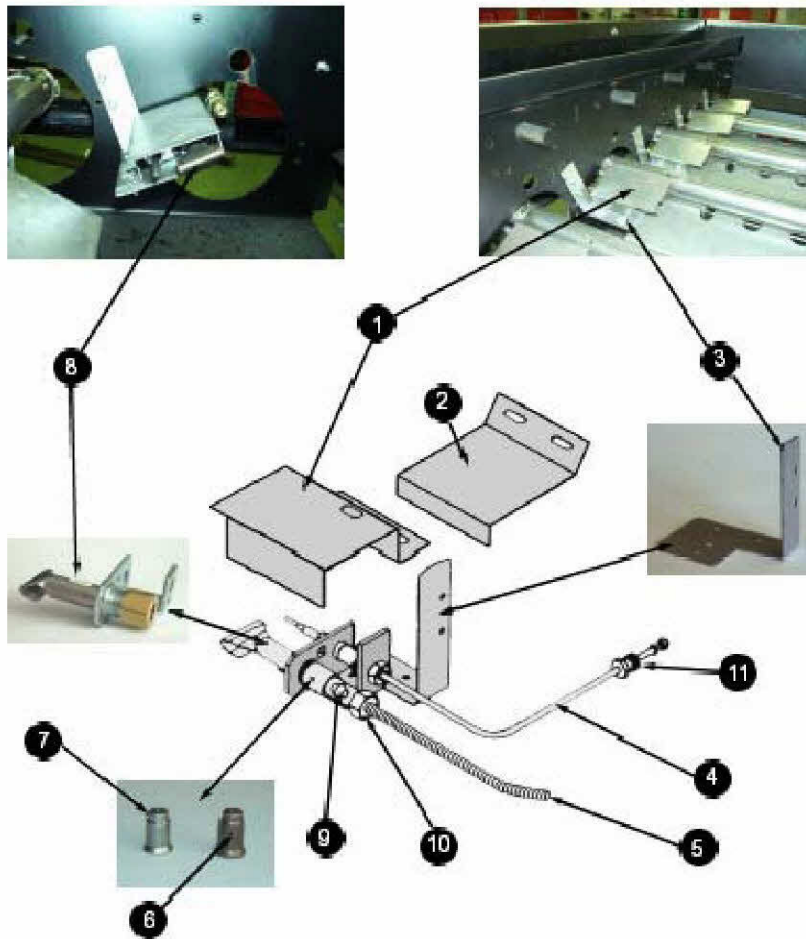

Item number	Part number	Description
1	00-739077	Shield, thermocouple
2	00-769086	Shield, thermocouple (RH pilot on SCB36CE and SCB60CE)
3	00-769961	Bracket, pilot
4	SP-E-1-1	Thermocouple 320 mm long
5	00-723379	Tube, flexible 305 mm long
6	00-711339-P	Orifice, pilot jet, LPG
7	00-711339-N	Orifice, pilot jet, natural gas
8	00-766177	Pilot burner and thermocouple assembly (including orifice)
	00-714269	Pilot burner assembly, natural gas (includes item 6)
9	00-714200	Ferrule, brass
10	00-722466	Nut, pilot jet
11	GE-E-1-40	Mounting kit, thermocouple

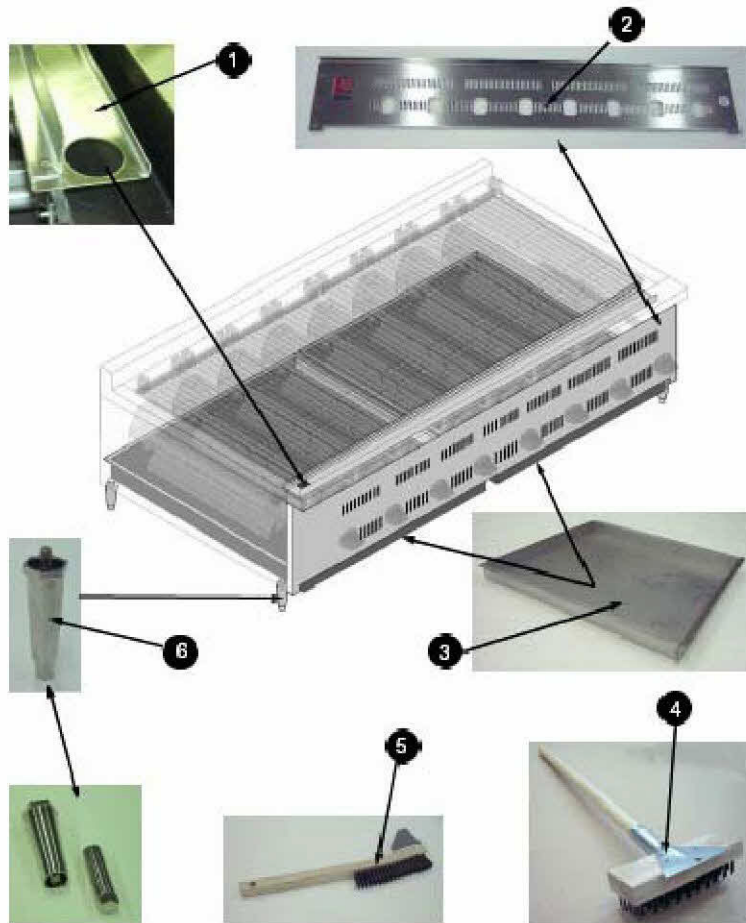

Item number	Part number	Description
1	00-739163	Grease channel, removable SCB25 CE
	00-700894	Grease channel, removable SCB36 CE
	00-700917	Grease channel, removable SCB47 CE
	00-700986	Grease channel, removable SCB60 CE
	00-701163	Grease channel, removable SCB72 CE
2	00-768479	Front panel SCB25 CE
	00-768481	Front panel SCB36 CE
	00-739315	Front panel SCB47 CE
	00-766172	Front panel SCB60 CE
	00-766173	Front panel SCB72 CE
3	00-765335	Drip tray SCB25 CE
	00-765334	Drip tray SCB36 CE
	00-765335	Drip tray SCB47 CE
	00-765336	Drip tray SCB60 CE
	00-765337	Drip tray SCB72 CE
4	00-720432	Cleaning brush, De-lux coarse (accessory)
	00-720431	Cleaning brush, fine
5	00-710412	Cleaning brush (supplied with the machine)
6	00-719260	Leg, adjustable, 100mm (4")
	00-715132	Castor braked 125 mm (5")
	00-715131	Castor non-braked 125 mm (5")



**Accessories (not shown).
Stands.**

Part number	Description
ML-109150	Mobile table 610 mm wide SCB25 CE
ML-109151	Static table complete with adjustable feet 610 mm wide SCB25 CE
ML-109152	Mobile table 914 mm wide SCB36 CE
ML-109153	Static table complete with adjustable feet 914 mm wide SCB36 CE
ML-109154	Mobile table 1220 mm wide SCB47 CE
ML-109155	Static table complete with adjustable feet 1220 mm wide SCB47 CE
ML-109156	Mobile table 1524 mm wide SCB60 CE
ML-109157	Static table complete with adjustable feet 1524 mm wide SCB60 CE
ML-109158	Mobile table 1829 mm wide SCB72 CE
ML-109159	Static table complete with adjustable feet 1829 mm wide SCB72 CE