

# GARLAND

## GAS CONVECTION OVEN MODELS TG3, TG4, TTG3, TTG4

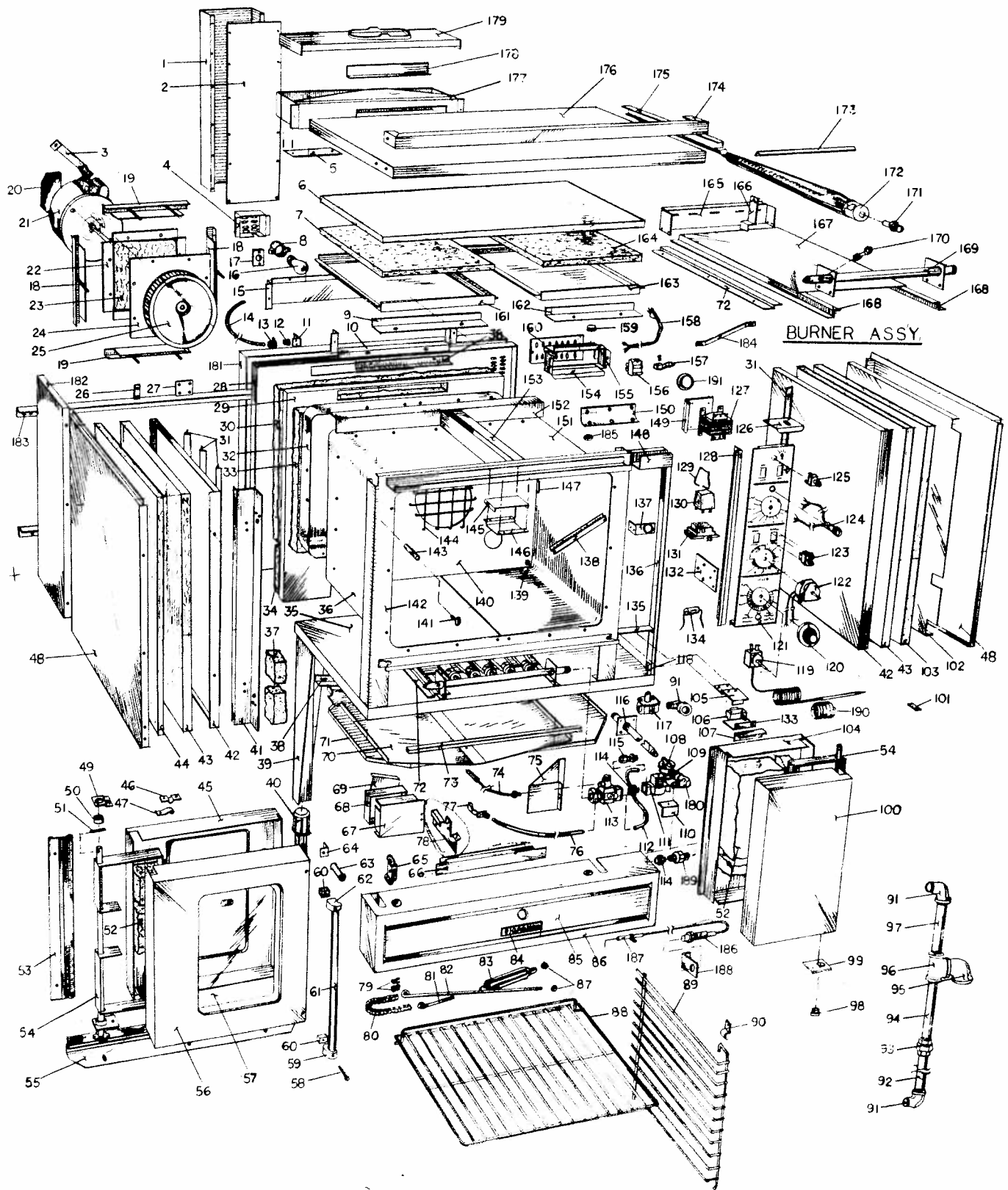

# GARLAND PARTS IDENTIFICATION

## GAS CONVECTION OVEN—MODELS TG3, TG4, TTG3, TTG4

ITEM No.	PART No.	DESCRIPTION	MODELS			
			TG3	TG4	TTG3	TTG4
1	G03038-1-8	Vent Stack Front			1	1
2	G03039-1-8	Vent Stack Back			1	1
3	G03050-1-8	Motor Wall Spacer	1	1	2	2
4	G02887-1-8	Light Box Cover	1	1	2	2
5	G03041-1-8	Flue Collector Patch				
6	G03023-5R	Top Insulation - 33-1/2 x 24-3/16 x 1/2"	1		2	
	G03023-6R	Top Insulation 33-1/2 x 31-1/16 x 1/2"		1		2
7	G03023-3R	Top Insulation L.H.-14-15/16 x 24-15/16 x 1/2"	1		2	
	G03023-4R	Top Insulation L.H.-14-15/16 x 31-13/16 x 1/2"		1		2
8	G02966-1	Light Socket	2	2	4	4
9	G02872-2-6	Insulation Pan Bkt.	1	1	2	2
10	G02870-1-6	Flue Collar	1	1	2	2
11	G2687-1-7	Cable Support	1	1	2	2
12	G01496-1	Anti-Short	5	5	10	10
13	G01497-1	BX Straight Connector	5	5	10	10
14	G02983-2	BX Cable 3/8" x 30"	2	2	4	4
15	G02862-1-6	Back Extension	1	1	2	2
16	G02430-1	Lamp Bulb	2	2	4	4
17	G02958-1	Light Socket Gasket <i>1025900 .03</i>	2	2	4	4
18	G02874-02-8	Motor Mount Brace Assy (Sides)	2	2	4	4
19	G02874-01-8	Motor Mount Brace Assy (Top and bottom)	2	2	4	4
20	G02861-1-8	Motor Screen Cover	1	1	2	2
21	G02968	Motor - 3/4 H.P. (2-speed) (Specify Voltage)	1	1	2	2
	G03324	Motor - 3/4 H.P. (1-speed) (Specify Voltage) (Used from ser. no. 38505 for CH models, ser. no. 35630 for std. units and ser. no. 35432 for export units.)	1	1	2	2
22	G02876-1-8	Motor Mount	1	1	2	2
23	G02877-1	Motor Mount Insulation	1	1	2	2
24	G02875-1-8E	Motor Mount Plate	1	1	2	2
25	G02952-01P	Blower Wheel Assy	1	1	2	2
26	G02909-2-8	Back Stacking Plate (for double ovens only)			1	1
27	G02909-1-8	Back Stacking & Cover Plate	1	1		
	G02909-1-8	Back Stacking & Cover Plate (for double ovens only)			3	3
28	G02856-1-8	Main Back	1	1	2	2
29	G02851-1-6	Back Liner	1	1	2	2
30	GM76	Insulation-Back (cut to size 22 x 33 x 2")	1	1	2	2
31	G02867-1-8	Flue Spacer Angle	6	6	12	12
32	G02930-01-8E	Casing Back Assy	1	1	2	2
33	GM76	Insulation - Back Liner (cut to size 21 x 29-1/2 x 2")	1	1	2	2
34	G03023-9R	Insulation Board - 32-1/2 x 8 x 1/2"	1	1	2	2
35	G02848-01-8	Main Bottom Assy	1		2	
36	G02848-02-8	Main Bottom Assy - 'Deep'		1		2
	G02934-1-8E	Casing L.H.	1		2	
	G02934-2-8E	Casing L.H. - 'Deep'		1		2
37	Cuttings	Fiberglass Insulation (front frame)	2	2	4	4
38	G02859-1-8	Fireplate & Banking Support	3	3	6	6
39	G02847-01-8	Leg Assy 28" (Used up to ser. no. 31333)	4	4	4	4
	G02847-02-8	Leg Assy 8" (Used up to ser. no. 31333)	4	4	4	4
	G02847-011-8	Leg Assy 28" (Used from ser. no. 31334)	4	4	4	4
	G02847-012-8	Leg Assy 8" (Used from ser. no. 31334)	4	4	4	4

FUNCTIONAL PARTS ARE PRICED ON PRICE LIST. ALL OTHER PARTS, PRICED ON APPLICATION.

# GARLAND PARTS IDENTIFICATION

## GAS CONVECTION OVEN—MODELS TG3, TG4, TTG3, TTG4

ITEM No.	PART No.	DESCRIPTION	MODELS			
			TG3	TG4	TTG3	TTG4
40	G02954-1	Square Foot Insert	4	4	4	4
41	G02855-1-6	Front Frame Insulation Support	2	2	4	4
42	G02895-1-6	Side Insulation Pan	2		4	
43	G02895-2-6	Side Insulation Pan - 'Deep'		2		4
	G03024-1R	Side Insulation Board - 29-5/8 x 22-1/2 x 1"	2		4	
44	G03024-2R	Side Insulation Board - 29-5/8 x 29-3/8 x 1"		2		4
	G03023-10R	L.H. Side Insulation Board - 28-5/8 x 23-5/8 x 1/2"	1		2	
45	G03023-11R	L.H. Side Insulation Board - 28-5/8 x 30-1/2 x 1/2"		1		2
46	G02947-01-9	Door Liner Assy - L.H. (with window)	1	1	2	2
47	G03021-1-9	Door Catch	1	1	2	2
	G03728-1	Door Catch (spring type)	1	1	2	2
48	G02896-1-8	Main Side	2		4	
49	G02896-2-8	Main Side - 'Deep'		2		4
	G02907-1-8	Bearing Retainer	2	2	4	4
50	G02928-1P	Door Spacer	2	2	4	4
51	G02962-1	Spring Pin	3	3	6	6
52	GS7378	Fiberglass Door Insulation (cuttings)	2	2	4	4
53	G03030-01-9	Side Door Seal Assy (Used up to ser. no. 36977)	2	2	4	4
	G03266-1-9	Side Seal Support	2	2	4	4
	G03269-1	Side Door Seal } (Used from ser. no. 36978)	2	2	4	4
54	G02978-01-8	Door Frame Assy	2	2	4	4
	GESK1014	Door Seal Assy Kit (Used up to ser. 36977)	1	1	2	2
	G03268-1-9	Top Left & Right Seal Support	2	2	4	4
	G03268-2-9	Centre Seal Support	1	1	2	2
	G03269-2	Top Door Seal } (Used from ser. no. 36978 up to ser. no. 62260)	1	1	2	2
	G03823-1-9	S/S Bottom Door Seal (Used from ser. no. 62261)	1	1	2	2
		Note: Replaces old style fibreglas seal no. G03269-2 on Bottom only.				
56	G02946-1-9	Door Panel - L.H. (with window)	1	1	2	2
57	G02977-1	Oven Door Window	1	1	2	2
58	G01554-68	1/4-20 x 3" Allen Head Screw	2	2	4	4
59	G3814-60R	Oven Door Handle End	1	1	2	2
60	G03018-1	Oven Door Handle Spacer	2	2	4	4
61	G3837-4-8P	Oven Door Handle	1	1	2	2
62	G3814-60L	Oven Door Handle End	1	1	2	2
63	G02974-1-8	Handle Spacer	2	2	4	4
64	G02929-1-8	Window Hold Down Strap	2	2	4	4
65	G03146-1	Magnetic Door Catch	2	2	4	4
66	G02882-01-6	Centre Air Shield Assy	1	1	2	2
67	G02866-1-6	Outer Insulation Pocket	2	2	4	4
68	G02865-1-6	Inner Insulation Pocket	2	2	4	4
69	G02860-1-6	Fireplate Support	2	2	4	4
70	G02858-1-8	Fireplate	1		2	
71	G02858-2-8	Fireplate - 'Deep'		1		2
72	G02939-1-6	Base Heat Shield	1	1	2	2
73	G02853-1-8	Burner Guide Bracket	2	2	4	4
74	G02914-1-6	Pocket Insulation Channel	1	1	2	2
75	G01575-1	2C Thermocouple 16"	1	1	2	2
76	G02864-1-6	TS11 Heat Deflector	1	1	2	2
77	G01494-5	1/4" Tubing (TS11 to pilot)	1	1	2	2
78	G0635	2C-2 Pilot (Specify gas)	1	1	2	2
79	G03152-1-6	Spark Igniter & Pilot Bracket	1	1	2	2
	G02960-1	Connecting Link No. 40	4	4	8	8

FUNCTIONAL PARTS ARE PRICED ON PRICE LIST. ALL OTHER PARTS, PRICED ON APPLICATION.

# GARLAND PARTS IDENTIFICATION

## GAS CONVECTION OVEN—MODELS TG3, TG4, TTG3, TTG4

ITEM No.	PART No.	DESCRIPTION	MODELS			
			TG3	TG4	TTG3	TTG4
80	G02961-1	Roller Chain No. 40	2	2	4	4
81	G02949-1-82	Left Door Rod	2	2	4	4
82	G02949-1-81	Right Door Rod	2	2	4	4
83	G02950-1	Turnbuckle	2	2	4	4
84	G2472-2	Garland Nameplate	1	1	2	2
85	G02883-01-9	Combustion Chamber Door Assy	1	1	2	2
86	G02898-01-9	Combustion Chamber Front Assy	1	1	2	2
87	G01557-31	1/4-20 Hex Nut (r.h. thread) <i>GF76</i>	2	2	4	4
	G01557-57	1/4-20 Hex Nut (l.h. thread) <i>GF83</i>	2	2	4	4
88	G02941-01-8P	Oven Rack Assy	5		10	
89	G02942-01-8P	Oven Rack Assy - 'Deep'		5		10
	G02943-01-41P	Rack Guide Assy R.H.	1		2	
	G02943-01-42P	Rack Guide Assy L.H.	1		2	
	G02943-02-41P	Rack Guide Assy R.H. - Deep		1		2
	G02943-02-42P	Rack Guide Assy L.H. - Deep		1		2
		<i>(Used up to ser. no. 38372)</i>				
90	G03347-01-41P	Rack Guide Assy R.H.	1		2	
	G03347-01-42P	Rack Guide Assy L.H.	1		2	
	G03347-02-41P	Rack Guide Assy R.H. - Deep		1		2
	G03347-02-42P	Rack Guide Assy L.H. - Deep		1		2
	G02916-1-9	Clip Rack Guide <i>(Used up to ser. no. 38372)</i>	2	2	4	4
		<i>(Used from ser. no. 38373)</i>				
91	G03346-1-9	Rack Guide Clip <i>(Used from ser. no. 38373)</i>	4	4	8	8
	G01475-2	90° Street Elbow 3/4" NPT <i>(for double oven qty 2 req'd)</i>	1	1	2	2
92	G01738-12	Pipe Nipple 3/4" NPT x 16-7/8"	1	1	2	2
93	G01963-1	Union 3/4" NPT	1	1	2	2
94	G01738-3	Pipe Nipple 3/4" NPT x 4"	1	1	2	2
95	G01475-3	90° St. Elbow 1" NPT	1	1	2	2
96	G01962-1	Tee 3/4" NPT to 1" NPT	1	1	2	2
97	G01738-5	Pipe Nipple 3/4" NPT x 6-1/2"	1	1	2	2
		<i>(for double oven only)</i>				
98	G02925-2	Door Rod Bushing	2	2	4	4
99	G03014-01-8	Hinge Bracket Assy	2	2	4	4
100	G02944-1-9	Door Panel R.H.	1	1	2	2
101	G01574-1	Buss Bar	2	2	4	4
102	G02852-1-6	Partition Side	1		2	
	G02852-2-6	Partition Side - 'Deep'		1		2
103	G03023-7R	Side Insulation Board R.H. - 29-5/8 x 22-5/8 x 1/2"	1		2	
	G03023-8R	Side Insulation Board R.H. - 29-5/8 x 29-1/2 x 1/2"		1		2
104	G02945-01-9	Right Door Liner Assy	1	1	2	2
105	G03017-1-7	Micro Switch Bkt. <i>(Used up to ser. no. 39369)</i>	1	1	2	2
	G03479-1-7	Micro Switch Bkt. <i>(Used from ser. no. 39370)</i>	1	1	2	2
106	G01137	Micro Switch <i>(Used up to ser. no. 39369)</i>	1	1	2	2
	G03481-1	Micro Switch <i>(Used from ser. no. 39370)</i>	1	1	2	2
107	G02878-01-8	Micro Switch Activator Assy <i>(Used up to ser. no. 39369)</i>	1	1	2	2
	G03480-1-7	Micro Switch Activator <i>(Used from ser. no. 39370)</i>	1	1	2	2
108	G01517-1	Gas Shut-Off Valve	1	1	2	2
109	G01736-1	Close Nipple 1/2 NPT	1	1	2	2
110	G03051-1-6	Solenoid Valve Cover	1	1	2	2
111	G02965-1	Solenoid Valve <i>(120v coil)</i>	1	1	2	2
112	G01494-1	1/4 Tubing <i>(gum valve to TS11)</i>	1	1	2	2
113	G01919-01	TS11J Safety Valve c/w Fittings	1	1	2	2

FUNCTIONAL PARTS ARE PRICED ON PRICE LIST. ALL OTHER PARTS, PRICED ON APPLICATION.

# GARLAND PARTS IDENTIFICATION

## GAS CONVECTION OVEN — MODELS TG3, TG4, TTG3, TTG4

ITEM No.	PART NUMBER	DESCRIPTION	MODELS			
			TG3	TG4	TTG3	TTG4
114	G02971-1	Brass Reducing Fitting ½ to ¾ NPT	2	2	4	4
115	G6809	Gum Valve ⅛ NPT to ¼ CC	1	1	2	2
116	G02969-01-8	Manifold Connecting Pipe Assy	1		2	
	G02969-02-8	Manifold Connecting Pipe Assy - 'Deep'		1		2
117	G01740	Regulator (Specify gas)	1	1	2	2
118	G02884-1-7	Combustion Chamber Mounting Brkt.	1	1	2	2
119	G02902-01	Oven Thermostat - 148°F to 500°F	1	1	2	2
	G02903-01	Oven Thermostat - 100°F to 250°F (CH models only)	1	1	2	2
120	G02716-1	Dial	2	2	4	4
	G02725-21	Dial Insert	2	2	4	4
121	G03611	Control Panel (Specify oven model)	1	1	2	2
122	G03547	12 hr. Timer (Specify Voltage) (CH models only)	1	2	1	2
	G03606-12	12 hr. Timer Replacement Plate	1	2	1	2
	G03320	1 hr. Timer (Specify Voltage) (1SP, 2SP)	1	2	1	2
	G03057	12 hr. Timer Assy. (CH Models only) (Specify Voltage)	1	2	1	2
	G02439-01	60 minute Timer Assy.	1	2	1	2
	G03070	5 hr. Timer Assy. (Optional - Specify Voltage)	1	2	1	2
	GESK1162	Timer Conversion Kit	1	2	1	2
123	G03054-1	Rocker Switch — 1SP & C/H 1SP & 2SP	1	2	1	2
	G03054-2	Rocker Switch — 1SP & C/H 1SP	1	2	1	2
	G03054-3	Rocker Switch — 2SP & C/H 1SP & 2SP (Alternate G03054-1)	1	2	1	2
	G03055-1	Rocker Switch — 2SP & C/H 1SP	1	2	1	2
124	G03055-1	Rocker Switch — C/H 2SP	2	4	2	4
	G0296-3	Pilot Light (Green)	1	1	2	2
	G01296-2	Pilot Light (Amber)	1	1	2	2
125	G03053-1	Momentary Push Button Switch	1	1	2	2
126	G02881-1-9	Handle	1	1	2	2
127	G03052	Transformer (Specify Voltage & HZ)	1	1	2	2
128	G03069-1-9	Control Panel Side	2	2	4	4
129	G02959-1	Relay Mounting Spring	1	1	2	2
130	G02955-2	Relay (120v Coil)	1	1	2	2
131	G02956-1	Relay Socket	1	1	2	2
132	G03071-1-6	Relay Mounting Brkt.	1	1	2	2
133	G03511-1	Micro Switch Insulator	1	1	2	2
134	G02963-1	Capacitor (for CH models only)	1	1	2	2
135	G02879-01-7	Control Panel Support Assy	1	1	2	2
136	G02868-1-7	Side Brace	1	1	2	2
137	G01930-02-7	Wireway Assy	1	1	2	2
138	G02905-01-8E	Capillary Tube Guard Assy	1	1	2	2
	G02905-01-8E	Capillary Tube Guard Assy (for CH models only)	2	2	4	4
139	G02911-1-6	C.O. Baffle Clip - Bottom	2	2	4	4
140	G02932-01-8E	Air Baffle	1	1	2	2
141	G02957-1	Thumbscrew	4	4	8	8
142	G02854-01-8	Front Frame Assy	1	1	2	2
143	G02972-1-8	Air Baffle Spacer	4	4	8	8
144	G02904-01P	Blower Inlet Cover	1	1	2	2
145	G02906-1-9	Vent Slide	1	1	2	2
146	G02906-2-9	Vent Slide Housing	1	1	2	2
147	G02910-1-6	C.O. Baffle Clip Top	2	2	4	4
148	G02869-1-8	Top Brace	1	1	2	2
149	G02893-1-7	Contactor Mounting Bkt.	1	1	2	2
150	G02901-2-9	Rear Casing Element Cover	1	1	2	2
151	G02993-1-8E	Casing R.H.	1		2	
	G02933-2-8E	Casing R.H. - 'Deep'		1		2

FUNCTIONAL PARTS ARE PRICED ON PRICE LIST. ALL OTHER PARTS, PRICED ON APPLICATION.

# GARLAND PARTS IDENTIFICATION

## GAS CONVECTION OVEN—MODELS TG3, TG4, TTG3, TTG4

ITEM No.	PART No.	DESCRIPTION	MODELS			
			TG3	TG4	TTG3	TTG4
152	G02936-1-6	Back Vent Angle	1	1	2	2
153	G02857-1-6	Flue Vent	1		2	
	G02857-2-6	Flue Vent		1		2
154	G02885-3-8	Junction Box - Bottom	1	1	2	2
155	G02885-1-8	Junction Box - Top	1	1	2	2
156	G01269-1	Terminal Block ( <i>Export models and Std. 208v units only</i> )	1	1	2	2
157	G01500-1	Ground Lug	1	1	2	2
158	G2840-1	Cord & Plug	1	1	2	2
159	G02973-1	Plastic Hole Plug	1	1	2	2
160	G02886-1-8	Junction Box Cover	1	1	2	2
161	G02871-3-6	Top Insulation Pan	1		2	
	G02871-4-6	Top Insulation Pan - 'Deep'		1		2
162	G02872-1-6	Top Insulation Pan Bkt.	1	1	2	2
163	G02871-1-6	Top Insulation Pan	1		2	
	G02871-2-6	Top Insulation Pan - 'Deep'		1		2
164	G03023-1R	Insulation Board Top-24-15/16 x 13-3/16 x 1/2	1		2	
	G03023-2R	Insulation Board Top-31-13/16 x 13-3/16 x 1/2		1		2
165	G03068-1-8	Burner Back Rear Angle	1	1	2	2
166	G03066-1-8	Cross Over Bkt.	2	2	4	4
167	G03063-1-6	Radiation Shield	1	1	2	2
168	G03067-1-8	Burner Side Rail	2	2	4	4
169	G03061-01	Burner Manifold Assy	1	1	2	2
170	G02251-1	Pressure Test Spigot	1	1	2	2
171	G03056	Burner Orifice ( <i>Specify gas</i> )	5	5	10	10
172	G02953-1-6	Burner c/w Air Shutter	5	5	10	10
173	G03065-1-9	Cross Over	1	1	2	2
174	G02873-1-9	Main Top Veneer	1	1	2	2
175	G02891-1-9	Side Top Veneer	2		4	
	G02891-2-9	Side Top Veneer - 'Deep'		2		4
176	G02897-1-8	Main Top	1		2	
	G02897-2-8	Main Top - 'Deep'		1		2
177	G03035-01-8	Flue Collector Box Assy	1	1	2	2
178	G03040-1-8	Flue Diverter	1	1	2	2
179	G03036-1-8	Flue Collector Cover ( <i>Optional</i> )	1	1		
	G03037-1-8	Flue Collector Cover			1	1
	G02982-01-8	Flue Collector Assy. ( <i>Optional</i> )			1	1
180	G01472-1	90°St. Elbow 1/2 NPT	1	1	2	2
181	G03099-1-8	Main Back Veneer ( <i>Optional</i> )	1	1	2	2
182	G03100-1-8	Veneer Side ( <i>Optional</i> )	2	2	4	4
183	G03123-1-7	Back Veneer Angle Support ( <i>Optional</i> )	2	2	4	4
184	G03400-1-7	Extension Wing Support ( <i>Optional</i> )	2	2	4	4
185	G03618-1	Alum. Asbestos Padded Washer	22	22	44	44
186	G03150-1	Piezo Igniter	1	1	2	2
187	G03151-1	Piezo Electrode	1	1	2	2
188	G03153-1-6	Push Button Support Bracket	1	1	2	2
189	G01739-1	Union 1/2" NPT	1	1	2	2
190	G01922-9	Capillary Vinyl Tube Sleeving - 39" L. (105°)	1	1	2	2
191	G01487-1	Heyco Bushing	1	1	2	2

FUNCTIONAL PARTS ARE PRICED ON PRICE LIST. ALL OTHER PARTS, PRICED ON APPLICATION.