

Operating Instructions

Winterhalter Gastronom Dishwasher **GS 14 / GS 14E**
GS 15 / GS 15E

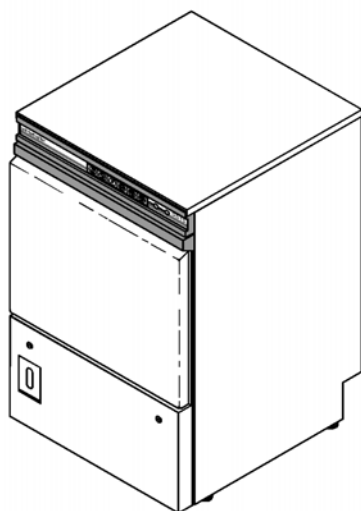

Contents

1. Intended purpose
2. Installation and initial start-up
3. Safety information for the operator
4. Operating and indicating elements
5. Before the wash
6. Topping up the regenerating salt (GS 14E / GS 15E)
7. Wash cycle
8. After the wash
9. Care and maintenance
10. Operating faults
11. Optional extras
12. Special notes
13. Emission data

1. Intended purpose

The **Winterhalter Gastronom dishwashers GS 14, GS 14E, GS 15 and GS 15E** are designed for **cleaning** all types of **kitchenware** used in catering establishments. They may only be used for this purpose, and in accordance with the operating instructions.

Any other usage or modification of the machine's design without our written consent will exempt us from all guarantee and product liability obligations.

2. Installation and initial start-up

The machine must be installed and connected to the on-site supply and waste pipes in accordance with the **"Installation instructions for Winterhalter Gastronom glass and dish washing machines"**.

The initial start-up (or so-called "running-in" phase) and the briefing of the machine operator must be performed by Winterhalter service technicians in accordance with the **"Start-up regulations for Winterhalter Gastronom dish and utensil washing machines"**. For this purpose, you should contact the Winterhalter representative responsible for your factory once the machine has been correctly connected to the on-site supply pipes.

Your dishwasher is not ready to be put into operation until all connections have been completed.

3. Safety information for the operator

The following points must be observed to ensure safe operation of the machine:



- Only use this machine after having read and understood the operating instructions and been personally instructed in the operation and workings of the machine.
- Only operate the machine as described in these operating instructions.
- Risk of injury: Do not open any coverings or machine parts for which the use of a tool is required.
- When using detergent and rinse aid products, observe the safety information printed on the packaging.
- Wear protective gloves for any work which has to be performed inside the tank while the machine is operational or during the daily maintenance/shutdown routine.
- In the event of any faults which cannot be traced back to the on-site water or power supply, please contact the Winterhalter customer service team.

4. Operating and indicating elements

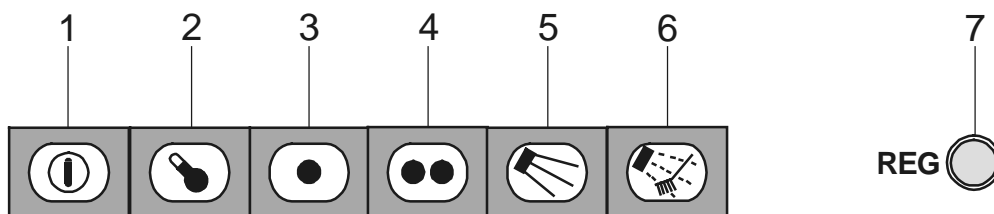

1	Mains switch	1 st actuation = machine on (lamp illuminated) 2 nd actuation = machine off (lamp extinguished).
2	Indicator lamp for detergent solution temperature	Lights up until operating temperature of detergent solution is reached.
3	Programme 1	Actuation = "Short" programme selected (lights up while programme is in progress). Standard setting: GS 14, GS 14E: approx. 150s GS 15: approx. 75s, GS 15E: approx. 120s
4	Programme 2	Actuation = "Long" programme selected (lights up while programme is in progress). Standard setting: GS 14, GS 14E: approx. 300s GS 15: approx. 150s, GS 15E: approx. 180s
5	Continuous circulation of detergent solution	1 st actuation = Circulation on (lamp illuminated). 2 nd actuation = Circulation off (lamp extinguished).
6	Continuous freshwater rinse / tank cleaning	Continuous actuation = operates freshwater rinse for cleaning inside of tank

GS 14E and GS 15E only

7	Water treatment indicator lamp:	This LED lights up when the salt level is low. It can also be optionally installed in the GS 14 and GS 15 to indicate when the water treatment unit is worn out.
---	--	--

Optional extra



Detergent supply indicator lamp	This lights up when the detergent container is empty.
--	---

5. Before the wash

5.1 Preparing the machine for operation

To do this, proceed as follows:

A) **Open** the on-site **shut-off valve** of the water supply pipe.



B) **Turn on** the on-site **main switch**.

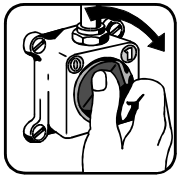

At the same time, **test** the on-site **residual-current operated circuit-breaker** for your own safety by pressing the test button.

C) **Open** the **door**. Pull the rack out of the machine.

D) **Insert** the **standpipe** into the wash tank by twisting it gently until it fits tightly.

E) **Check** to make sure the **surface strainers** are correctly positioned in the tank.

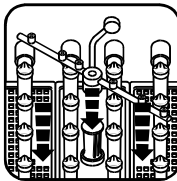

F) **Check** to make sure all **wash arms** are in place.

G) **Slide** the **rack** into the machine. **Close** the **door**.

H) **Press** the **power switch (1)** (lights up when pressed).

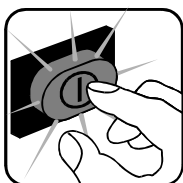

The tank is now filled automatically.

As soon as the necessary water level is reached in the tank, the machine is **heated to operating temperature**.

The white indicator lamp (2) lights up until the **operating temperature** is reached and then goes out again.

The heating time depends on the temperature of the incoming water.

I) **Check** the **filling level** in the **rinse aid container** through the slit in the front panel and top it up if necessary.

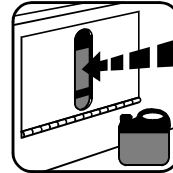

Make sure the rinse aid container never becomes completely empty.

Additional rinse aid is metered automatically. We recommend the use of our **Winterhalter Gastronom** rinse aid product.

5.2 Detergent pre-dosing

Add an initial dose of approx. 50g detergent (powder) to the heated tank water.



If using other detergents, follow the dosing directions printed on the packet.

Remember that more detergent is needed the dirtier the dishes or the harder the water.

To ensure that the detergent mixes in thoroughly and does not settle on the floor of the tank, you should switch on the machine briefly after adding the initial dose.

Press pushbutton (3).

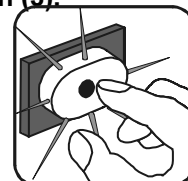

NOTE

The measuring cup supplied with our detergent containers holds approx. 200g of powder. One heaped dessertspoonful of powder is equivalent to approx. 20g. To avoid staining the tank floor, it is advisable to dissolve the detergent in hot water before adding it or to pour it onto the plastic surface strainers.

NOTE

Only use **detergent and rinse aid** products which are suitable for **commercial dishwashers**. **Observe the safety information printed on the packaging.**

We recommend the use of our **Winterhalter Gastronom detergent**.

NOTE

If the machine is equipped with an automatic detergent dosing device (optional extra), there is no need to add detergent manually. See the corresponding instruction manual on how to use this device.

6. Topping up the regenerating salt (GS 14E, GS 15E)

In models GS 14E and GS 15E with built-in water softeners (SoftMatik), the **"REG" indicator (7)** lights up when the salt level in the container is low.

In this case, **fill** the salt container with special **regenerating salt for water softeners**.

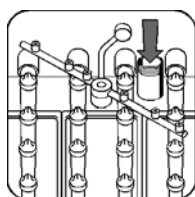

The salt container must only be filled with regenerating salt! Any other chemicals, e.g. detergent or rinse aid, will inevitably result in damage to the machine. The salt should be added in fine-grain form (max. 5-7 mm grain size): salt tablets are not suitable.

We recommend the use of our Winterhalter SoftMatik regenerating salt.

Procedure:

- Unscrew the cap of the salt container.
- Fill the container with one bag (500g) of **Winterhalter Softmatik regenerating salt** using the supplied **funnel**.
- Remove salt remnants from the screw thread and sealing surface of the salt container.
- Screw the cap of the salt container back on again and tighten it by hand.
- Activate Programme 1 by pressing key (3).

7. Wash cycle

Arrange the soiled kitchenware correctly in the rack, then push the rack into the machine and close the door.

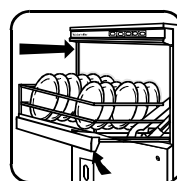

Select the right programme for the relevant degree of soiling and press the button to start.

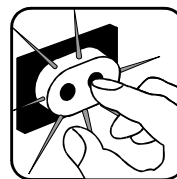

For lightly soiled items, you should select the "Programme 1" button (3). Programme duration:

GS 14 approx. 150s = 24 racks/h
GS 14E approx. 150s = 24 racks/h
GS 15 approx. 75s = 48 racks/h
GS 15E approx. 120s = 30 racks/h

For heavily soiled items, select the "Programme 2" button (4). Programme duration:

GS 14 approx. 300s = 12 racks/h
GS 14E approx. 300s = 12 racks/h
GS 15 approx. 150s = 24 racks/h
GS 15E approx. 180s = 20 racks/h

Sequence of operations

- Circulation of detergent solution: intensive cleaning from above and below.
- Freshwater rinse with water heated to 85°C (containing rinse aid).
- The indicator lamp in the selected pushbutton remains alight throughout the programme sequence.

- Once the lamp is extinguished, the door can be opened and the rack can be pulled out of the machine to allow removal of the washed items.
- Do not remove the rack too early, as this will interrupt important stages of the programme.
- Reload the rack and continue washing as described above.
- Make sure the door remains closed when the machine is not in operation in order to avoid an unnecessary waste of energy.

The washed items will dry clean and shiny within a short time due to their own heat and the effect of the rinse aid added to the rinse water. There is therefore no need to wipe them with a tea-towel.

Topping up the detergent

The concentration of detergent in the detergent solution decreases steadily during the washing process (due to the freshwater rinse).

You should therefore add a further 60g of detergent powder **after approx. 10 wash cycles**.



After adding the detergent, start programme 1 immediately to make sure it mixes in thoroughly.

Heavily soiled items...

...can be washed intensively (max. 15 minutes).

For this purpose, **press pushbutton (5)**.

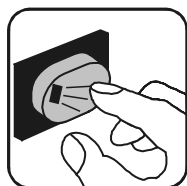

This button lights up during operation. To **end** the wash cycle, **press pushbutton (5) again**. Then activate Programme 1 by pressing button 3.

NOTE

If the maximum time of 15 minutes is exceeded, the machine switches to fault mode (see "Operating faults").

Routine checks

- **Check the rinse aid level** in the container.
- **Check** to make sure the **washed items are clean**.
- **Check** that the **temperature indicator lamp (2) goes out** each time. This means that the **setpoint temperatures** have been reached.
- **Check the strainers** inside the machine for **dirt** and clean them **if necessary**.

8. After the wash

- Open the door** and take the rack out of the machine.
- Remove the standpipe.**

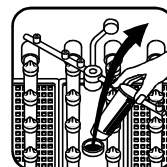

This will drain the tank.

- Close the door** after **draining the tank**.
- Clean the inside** of the drained **tank** by **pressing the pushbutton "Clean tank" (6)** briefly (approx. 10s).

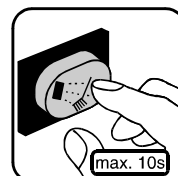

- Open the door, sweep the remaining dirt residue onto the surface strainers and remove these from the machine.

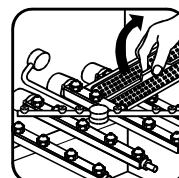

F) **Clean the surface strainers.**



G) **Close the door** and press the **pushbutton "Clean tank"** (6) again for approx. 10 seconds.

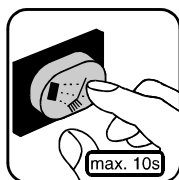

This will make sure the rest of the tank is cleaned.

H) **Open the door.**

I) Remove the **pump intake strainer** for cleaning, then re-insert it.

J) **Re-insert the surface strainers and stand-pipe** into the **wash tank** by **twisting gently**.

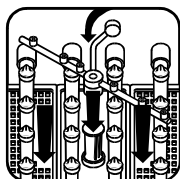

K) **Close the door** and turn off the machine by **pressing the power switch (1).**

L) **Close the shut-off valve.**



M) **Turn off the main switch.**

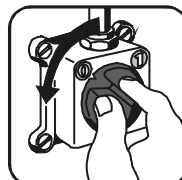

N) **Clean the outside of the machine** with a soft cloth and a suitable **cleaning agent**.

We recommend Winterhalter Gastronom stainless steel cleaner and stainless steel preservative.

Leave the door of the machine open after cleaning. There is a catch provided for this purpose.

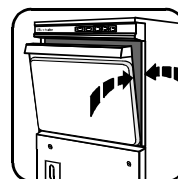

9. Care and maintenance

Carry out the following maintenance jobs at regular intervals:

- A) Check operation of machine.
- B) Remove and clean wash arms and nozzles, then remount them correctly.
- C) Clean residues from inside of machine.
- D) Clean fine-mesh strainer in dirt trap downstream of the on-site water supply.
- E) Clean electrode of conductivity-sensitive dosing unit if installed.

F) Descale if necessary as follows (not applicable to GS 14E and GS15E):

- Drain machine.
- Stop detergent supply.
- Refill machine.
- Add decalcifier solution according to manufacturer's directions.

NOTE

Observe the safety instructions printed on the packaging.

- Operate the machine: activate the continuous circulation function for approx. 10 minutes by pressing switch (5) and releasing it again after 10 minutes.
- Drain the machine.

NOTE

Under no circumstances should the decalcifier solution be left in the machine for several hours.

- Start up the detergent supply again.
- Refill the machine.
- Run the machine for a further 10 minutes or so.
- Drain the machine or use the water for the current wash.

During the daily cleaning routine, make sure that no rusty foreign bodies are left on the floor and walls of the tank, as these can cause even "stainless" steel to rust. Such rust particles may originate from non-stainless kitchenware, cleaning aids or non rust-proofed supply pipes.

Besides the daily cleaning and regular maintenance routines, the machine should undergo thorough servicing by a specialist at least twice a year.

We recommend that you have this done by a Winterhalter service technician.

Use suitable cleaning agents and preservatives to treat the outside of the machine. We recommend Winterhalter Gastronom stainless steel cleaner for this purpose.

10. Operating faults...

...can sometimes be rectified by the user.

Check the possible causes indicated here and eliminate them accordingly.

If you are unable to determine the cause, contact a Winterhalter service technician.

WARNING

Do not open any coverings or machine parts for which the use of a tool is required.

Fault	Possible cause
Machine cannot be switched on.	<ul style="list-style-type: none">On-site main switch is not turned on.Internal cause: contact the responsible after-sales service.
Machine is not filling up.	<ul style="list-style-type: none">On-site main shut-off valve is not open.Dirt trap in supply water pipe is blocked.
Tank supply pipe filling the machine continuously.	<ul style="list-style-type: none">Standpipe not correctly inserted.
Washed items are still dirty.	<ul style="list-style-type: none">Detergent dosing omitted or interrupted due to empty container.Pump intake strainer blocked.Items not loaded correctly in the machine.Wash nozzles in wash arms blocked.Setpoint temperatures not reached.
Washed items are still wet.	<ul style="list-style-type: none">Rinse aid supply interrupted due to empty container.Setpoint temperatures not reached.
Indicator lamps in programme keys (3) and (4) are flashing.	<ul style="list-style-type: none">Wash cycle was interrupted as the setpoint temperature was not reached in the boiler after 15 minutes. Switch the machine off and on again. If the keys are still flashing, the problem is due to a machine-internal cause, and you should contact the responsible after-sales service.
Indicator lamps in programme keys (3) and (4) are flashing and indicator lamp in switch (5) is constantly illuminated.	<ul style="list-style-type: none">The 15-minute time limit for the continuous circulation cycle was exceeded. Press switch (5), then turn the machine off and on again.

11. Optional extras

11.1 Variable rinse temperature

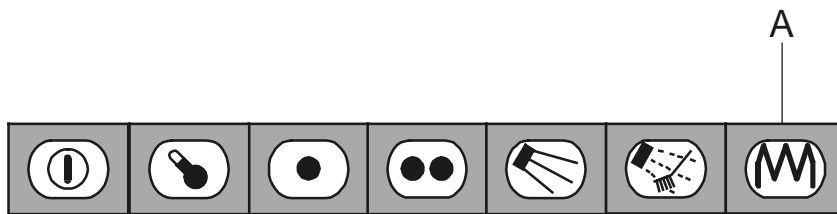

Function of the variable rinse temperature facility

The selector switch "Rinse temperature" (A) is used to switch between a high and low rinse temperature.

Important:

The **high rinse temperature** is set at the factory to **85°C** and the **low rinse temperature** to **65°C**.

- Press switch (A) once to select the high rinse temperature (indicator lamp in switch lights up).

If you use the **high rinse temperature** together with the recommended rinse aid, you are guaranteed optimal **drying results**. We recommend the high rinse temperature for washing **crockery**.

- By pressing switch (A) a second time, you can switch to the low rinse temperature (indicator lamp in switch goes out).

The **lower rinse temperature** must always be preselected for **washing glasses**, as a high temperature can cause glass corrosion (clouding).

12. Special notes

Should the detergent solution become heavily soiled after a day's intensive washing, you should drain it off, clean the inside of the tank and then refill the tank.

In this case you will need to add an initial dose of detergent again as described in section 5.2.

Please only use detergent and rinse aid products which are suitable for commercial dishwashers. We recommend our own products for this purpose, as they have been specially developed for our machines.

All weights and measures specified in this manual for detergent and rinse aid refer to Winterhalter products.

The machine must be protected from freezing conditions in order to avoid damage to water conducting systems.

These operating instructions are an integral part of the machine!

In the event of a resale of the dishwasher, the operating instructions must be passed on to the new owner/operator together with the machine.

13. Emission data

Noise emission data

Workplace-related emission level measured according to EN ISO 11202:

$L_{pAeq} = 60 \text{ dB}$