



E91 ELECTRIC SALAMANDER

SERVICE MANUAL





 **WARNING: ALL INSTALLATION AND SERVICE REPAIR WORK MUST BE CARRIED OUT BY QUALIFIED PERSONS ONLY.**

CONTENTS

This manual is designed to take a more in depth look at the E91 electric salamander for the purpose of making the units more understandable to service people.

There are settings explained in this manual that should never require to be adjusted, but for completeness and those special cases where these settings are required to change, this manual gives a full explanation as to how, and what effects will result.

SECTION	PAGE NO.
1. SPECIFICATIONS	5
2. INSTALLATION	7
3. OPERATION & MAINTENANCE	9
4. TROUBLE SHOOTING GUIDE	10
5. SERVICE PROCEDURES	11
5.1 Element Replacement	
5.2 Selector Switch Replacement	
5.3 Indicator Light Replacement	
6. SPARE PARTS	12
7. WIRING DIAGRAM	13
8. CIRCUIT SCHEMATIC	14
9. PARTS DIAGRAMS.....	15
10. SERVICE CONTACTS.....	17

 IMPORTANT: MAKING ALTERATIONS MAY VOID WARRANTIES AND APPROVALS.

1. SPECIFICATIONS

MODEL: E91

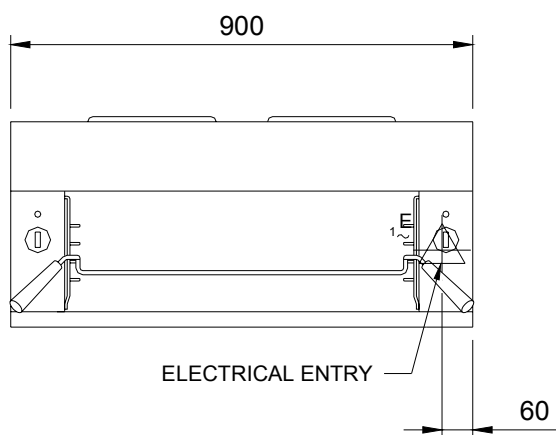

FRONT

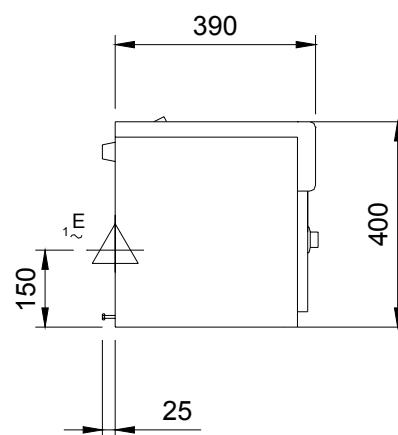

SIDE



PLAN

LEGEND



- Electrical connection entry point

Dimensions shown in millimetres.

INSTALLATION CLEARANCES

	Combustible	Non-Combustible
Sides	250mm	25mm
Back	—	25mm
Top	300mm	300mm
Bottom	If unit is to be wall mounted above a cooking surface, a 600mm clearance must be maintained.	

OVERALL DIMENSIONS

Width	900mm
Height	420mm (Including trough tray)
Depth	540mm (Including rack handle)

INTERNAL DIMENSIONS

Width	685mm
Height	260mm
Depth	330mm

RACK DIMENSIONS

Width	630mm
Depth	280mm

ELECTRICAL SUPPLY SPECIFICATION

220-240 Volts A.C, 50/60 Hz, 25 Amp, 6.0 kW

2. INSTALLATION

⚠ WARNING: ALL INSTALLATION AND SERVICE REPAIR WORK MUST BE CARRIED OUT BY QUALIFIED PERSONS ONLY.

It is important that this salamander is installed correctly, and that the operation is correct before handing over to the user.

This appliance must be installed in accordance with local electrical, health and safety requirements.

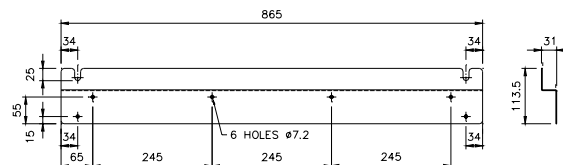

Figure 2.1 - Wall Mounting Bracket

2.1 BEFORE CONNECTION

Each unit requires the rack and wall mounting bracket or legs to be fitted. Remove all these items along with tray(s) and instruction book from the unit.

Check all dismantled parts and hidden parts for transit damage. Report any damage to the carrier and supplier. Report any deficiencies to your supplier.

Check that the available power supply is correct to that shown on the rating plate located on the base panel.

220-240 Volts A.C, 25.0 Amp, 6.0 kW.

2.2 ASSEMBLY

With all loose items removed from the unit, the following assembly is required:

a) Wall Mounted Units

Fix the wall mounting bracket to the wall with six screws, in such a position that the top of the bracket is level and at least 945mm (38") above any cooking appliance beneath the unit. This will insure that the bottom of the Salamander is at least 600mm (24") above any cooking appliance.

Fit the two black plastic spacers to the top rear corners of the unit. Do not tighten.

Fit the two adjusting screws/bolts into the nutserts at the bottom rear corners of the unit.

Hang the unit from the wall mounting bracket by the black plastic spacers. Tighten the black spacers securely and by adjusting the levelling screws/bolts, ensure that the unit is level.

b) Bench Mounted

Lift the unit onto its back, remove all plastic covering, and screw four legs (optional extra) into the hank nuts at each corner of the appliances.

Lift onto its legs and ensure the unit is level by adjusting the feet.

NOTE: It is important to leave at least 25mm (1") of air space around both the sides and rear of this unit.

c) All Units

Remove plastic film from stainless steel tray and slide into unit. Branding plate models - screw tap into black enamelled trough tray and fit in the stainless steel tray. Slide trough tray into the unit.

The installation of the rack is dependent on the cooking function.

2.3 ELECTRICAL CONNECTION

All units are fitted with a 30 amp 3 wire power flex for electrical supply connection plug wiring as required (see specifications page 5).

If required the appliance can be connected to two 13 or 15 amp single phase supplies by removing the supplied cable and removing the fibreglass insulated wire loom between L/H and R/H terminal block. Independent cords can then be connected to each side. The side panels will require removal to carry out conversion.

2.4 RATING PLATE LOCATION

Units manufactured from July 2002.

The rating plate for the E91 and E91B salamanders is located on the RH side bottom front corner. An internal rating plate is located inside the RH side panel on the lower front corner.

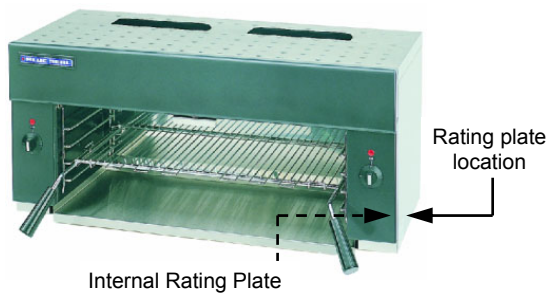

Figure 2.2

Units manufactured up to July 2002.

The rating plate for the E91 and E91B salamanders is located on the underside of the RH side panel.

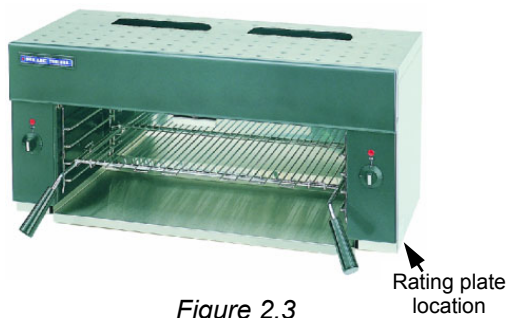

Figure 2.3

3. OPERATION & CLEANING

NOTE: A full user's operation manual is supplied with the product and can be used for further referencing of installation, operation and service.

3.1 OPERATION

HEAT SETTINGS

Switch position	Power
1	750W
2	1800W
3	3000W

RACK POSITION

Branding plate - Install trough tray under rack with the rack sloping as below to allow oil and grease to run off into the trough tray.

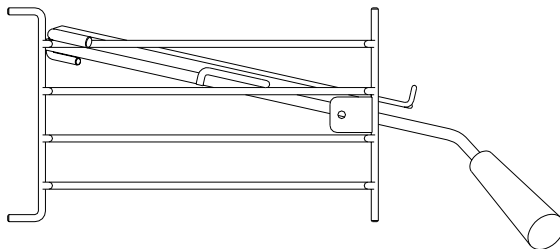

Figure 3.1

No branding plate - Install rack in horizontal position as illustrated below.

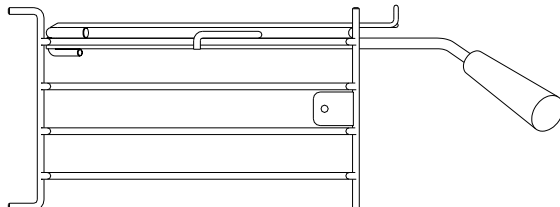

Figure 3.2

3.2 CLEANING



WARNING: ALWAYS TURN THE POWER SUPPLY OFF BEFORE CLEANING.



IMPORTANT: THIS UNIT IS NOT WATER PROOF. DO NOT USE A WATER JET SPRAY TO CLEAN THIS UNIT.

STAINLESS STEEL SURFACES

Clean with detergent. Baked on deposits or discolouration may require a good quality stainless steel cleaner. Always apply cleaner when the salamander is cool and rub in the direction of the "grain".

HEAT REFLECTOR

The E91 Salamander has a stainless steel heat reflector which is removable for easy cleaning. To remove, remove the racks and runners, loosen the locking screw located at the centre front, and pull the reflector release slide forward. Retighten the locking screw. The release slide and elements will now drop in the centre, allowing the reflector to be removed.

When refitting, always ensure that the release slide is pushed back and the locking screw is tightened.

This appliance **MUST NOT** be operated with the reflector removed.

VITREOUS ENAMEL SURFACES

Do not use wire brushes, steel wool or other abrasive material. Clean the interior regularly with a good quality domestic oven cleaner. Remove the rack and side racks from the salamander - this allows easy cleaning of the flat enamelled side walls. Leave the tray in to collect all residue.

CRUMB TRAY AND GREASE TROUGH

Empty and clean daily.

4. TROUBLE SHOOTING



WARNING: ALL INSTALLATION AND SERVICE REPAIR WORK MUST BE CARRIED OUT BY QUALIFIED PERSONS ONLY.

FAULT	POSSIBLE CAUSE	REMEDY
THE UNIT DOES NOT OPERATE (NEITHER ELEMENT WORKS)	The mains isolating switch on the wall, circuit breaker or fuses are "off" at the power board.	Turn on.
	Incorrect electrical supply.	Ensure electrical supply correct.
ONE ELEMENT DOES NOT WORK / ONE ELEMENT COIL DOES NOT WORK	Selector switch on unit faulty.	Check switch poles - replace if faulty. (Refer service section 5.2.2)
	Element faulty (blown).	Replace. (Refer service section 5.2.1)
INDICATOR LIGHT DOES NOT ILLUMINATE	Indicator faulty.	Replace. (Refer service section 5.2.3)

5. SERVICE PROCEDURES

⚠ WARNING: ALL INSTALLATION AND SERVICE REPAIR WORK MUST BE CARRIED OUT BY QUALIFIED PERSONS ONLY.

⚠ WARNING: ENSURE ELECTRICAL SUPPLY IS SWITCHED OFF BEFORE SERVICING.

5.1 ELEMENT

- 1) Remove trays and racks from unit.
- 2) Remove the relevant side panel by removing the 2 screws located under the applicable side. Loosen the 2 outer screws on the back panel. Unscrew and remove the legs (if fitted). Remove the side panel by pulling down.



Figure 5.2.1

- 4) Remove wires from the element terminals.
- 5) Loosen the element support thumbscrew. Slide the element support back to release it from the thumbscrew.

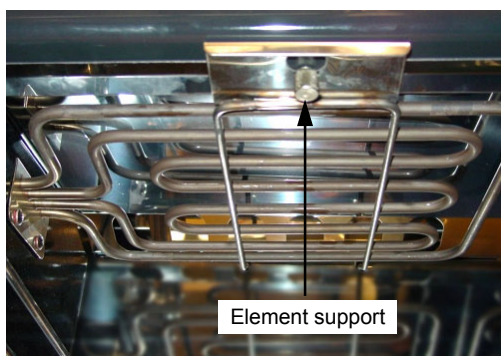

Figure 5.2.2

- 6) Undo the two screws securing the element to the inside wall of the salamander.
- 7) Replace the element and reassemble in reverse order.

NOTE: Correct element resistances ($\pm 5\%$):

Inner Coil: 32 ohms
Outer Coil: 48 ohms

5.2 SELECTOR SWITCH

- 1) Remove the selector knob by pulling firmly away from the control panel.
- 2) Undo the two screws at the bottom of the control panel. Drop the control panel down to access components.
- 3) Undo the two screws securing the selector switch to the control panel.

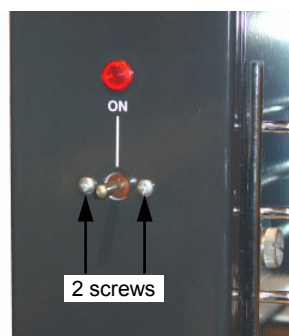
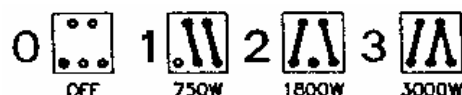

Figure 5.2.3

- 4) Transfer the wires to the new selector switch, and secure to control panel with two screws.
- 5) Replace selector knob and control panel.

NOTE: Correct switch operation:



5.3.3 INDICATOR LIGHT

- 1) Undo the two screws at the bottom of the control panel. Drop the control panel down to access components.
- 2) Remove the wires from the rear of the neon.
- 3) From back push neon through front of panel rotating clockwise.
- 4) Push new neon in from front of panel, and reconnect wires.
- 5) Replace control panel.

6. SPARE PARTS

PART NO	DESCRIPTION
017682	Selector Switch
017683	Knob
015758	Element
013528	Indicator Light
017963	Rack
013395	Rack Handle
017965	Side Rack (To serial number 214583)
023961	Side Rack (From serial number 214584)
013315	Stainless Steel Tray
013418	Branding Plate
004050	Trough Tray
013048	4" Legs (optional)
015080	1" Legs (optional)
013758	Instruction Book

7. WIRING DIAGRAM

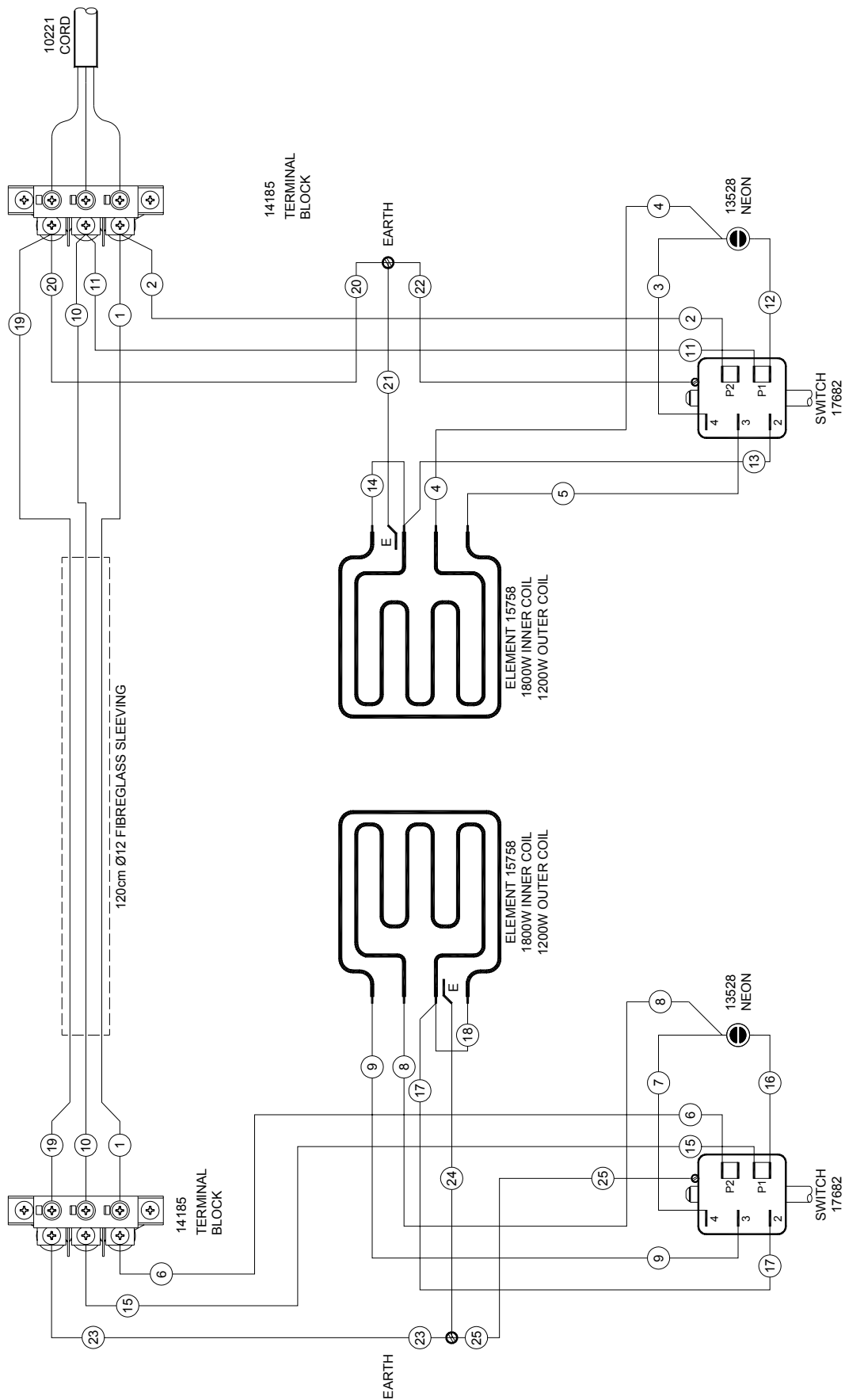

8. CIRCUIT SCHEMATIC

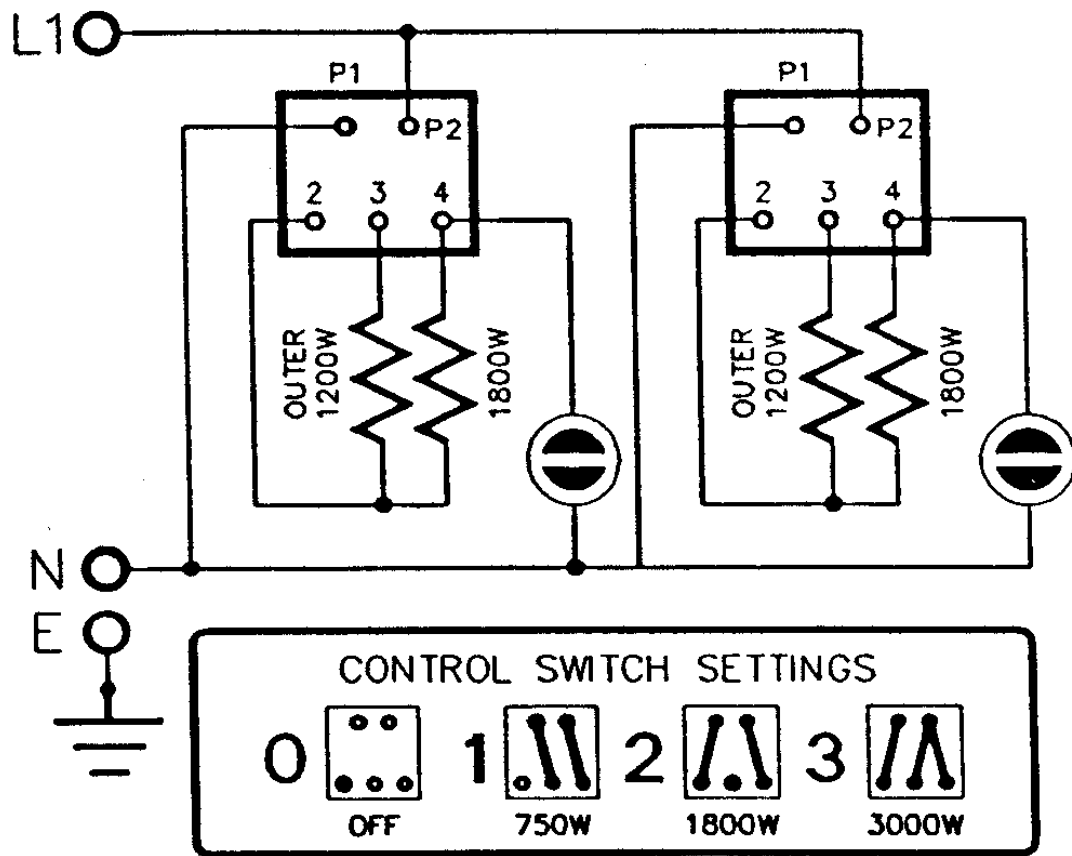

9. PARTS DIAGRAMS

9.1



Pos	Part No	Description
1	004656	Blue Seal badge
2	004345	Front cover panel
3	013528	Indicator light
4	017683	Knob
	017682	3 heat switch
5	017963	Rack
	013395	Rack handle
6	023961	Side rack (From S/N 214584)
	017965	Side rack (To S/N 214583)
7	013315	Bottom tray
8	004047	Control panel
9	013879	Side panel
10	013872	Back panel
11	015487	Top cover
	013418	Branding plate (E91B only) (Not shown)
	004050	Trough Tray (E91B only) (Not shown)
	013362	Drain valve (E91B only) (Not shown)

9.2

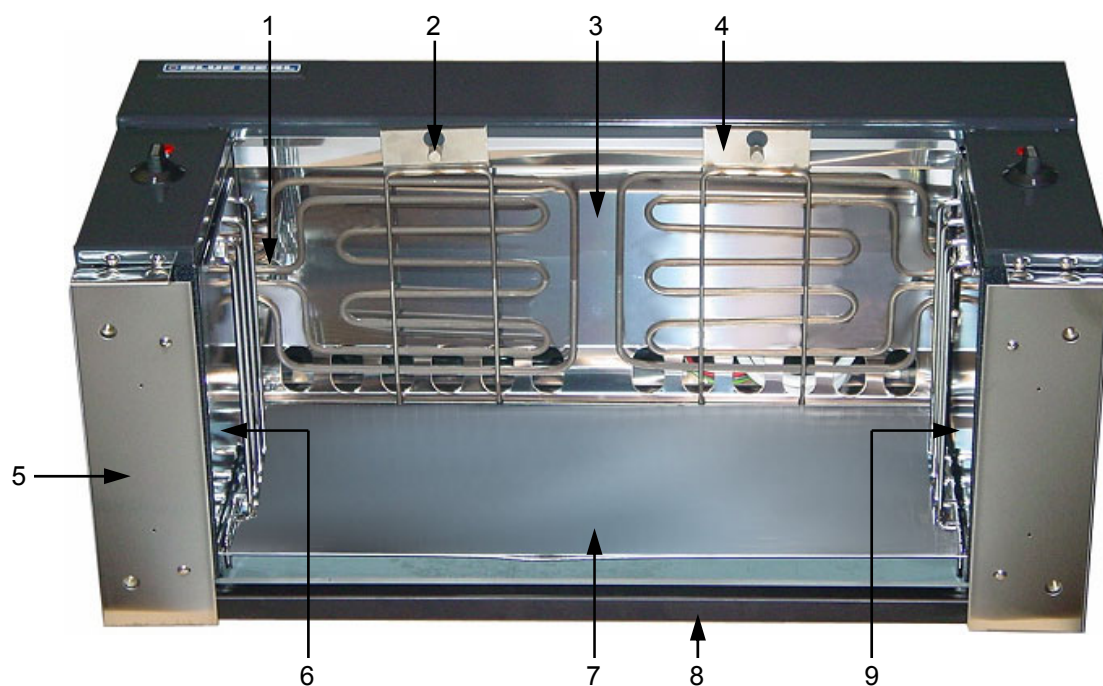

Pos	Part No	Description
1	015758	Element - 3.0kW
2	013920	Securing screw - plated
3	013870	Top reflector
4	013867	Element support
5	013879	Side panel
6	004881	Inner panel LH - enamelled
7	023958	Rear reflector
8	004049	Support frame
9	004882	Inner panel RH - enamelled

10. SERVICE CONTACTS

AUSTRALIA

VICTORIA - MOFFAT PTY

HEAD OFFICE AND MAIN WAREHOUSE
740 Springvale Road
Mulgrave VIC 3170
Spare Parts Department

Tel (03) 9518 3888
Fax (03) 9518 3838
Free Call 1800 337 963
Fax (03) 9518 3895

NEW SOUTH WALES - MOFFAT PTY

Unit 8/142 James Ruse Drive
Rosehill NSW 2142
Spare Parts

Free Call 1800 337 963
Fax (03) 9518 3895

QUEENSLAND - MOFFAT PTY

30 Prosperity Place
Geebung QLD 4034
Spare Parts

Free Call 1800 337 963
Fax (03) 9518 3895

SOUTH AUSTRALIA - MOFFAT PTY

28 Greenhill Rd
Wayville SA 5034
Spare Parts

Tel (08) 8274 2116
Fax (08) 8274 2129
Free Call 1800 337 963

WESTERN AUSTRALIA - MOFFAT PTY

PO Box 689
Joondalup Business Centre WA 6027
Spare Parts

Tel (08) 9305 8855
Free Call 1800 337 963

**NATIONAL COVERAGE FOR 24 HOUR SERVICE OR MAINTENANCE DIAL
FREE CALL 1800 622 216 (AUSTRALIA ONLY)**

CANADA

Lessard Agencies Limited
PO Box 97
Stn "D"
Toronto, ONT M6P 3J5

Tel (416) 766 2764
Fax (416) 760 0394
Free Call 1 888 537 7273

NEW ZEALAND

CHRISTCHURCH - MOFFAT LTD

16 Osborne St
PO Box 10-001
Christchurch
Spare Parts

Free Call 0800 Moffat
(0800 663 328)

Tel (03) 389 1007
Fax (03) 389 1276

AUCKLAND - MOFFAT LTD

4 Waipuna Road
Mt Wellington
Auckland
Spare Parts

Tel (09) 574 3150
Fax (09) 574 3159

Free Call 0800 Moffat
(0800 663 328)

UNITED KINGDOM

BLUESEAL LTD
Units 6-7 Mount St
Business Park
Birmingham B7 5QU
England

Tel 0121-327 5575
Fax 0121-327 9711

UNITED STATES OF AMERICA

MOFFAT INC.
3765 Champion Blvd
Winston-Salem
NC27115

Tel 1-800-551 8795
Fax 336 661 9546

**NATIONAL COVERAGE FOR SERVICE OR MAINTENANCE DIAL
FREE CALL 1800 551 8795 (USA ONLY)**

