

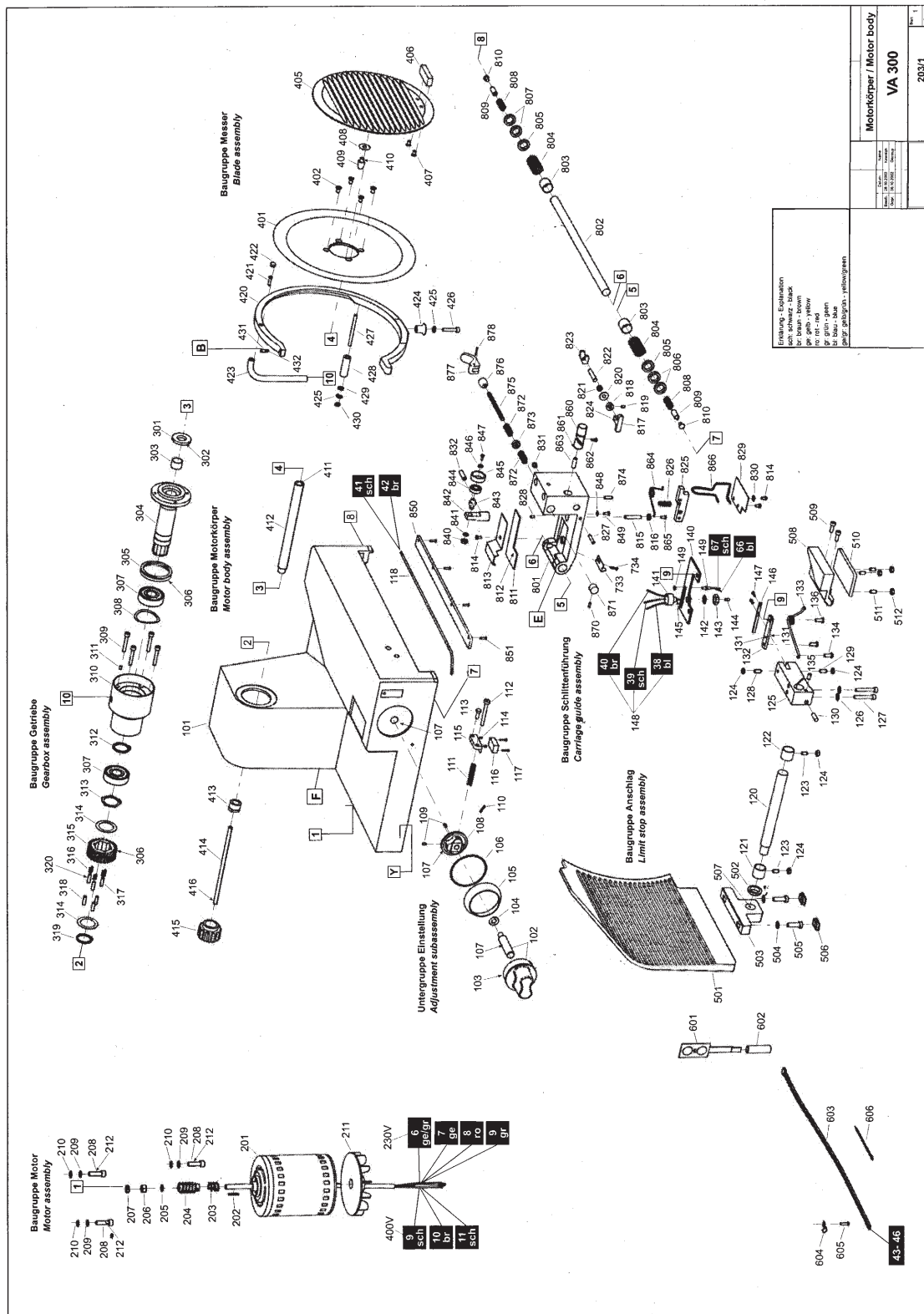

8 Exploded views

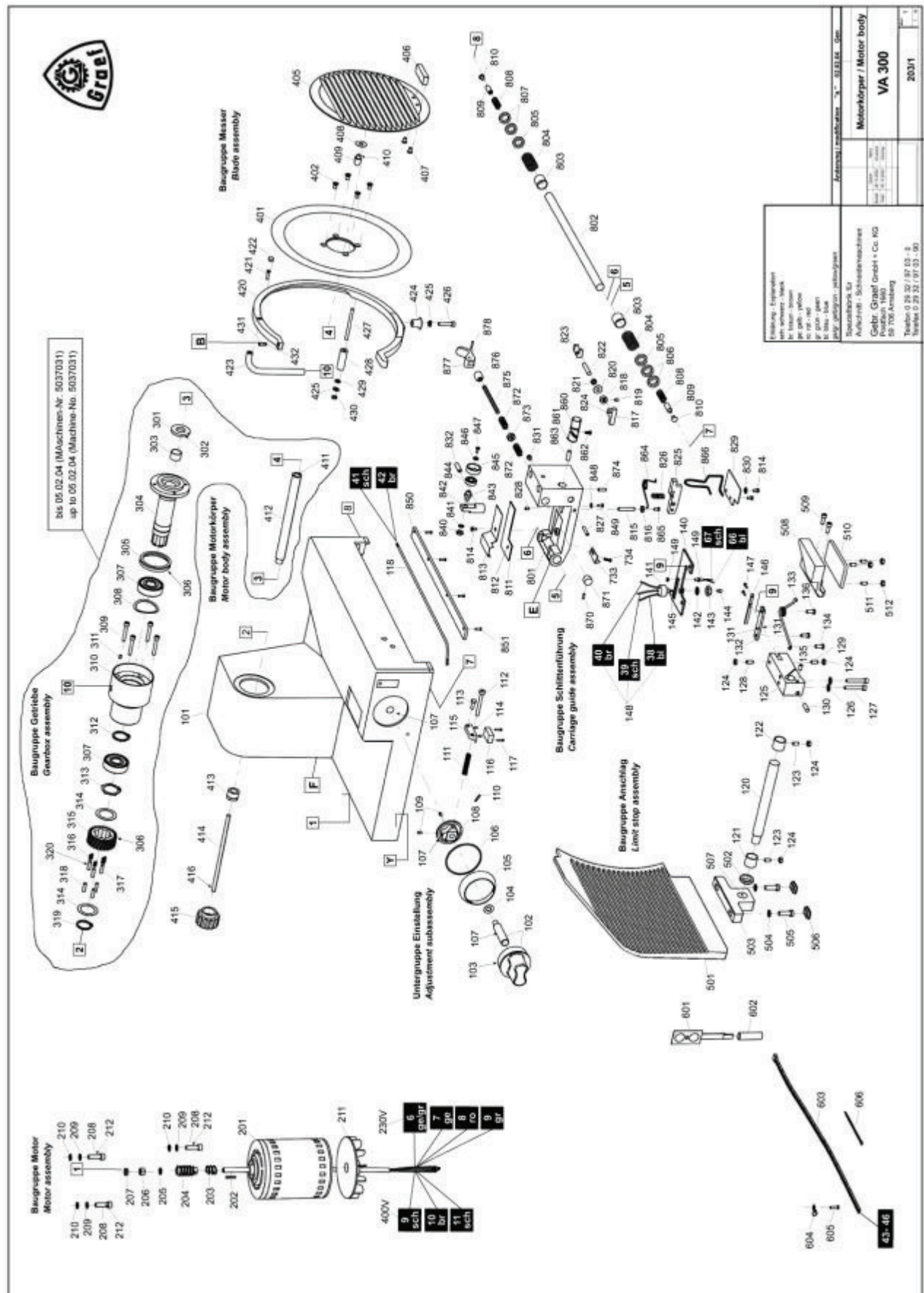



	EXPLODED VIEWS	85
Product: VA 300	Issue 5	issued: 20/07/05

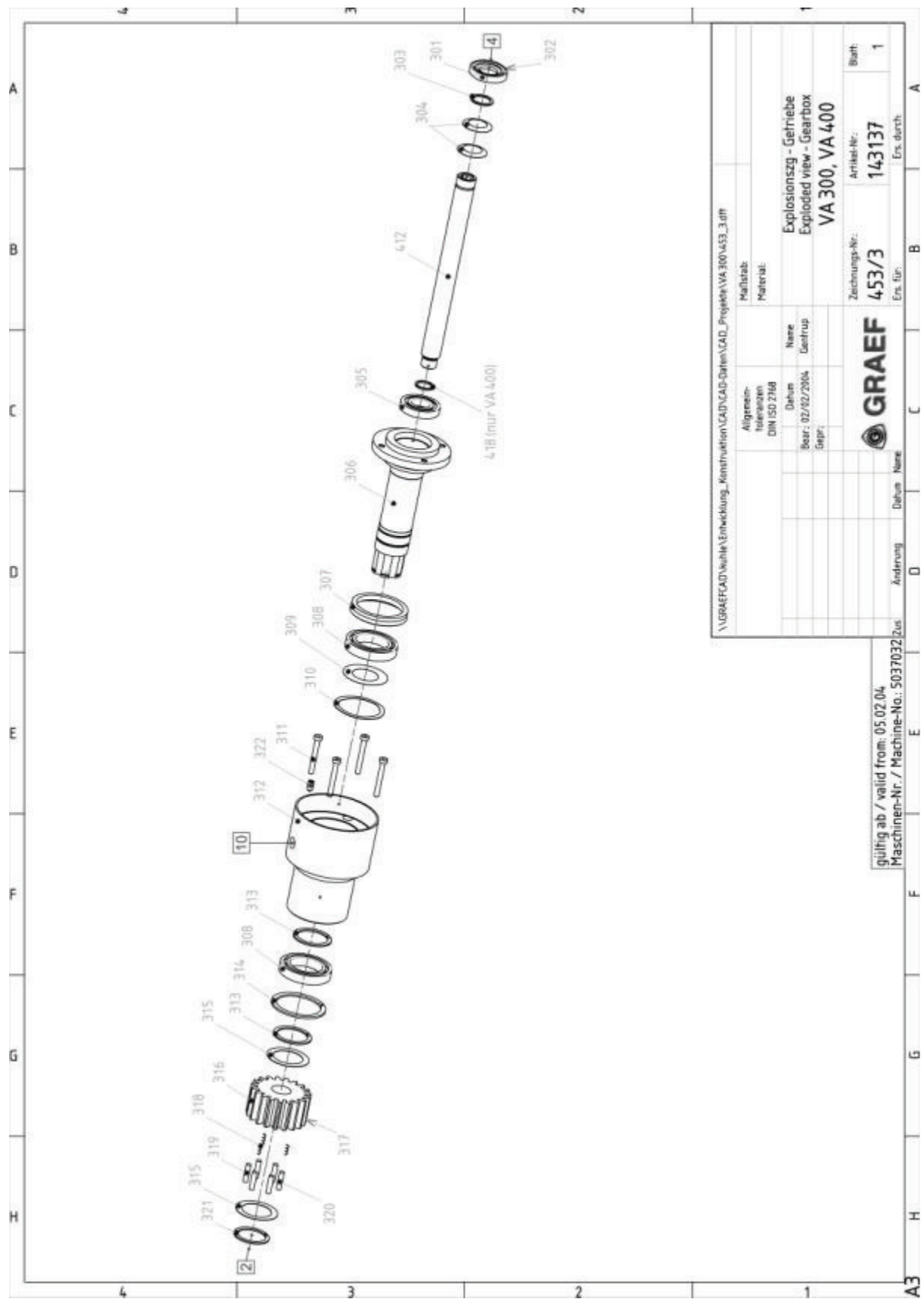



EXPLODED VIEWS

86

Product: VA 300

Issue
5

issued:
20/07/05

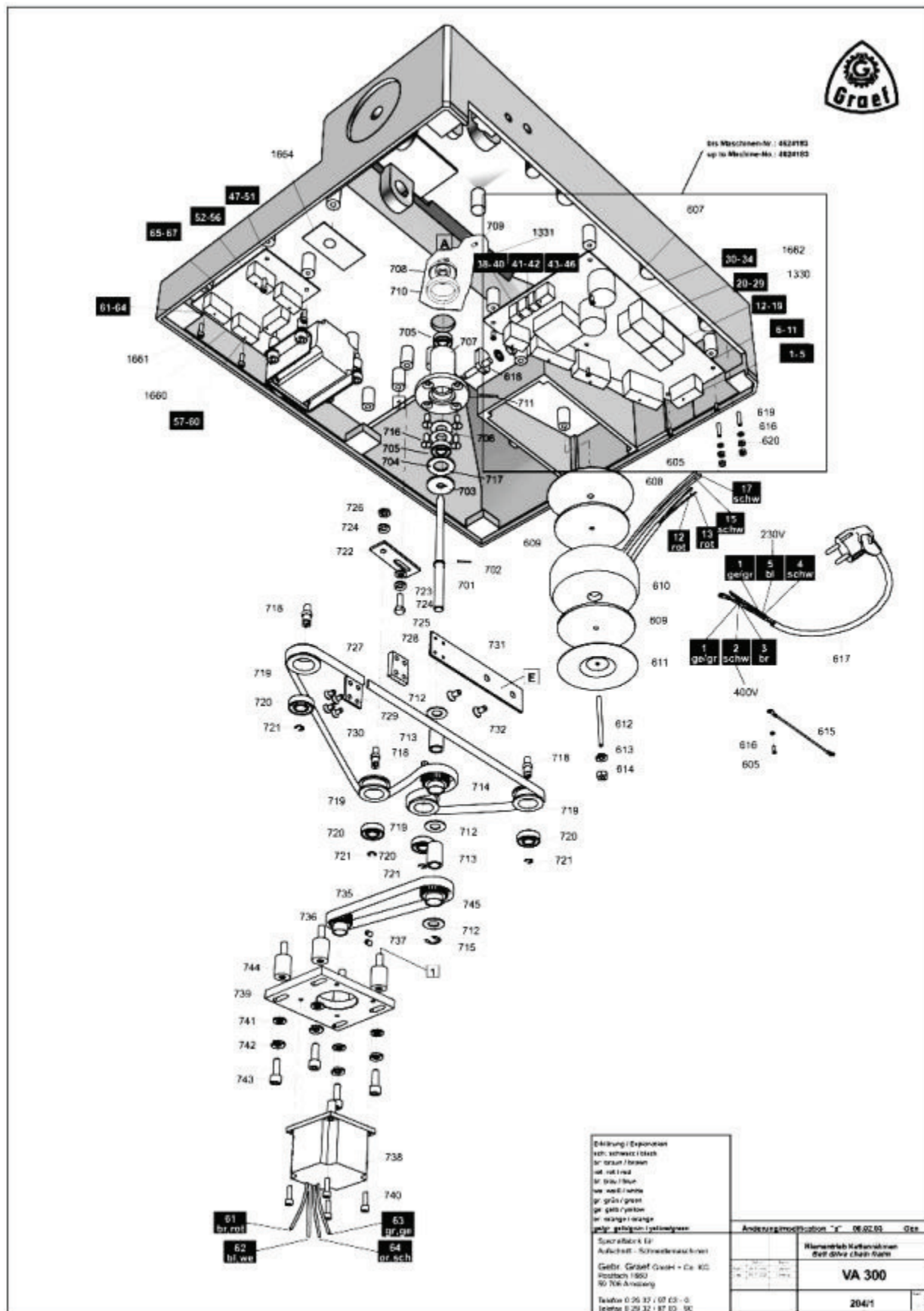



EXPLODED VIEWS

87

Product: VA 300

Issue
5

issued:
20/07/05

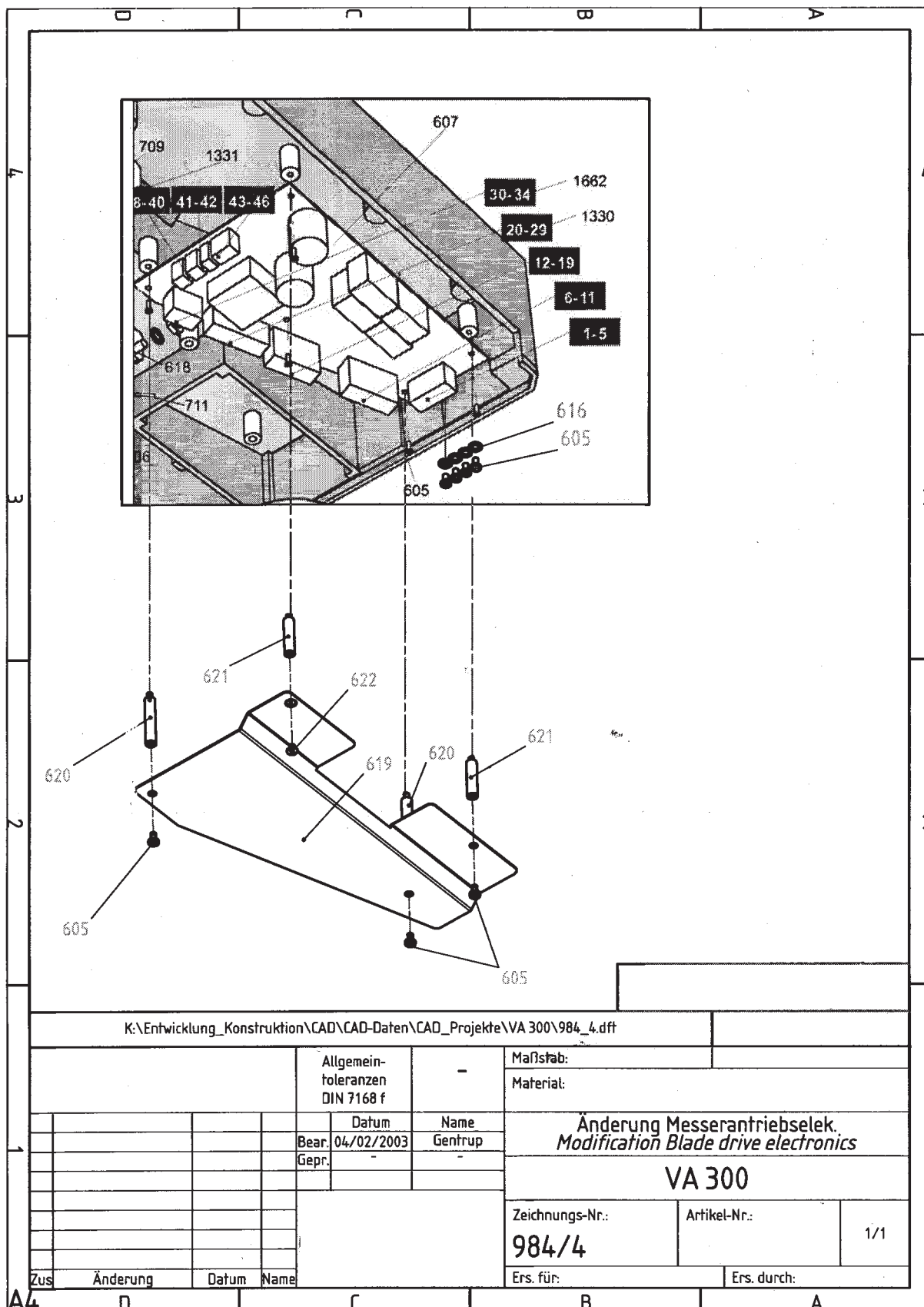

	EXPLODED VIEWS	88
Product: VA 300	Issue 5	issued: 20/07/05

TYPE A: TESCO VERSION SLICERS (ORIGINAL SPEC) upto 4352429

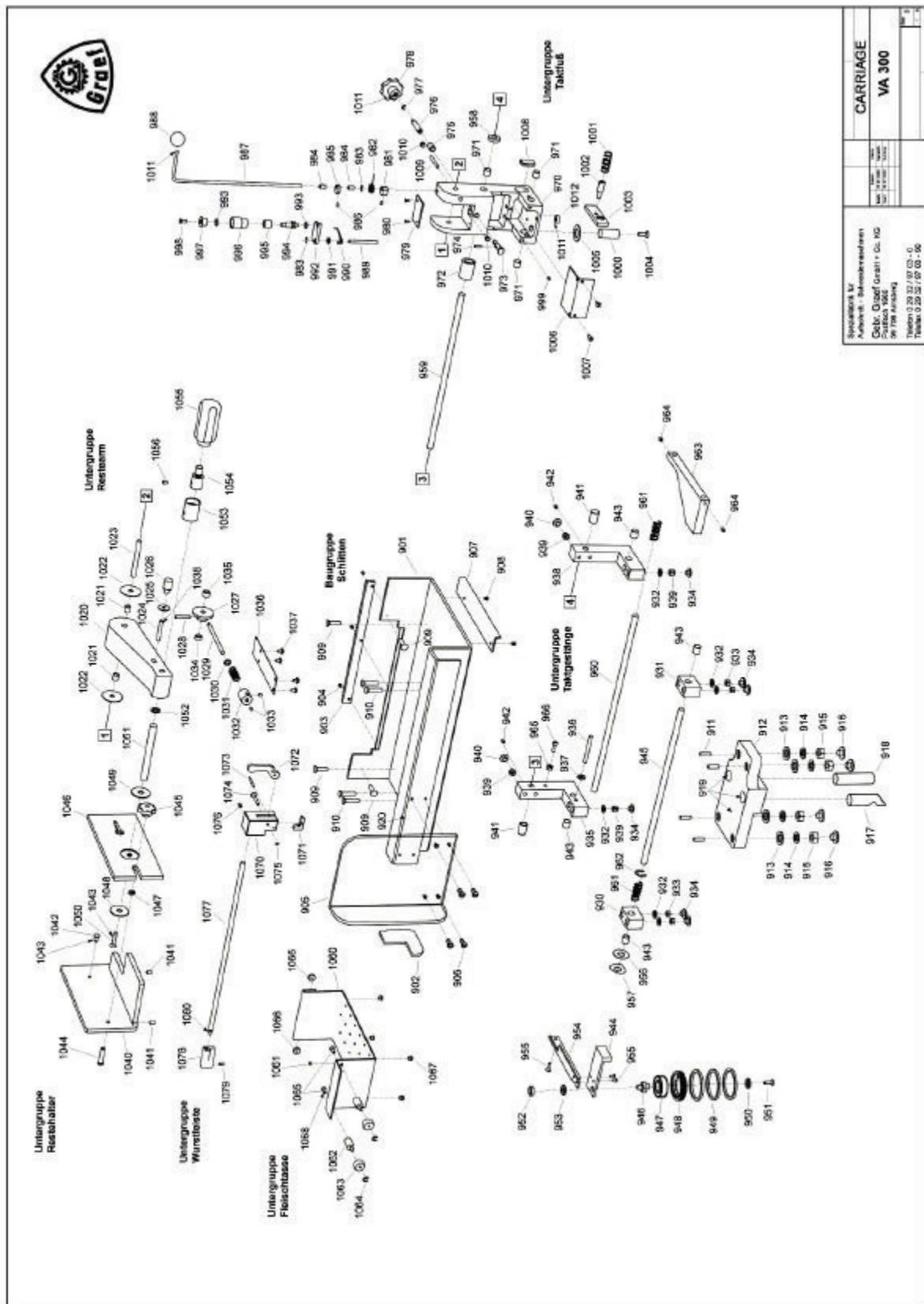

	EXPLODED VIEWS	89
Product: VA 300	Issue 5	issued: 20/07/05

TYPE B: from SERIAL NUMBER: 4352430 upto 4774681

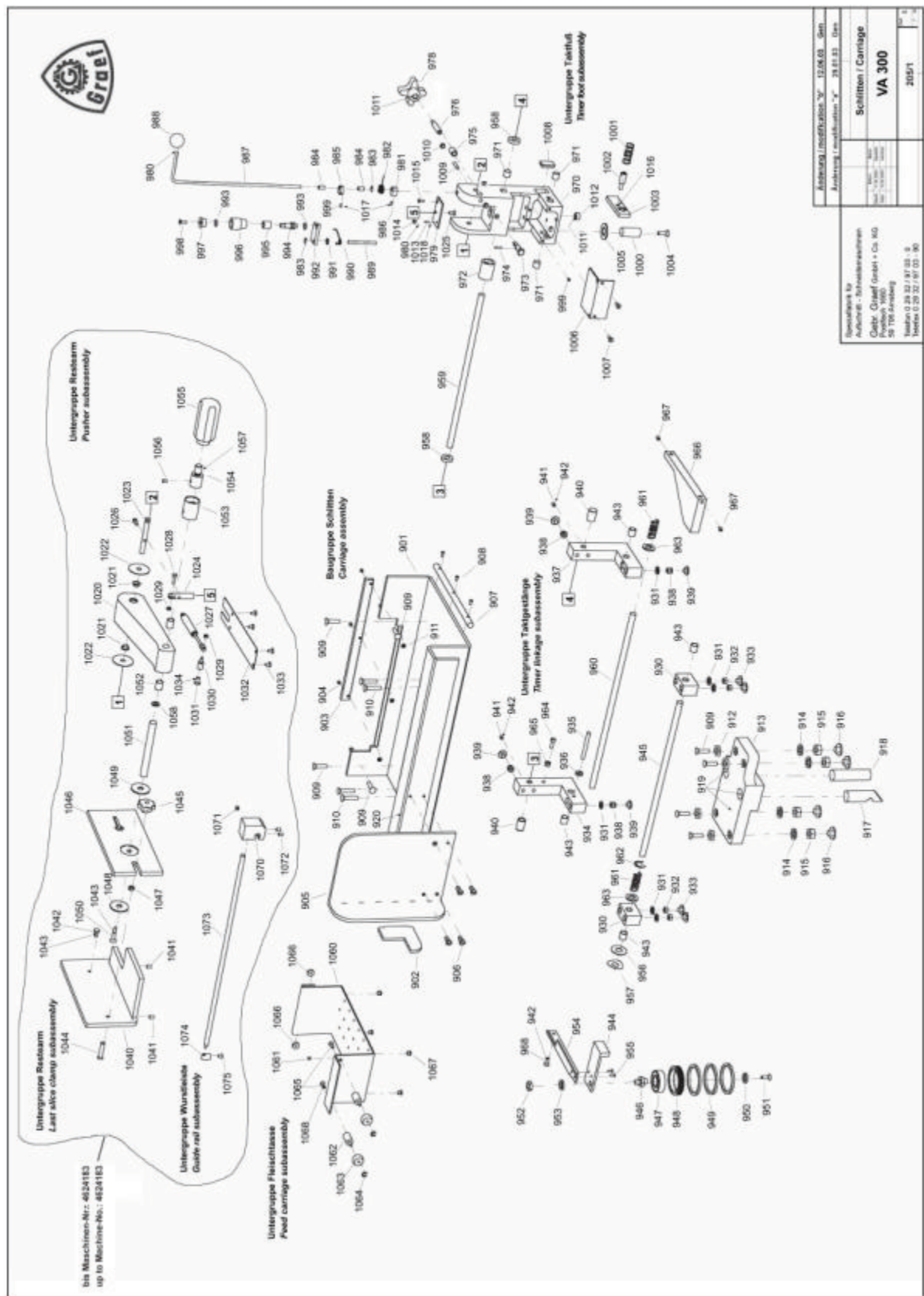

TYPE C: from SERIAL NUMBER: **4774682**

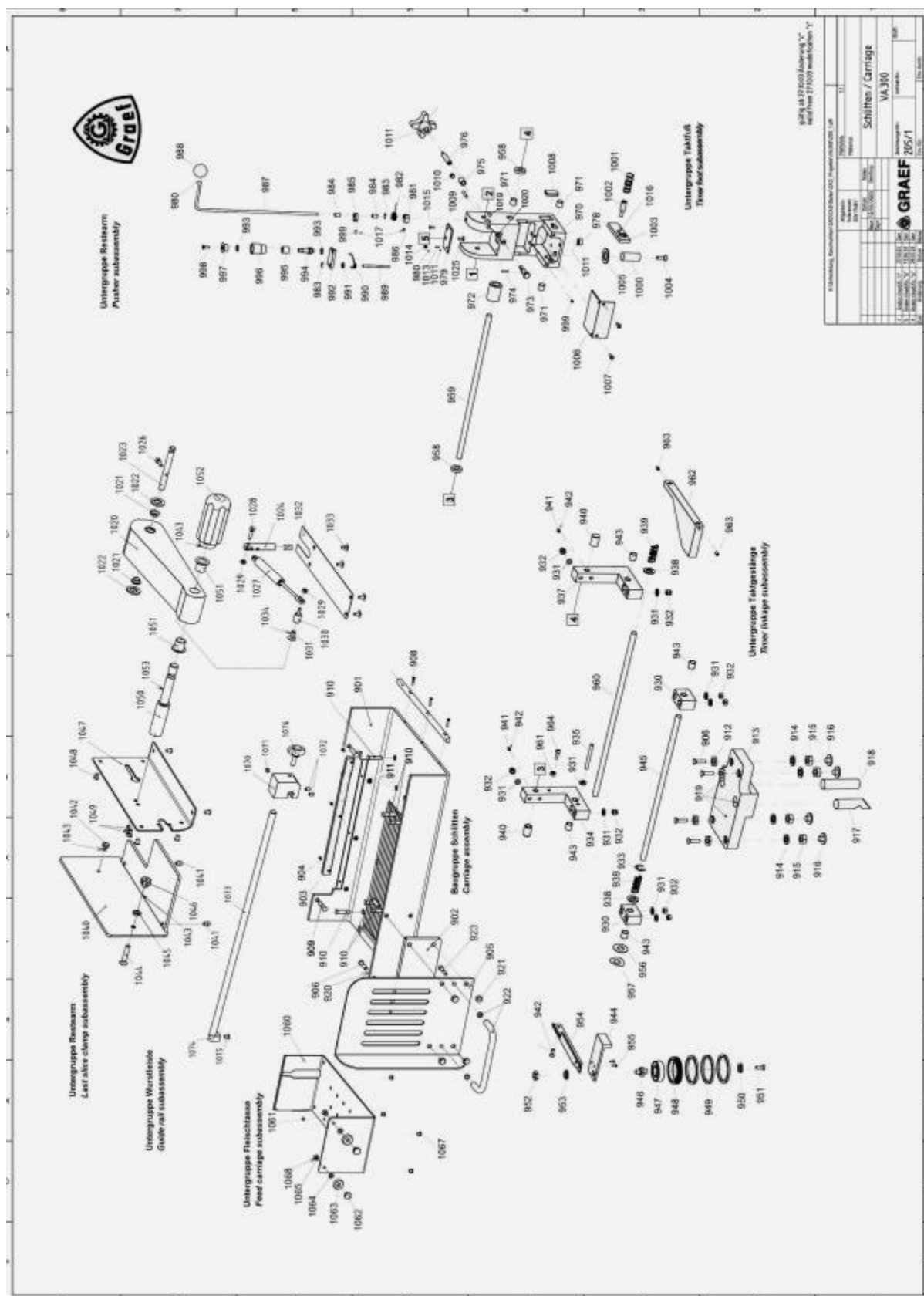

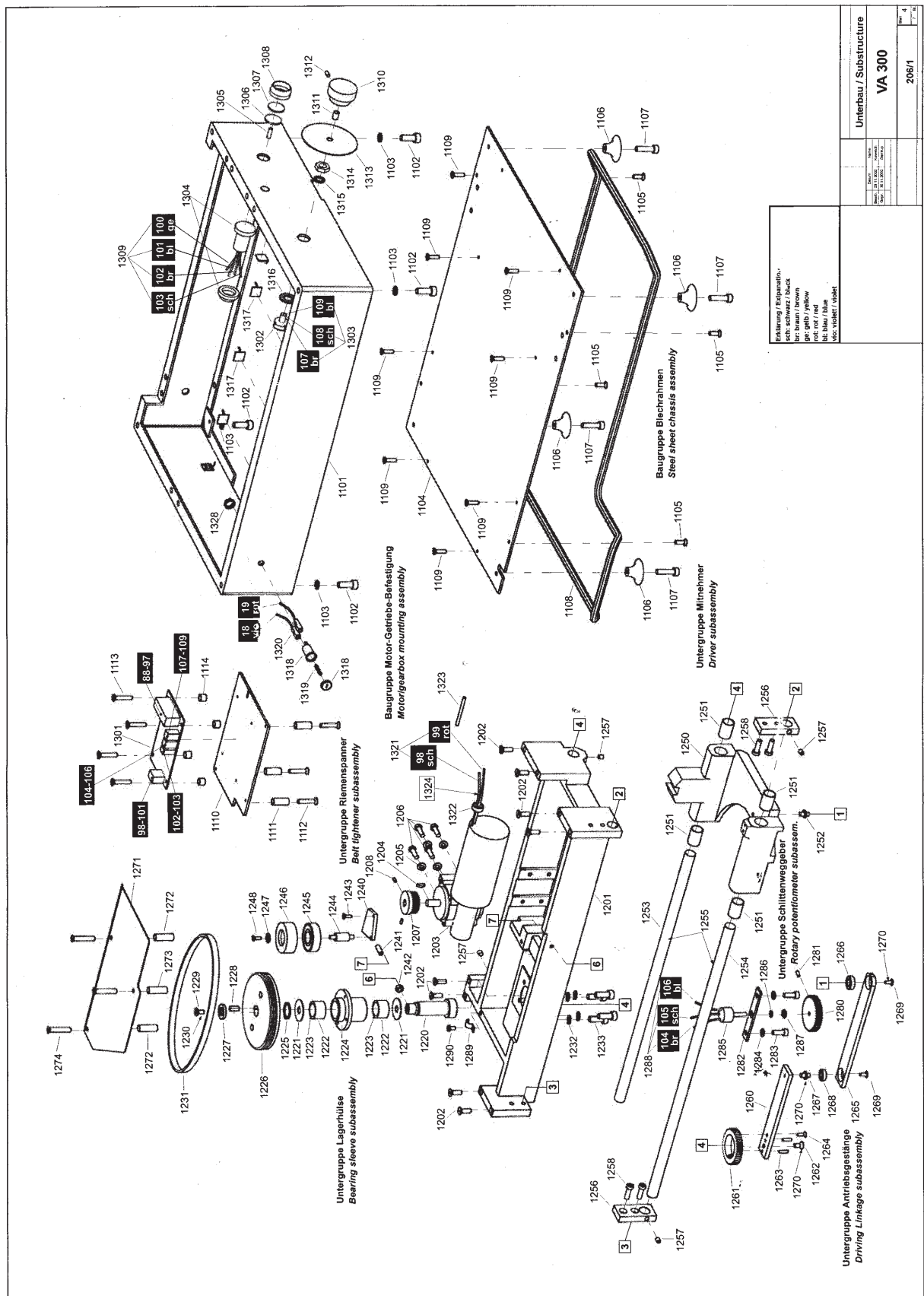

	EXPLODED VIEWS	92
Product: VA 300	Issue 5	issued: 20/07/05

new belt system (fitted from 15.08.2003 serial no. 4742743)
toothed belt

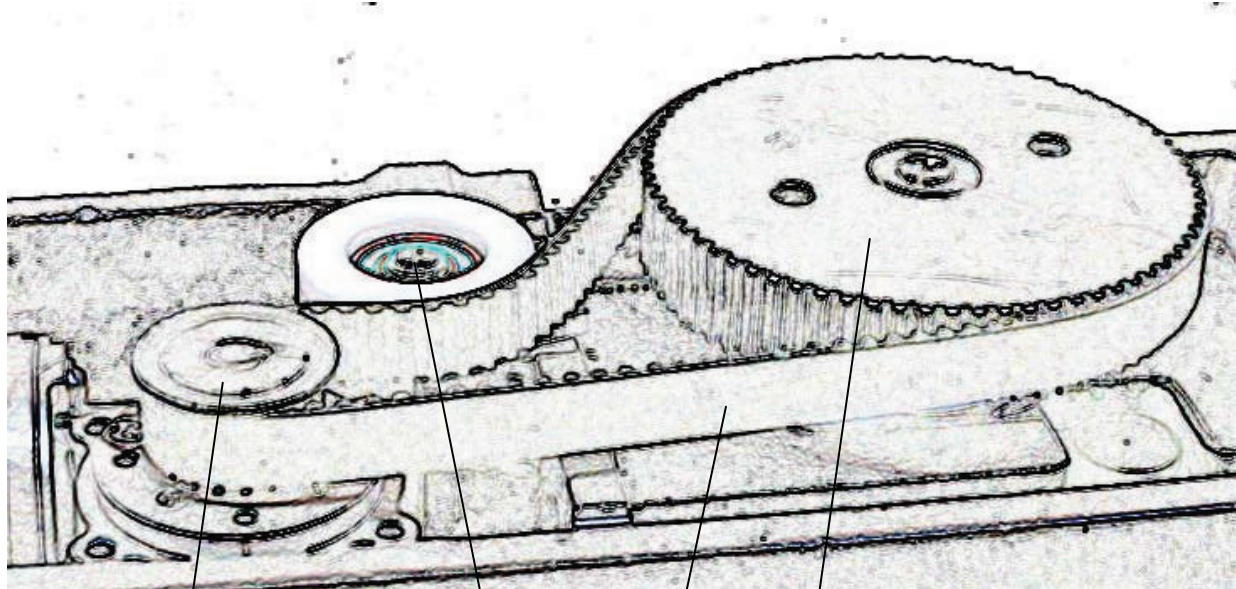

1207
(only 1
flanged
pulley on the
top!)

1244

1231

1226



EXPLODED VIEWS

93

Product: VA 300

Issue
5

issued:
20/07/05

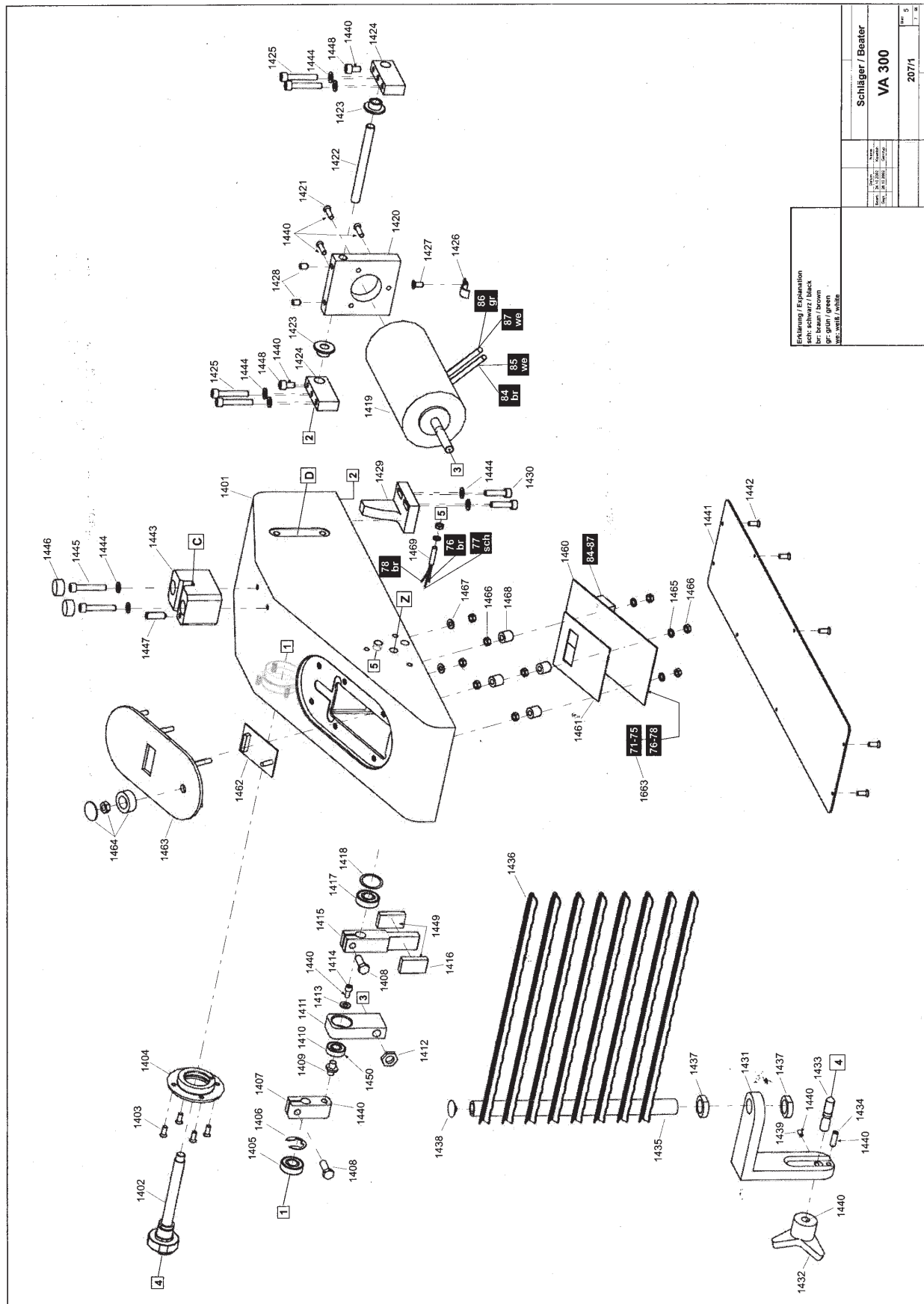

	EXPLODED VIEWS	94
Product: VA 300	Issue 5	issued: 20/07/05

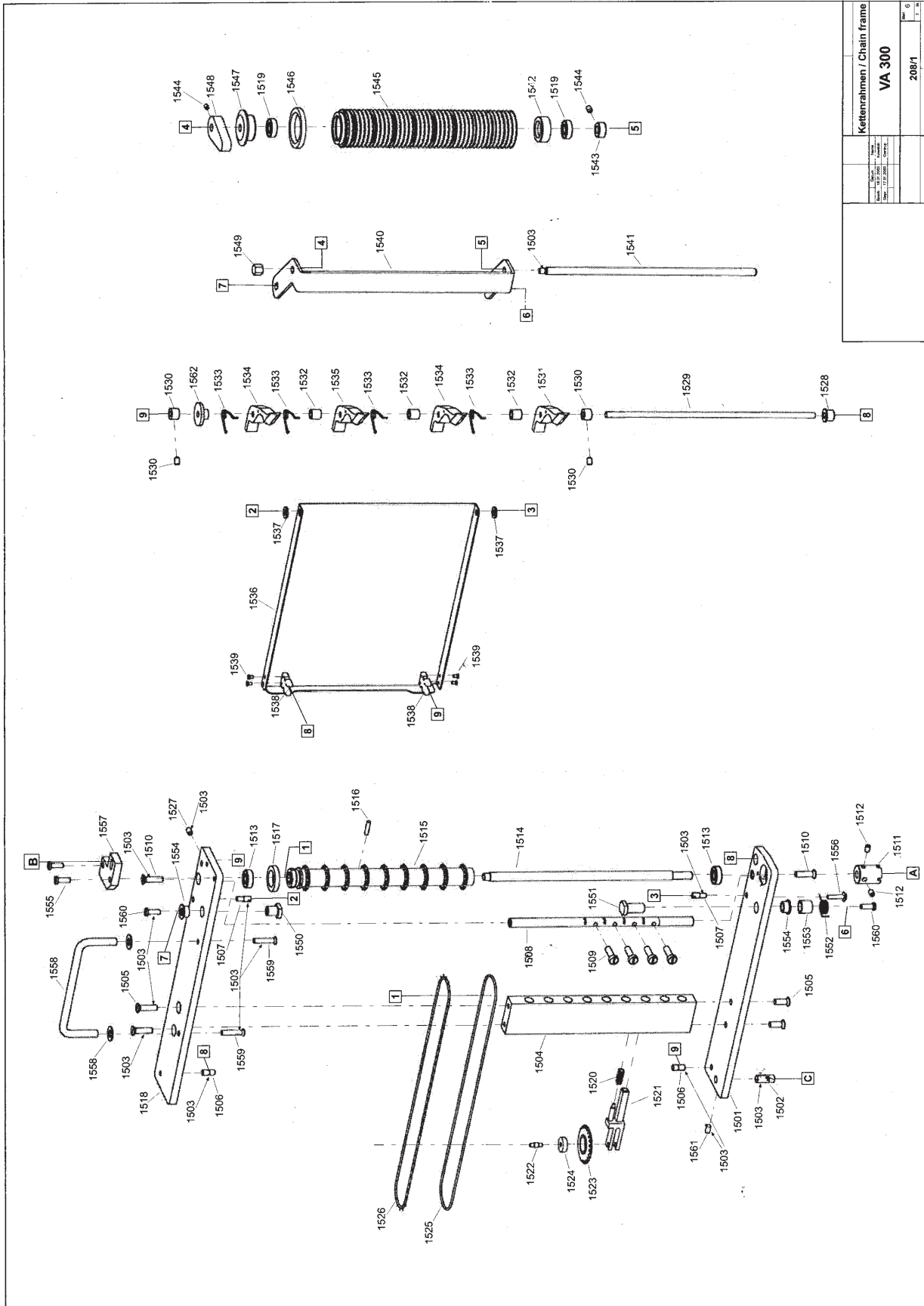

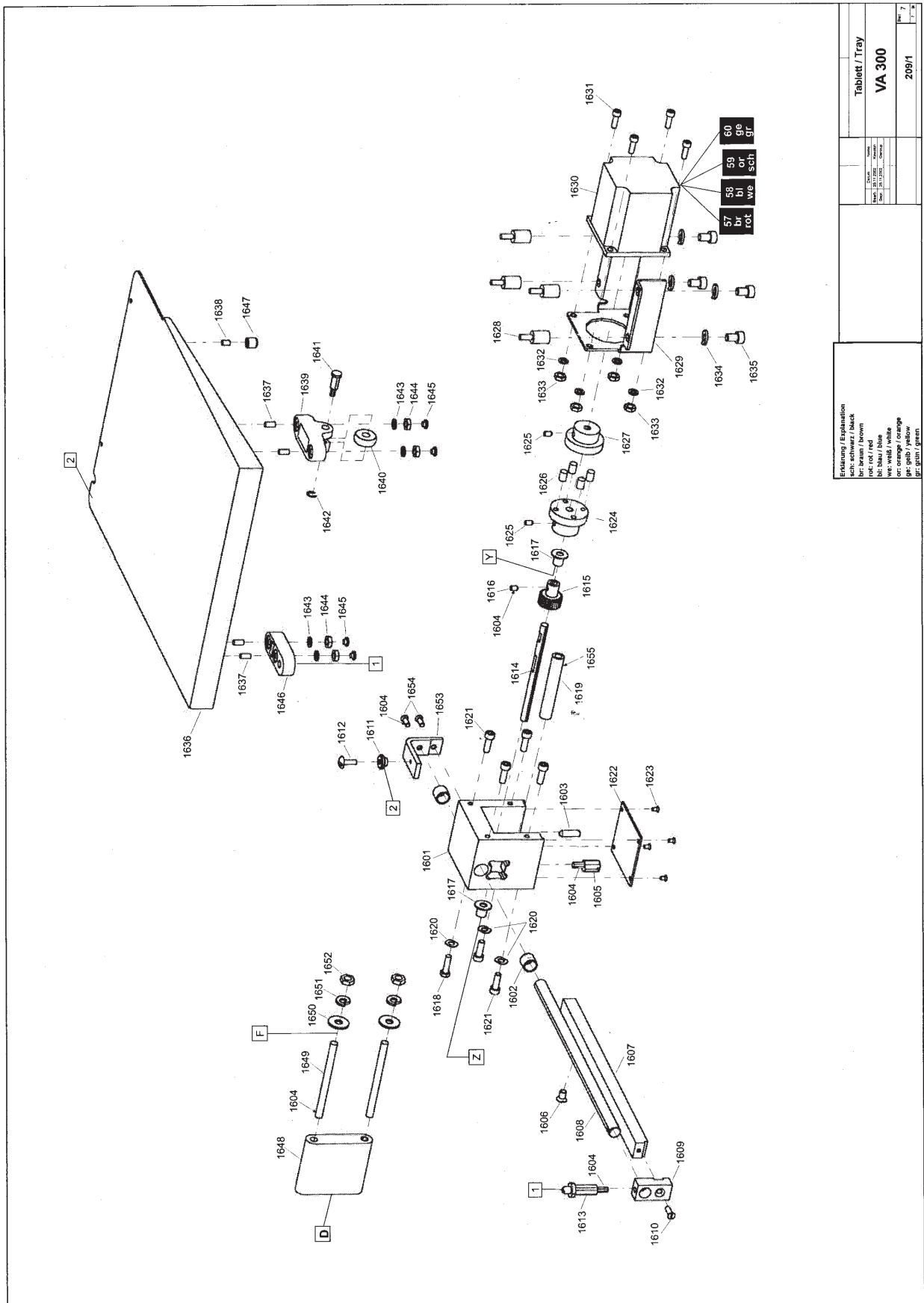

	EXPLODED VIEWS	95
Product: VA 300	Issue 5	issued: 20/07/05

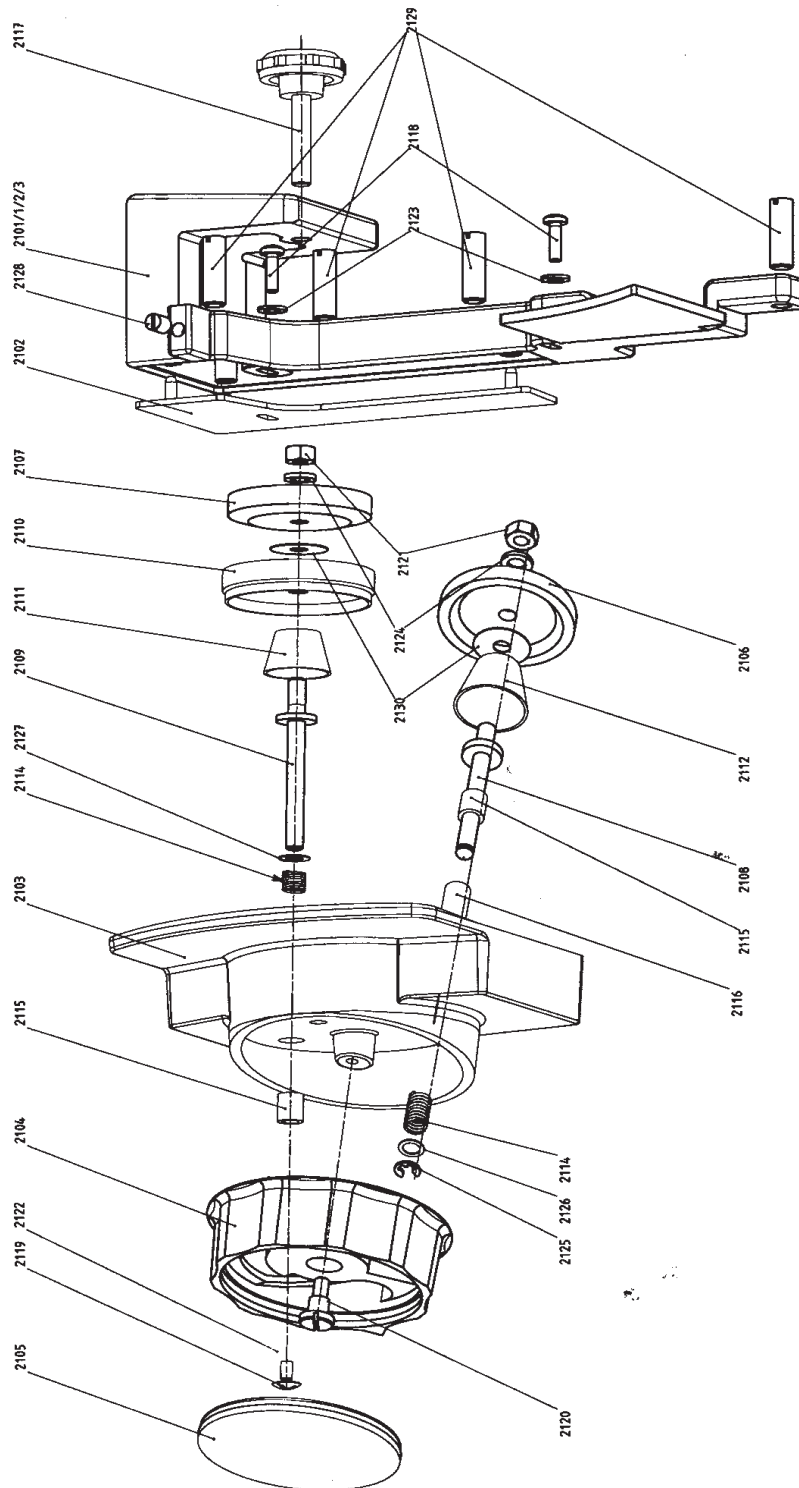

	EXPLODED VIEWS	97
Product: VA 300	Issue 5	issued: 20/07/05

Sharpener version with screw 2124 retaining the sharpening stone assembly
New version 2 sharpener – zero, de-burr and sharpening positions



	EXPLODED VIEWS	98
Product: VA 300	Issue 5	issued: 20/07/05

Graef manufactured corned beef attachment.

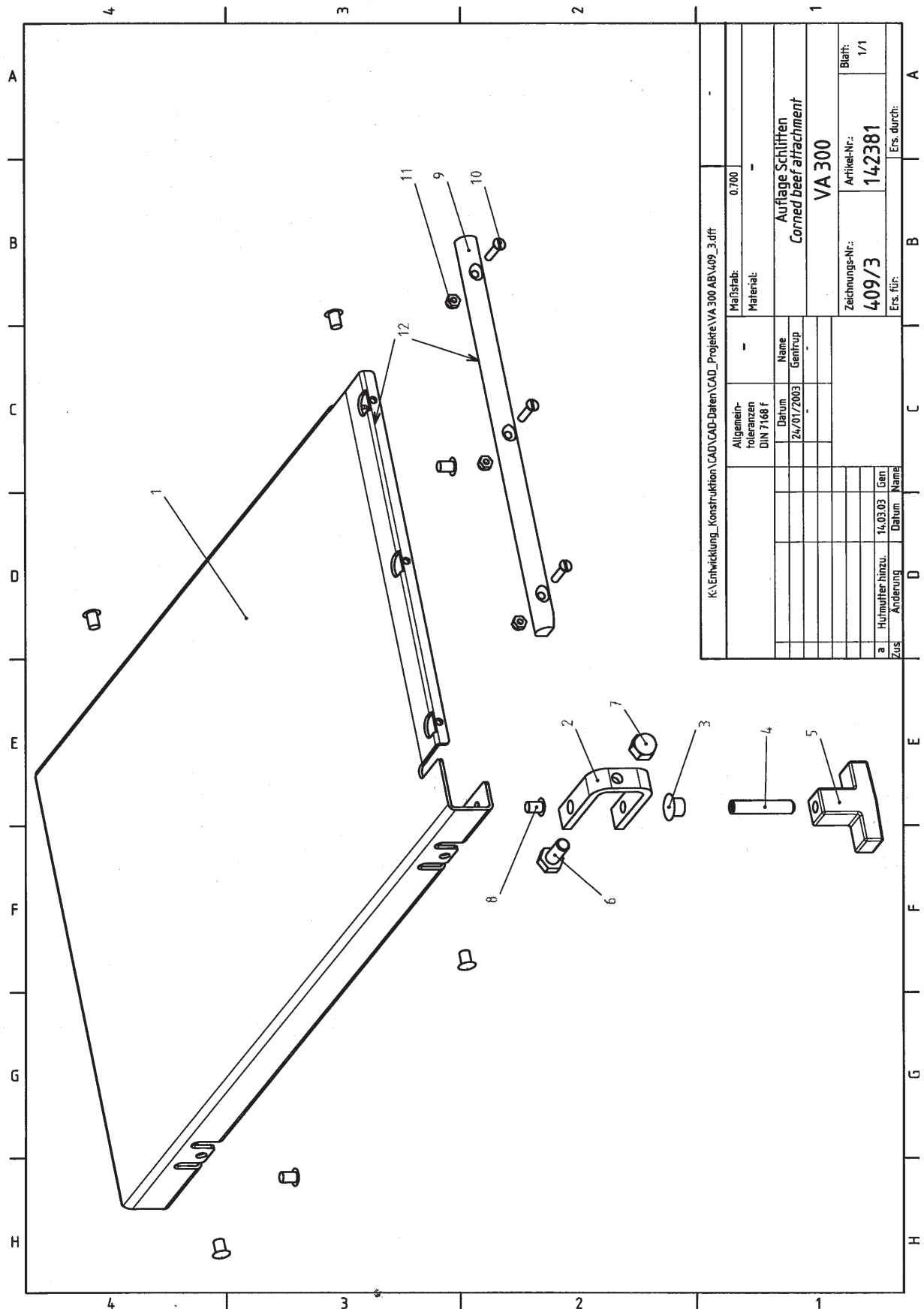

	EXPLODED VIEWS	99
Product: VA 300	Issue 5	issued: 20/07/05

Avery Berkel manufactured corned beef attachment

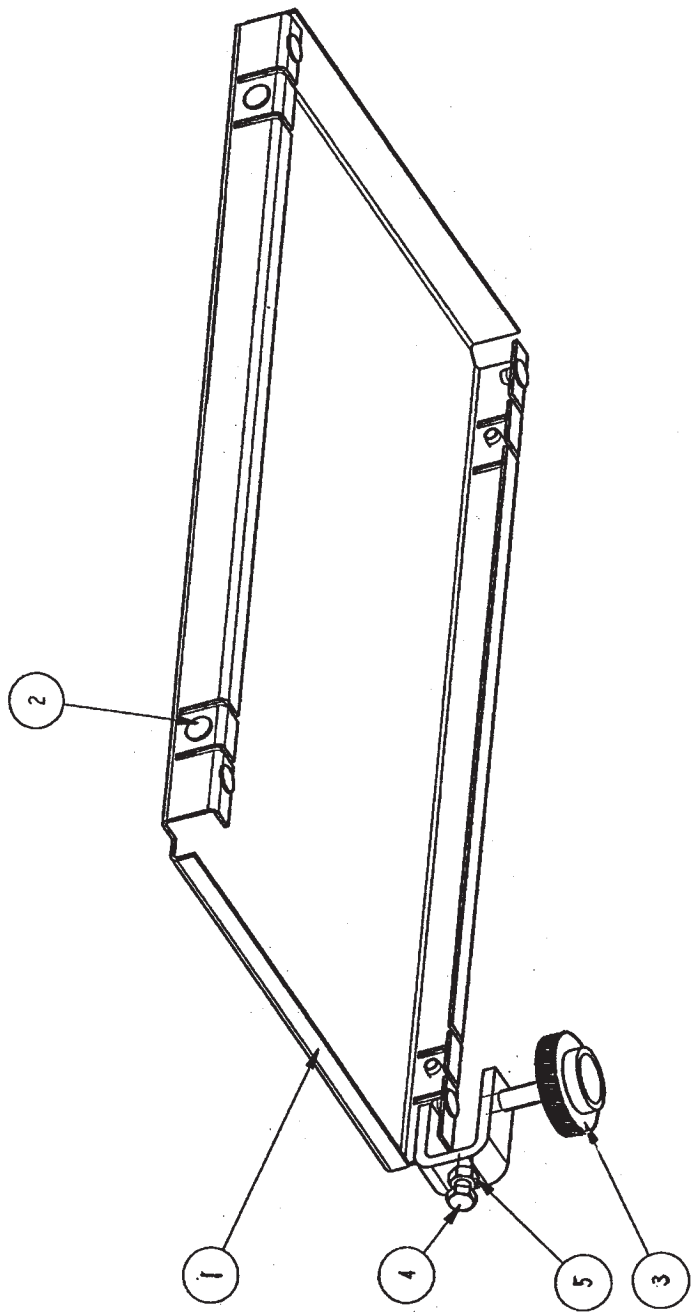

	EXPLODED VIEWS	100
Product: VA 300	Issue 5	issued: 20/07/05

Splash guard

